

STA. 64+00 OF F.A.R. 519-A RE
 = STA. 64+00 OF F.A.R. 519-G
 = STA. 64+00 OF F.A.R. 519-A

Note: Marker to be furnished and erected on the left by the State before acceptance of this project.

N.B. See Sheets No 14 & 15 for intersection details

SUMMARY OF NEW 6"x18" SANDSTONE CURB

From Station	To Station	L. or R.	Gross Length Lin. Ft.	Additions For Lin. Ft.	Deductions For Lin. Ft.	Net Length Lin. Ft.
60+0	64+0	L	4.00			3.66
60+0	61+85	R	1.85		Intersect. .34	1.51
64+0	92+0	L	2800			2710
Total 519-G						4.17
Total 519-A RE						2710

SUMMARY OF CURVED 6"x18" SANDSTONE CURB

Station	L. or R.	For	Lin. Ft.
61+63	R	Intersection	10
Total 519-G			

CURB INCIDENTALS ADJACENT TO BASINS RAISED TO GRADE

Station	R. or L.	Dowel Holes Lin. Ft.	Reinf. Steel Lbs.	Curb Removal Lin. Ft.	Conc. Curb L.A.
62+39	R	4	6.5	12	12
Total 519-G					
64+0	R	4	6.5	12	12
64+0	R	4	6.5	12	12
64+0	R	4	6.5	12	12
64+0	R	4	6.5	12	12
64+0	R	4	6.5	12	12
64+0	R	4	6.5	12	12
64+0	R	4	6.5	12	12
64+0	R	4	6.5	12	12
64+0	R	4	6.5	12	12
Total 519-A RE					
		24	39	72	72

FED. RD. DIST. No. 10 STATE OHIO F.A.R. No. 519-A RE 277 RE FISCAL YEAR 1937

LAKE COUNTY SEC. Wickliffe, Willowick, I.B. & Willoughby (Pt)

S.H. 2

8
21

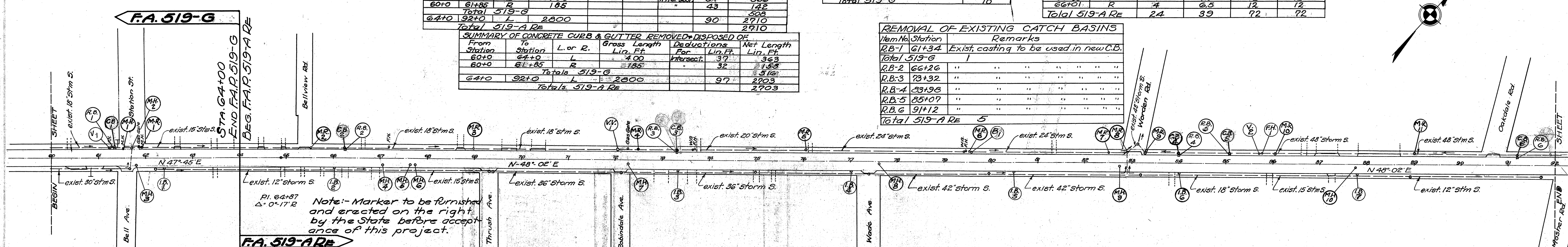

Note: Marker to be furnished and erected on the right by the State before acceptance of this project.

REMOVAL OF EXISTING CATCH BASINS

Item No.	Station	Remarks
R.B.-1	61+34	Exist. casting to be used in new C.B.
Total 519-G		
R.B.-2	66+26	" " " " " " " "
R.B.-3	73+32	" " " " " " " "
R.B.-4	83+93	" " " " " " " "
R.B.-5	85+07	" " " " " " " "
R.B.-6	91+12	" " " " " " " "
Total 519-A RE		
5		

MANHOLES REBUILT (M.R.)

ITEM No.	STATION	DIST. R. or L.
1 M.R.	61+88.6	20.6 L
TOTAL 519-G		
1		
2 M.R.	65+51	20.0 L
3 M.R.	68+98	20.0 L
4 M.R.	72+51	20.0 L
5 M.R.	76+01	20.0 L
6 M.R.	79+52	20.5 L
7 M.R.	82+52	20.0 L
8 M.R.	82+89	19.0 L
9 M.R.	83+27	19.0 L
10 M.R.	86+03	20.0 L
11 M.R.	89+03	20.0 L
TOTAL 519-A RE		
10		

SUMMARY OF MAN-HOLE CASTINGS RAISED TO GRADE (M.H.)

Item No.	Station	DIST. R. or L.
M.H. 1	61+54	20.1 L
M.H. 2	61+72	20.1 L
M.H. 3	61+80	19.8 E
Total 519-G		
3		
M.H. 4	67+06	12.2 E
M.H. 5	67+67	12.2 E
M.H. 6	67+73	12.2 E
M.H. 7	74+38	7.6 E
M.H. 8	74+59	7.9 E
M.H. 9	82+76	7.2 E
M.H. 10	87+76	7.2 E
Total 519-A RE		
7		

SUMMARY OF INLET BASIN CASTINGS RAISED TO GRADE (I.B.)

Item No.	Station	DIST. R. or L.
I.B. 1	62+39	20.2 E
Total 519-G		
1		
I.B. 3	75+36	20.2 E
I.B. 4	77+0	20.2 E
I.B. 5	80+50	20.2 E
I.B. 6	84+00	20.2 E
I.B. 7	87+93	20.2 E
I.B. 2	66+02	20.2 E
Total 519-A RE		
6		

SUMMARY OF BRICK VALVE VAULTS REBUILT (V.V.)

Item No.	Station	DIST. R. or L.
V.V. 1	72+05	19.5 L
Total 519-A RE		
1		

SUMMARY OF VALVE BOX CASTINGS RAISED TO GRADE (V.)

Item No.	Station	DIST. R. or L.
V. 1	61+26	20.1 L
Total 519-G		
1		
V. 2	85+74	20.5 L
Total 519-A RE		
1		

SUMMARY OF NEW CATCH-BASINS (C.B.)

Item No.	Station	DIST. R. or L.	Remarks
C.B. 1	61+34	20.1 L	Alter exist. connection to fit New C.B.
Total 519-G			
1			
C.B. 3	73+32	18.1 L	" " " " " " " "
C.B. 4	83+93	18.1 L	" " " " " " " "
C.B. 5	85+07	20.1 L	" " " " " " " "
C.B. 6	91+12	20.1 L	" " " " " " " "
C.B. 2	66+26	18.1 L	" " " " " " " "
Total 519-A RE			
5			

SUMMARY OF NEW CATCH-BASINS (B.)

Item No.	Station	DIST. R. or L.	Remarks
B. 1	79+56	20.1 L	Connection to M.H. 9 included in basin lot.
Total 519-A RE			
1			

SUMMARY OF FIRE HYDRANTS MOVED AND RESET (F.H.)

Item No.	Station	DIST. R. or L.	Remarks
F.H. 1	85+76	2.1 L	Move Hydr. back about 1' 1/2 Bend now out of Valve
Total 519-A RE			
1			

B.M. No. 13 STA 63+65
 X S.E. Corner Stone Shop 37' L of E
 Elevation 686.485

B.M. No. 14 STA 69+96
 X N.E. Corner Church Shop 32' R
 Elevation 686.764

B.M. No. 15 STA 75+15
 Spike 18" Buckeye 33' R of E
 Elevation 684.879

B.M. No. 16 STA 79+96
 Spike 14" Buckeye 34' R of E
 Elevation 684.027

B.M. No. 17 STA 84+78
 Spike 14" Buckeye 34' R of E
 Elevation 682.205

B.M. No. 18 STA 89+13
 Spike 14" Cherry 35' R of E
 Elevation 684.534

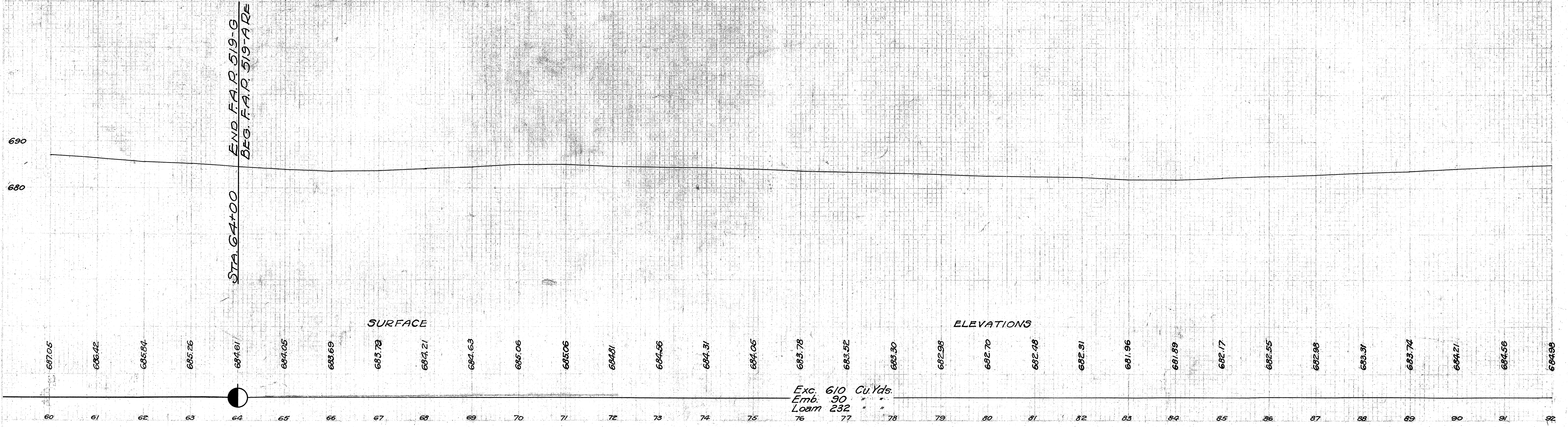

Exc. 610 Cu. Yds.
 Emb. 90 " "
 Loam 232 " "