

SUMMARY OF NEW 6"x18" Sandstone Curb

From Station	To Station	L. or R.	Gross Length Lin. Ft.	Additions		Deduction		Net Length Lin. Ft.
				For	Lin. Ft.	For	Lin. Ft.	
28+0	30+64	L	264					264
28+0	30+64	R	264			Exist. Curb	33	231
38+62	60+0	L	2138			Intersect.	78	2060
38+62	60+0	R	2138			Intersect.	228	1910
Totals			519-G					4465

N.B. See Sheets No. 14 & 15 for Intersection Details

SUMMARY OF CONCRETE CURB & GUTTER REMOVED AND DISPOSED OF

From Station	To Station	L. or R.	Gross Length Lin. Ft.	Deductions		Net Length Lin. Ft.
				For	Lin. Ft.	
28+0	30+64	L	264			264
28+0	30+64	R	264			264
38+62	60+0	L	2138	Intersection	33	2105
38+62	60+0	R	2138	Intersection	240	1898
Totals			519-G			4503

N.B. See Sheets No. 14 & 15 for Intersection Details

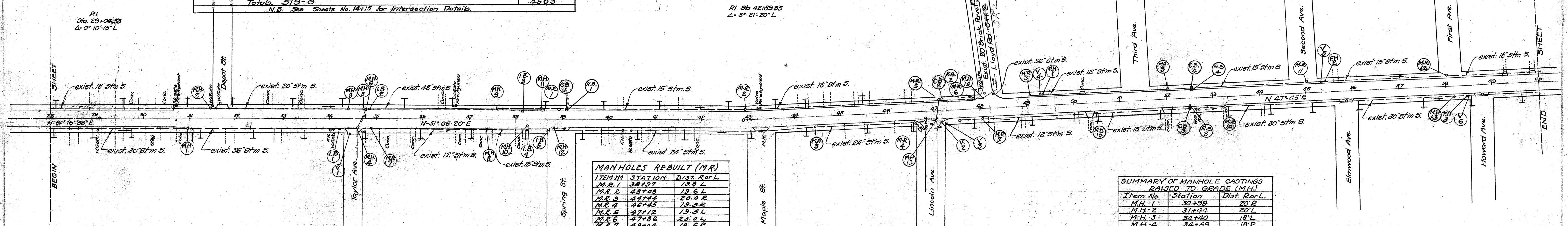
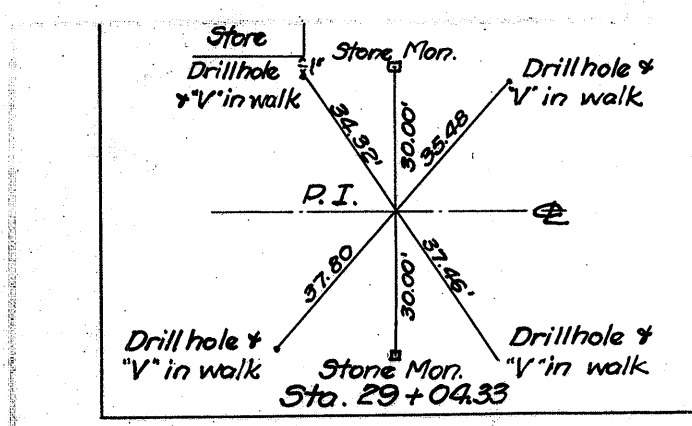
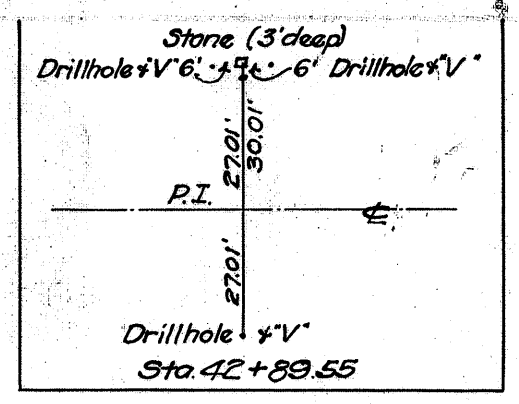

MANHOLES REBUILT (M.R.)

Item No.	Station	Dist. Ror L.
M.R. 1	38+97	19.8 L
M.R. 2	43+03	19.6 L
M.R. 3	44+44	20.0 R
M.R. 4	46+45	19.5 R
M.R. 5	47+12	19.5 L
M.R. 6	47+56	20.0 L
M.R. 7	48+24	18.6 R
M.R. 8	49+02	19.3 L
M.R. 9	52+02	19.3 L
M.R. 10	53+25	19.0 R
M.R. 11	55+01	20.0 L
M.R. 12	58+03	21.0 L
M.R. 13	58+25	19.5 R
Total 519-G - 13		

SUMMARY OF MANHOLE CASTINGS RAISED TO GRADE (M.H.)

Item No.	Station	Dist. Ror L.
M.H. 1	30+99	20 R
M.H. 2	31+44	20 L
M.H. 3	34+40	18 L
M.H. 4	34+59	18 R
M.H. 5	34+73	18 L
M.H. 6	34+77	17 L
M.H. 7	34+89	20 R
M.H. 8	37+30	20 R
M.H. 9	37+59	20 L
M.H. 10	38+25	16 R
M.H. 11	38+54	20 L
M.H. 12	38+82	19 R
M.H. 13	47+01	20 R
M.H. 14	48+08	20 L
M.H. 15	50+48	21 R
M.H. 16	53+84	23 R
Total 519-G 16		

SUMMARY OF FIRE HYDRANTS MOVED AND RESET (F.H.)

Item No.	Station	Dist. Ror L.	Remarks
F.H. 1	48+34	21 L	Move Hydrant back 2 Ft.
F.H. 2	55+42	21 L	
F.H. 3	58+46	20 R	
Total 519-G 3			

SUMMARY OF GRANITE CURB REMOVED AND RESET

Station	L. or R.	For	Lin. Ft.
46+02.90	R	Intersection	48
Total 519-G 48			

SUMMARY OF CURVED SANDSTONE CURB

Station	L. or R.	For	Lin. Ft.
48+20.50	R	Intersection	50
Total 519-G 50			

SUMMARY OF VALVE BOX CASTINGS RAISED TO GRADE (V)

Item No.	Station	Dist. Ror L.
V-1	34+43	31 R
V-2	47+15	21 R
V-3	47+23	23 R
V-4	49+32	21 L
V-5	52+39	20 L
V-6	58+48	20 R
Total 519-G 6		

SUMMARY OF NEW CATCH-BASINS (C.B.)

Item No.	Station	Dist. Ror L.	Remarks
C.B. 1	39+12	20 L	After exist. connection to fit New C.B.
C.B. 2	47+18	20 L	
C.B. 3	52+50	20 R	
C.B. 4	52+03	20 L	
Total 519-G 4			

N.B. Old C.B. removal included in C.B. price

SUMMARY OF INLET BASIN CASTINGS RAISED TO GRADE (I.B.)

Item No.	Station	Dist. Ror L.
I.B. 1	34+21	20 R
I.B. 2	34+84	20 L
I.B. 3	38+16	15.5 L
I.B. 4	38+25	20 R
I.B. 5	38+71	20 R
Total 519-G 5		

REMOVAL OF EXISTING CATCH BASINS

Item No.	Station	Remarks
R.B. 1	39+12	Exist. casting to be used in new C.B.
R.B. 2	47+18	" " " " " " " " " "
R.B. 3	52+50	" " " " " " " " " "
R.B. 4	52+03	" " " " " " " " " "
Total 519-G 4		

CURB INCIDENTALS ADJACENT TO BASINS RAISED TO GRADE

Station	Ror L.	Dowel Holes Lin. Ft.	Reinf. Steel Lbs.	Curb Removal Lin. Ft.	New Curb Lin. Ft.
34+21	R	4	6.5	12	12
34+84	L	4	6.5	12	12
38+16	L	4	6.5	12	12
38+25	R	4	6.5	12	12
38+71	R	4	6.5	12	12
Totals 519-G 20 85- 60 60					

B.M. No. 7 Sta. 31+94
 S.W. Corner Concr. Shop
 317' to Lot E. Elev. 639.56

B.M. No. 8 Sta. 36+67
 S. Cap. Ball on Fire Hydrant
 25' to Lot E. Elev. 636.67

B.M. No. 9 Sta. 41+72
 Spike in 12" Maple on Left
 Elev. 634.270

B.M. No. 10 Lloyd Rd.
 U.S.G. Bench on Church
 Elev. 635.96

B.M. No. 11 Sta. 52+65
 X (Cross) S.E. Cor. Headwall
 50' to Lot E. Elev. 687.37

B.M. No. 12 Sta. 57+82
 Bolt in Foot. End Gas Pump
 50' to Lot E. Elev. 688.38

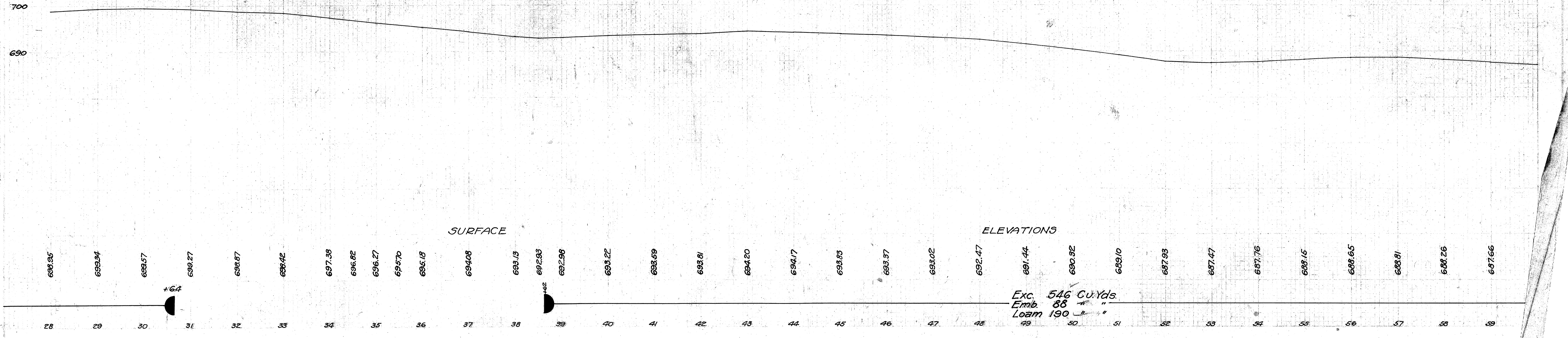

Exc. 546 Cu. Yds.
 Emb. 88
 Loam 190