

T.B.M. VERTICAL MONUMENT IN THE NORTH SIDE OF THE NORTH COLUMN OF THE EXISTING SOUTH CENTER PIER, BETWEEN NORTHBOUND AND SOUTHBOUND LANES OF STATE ROUTE 615. 2.9' ABOVE GROUND.  
ELEVATION = 637.97

FOUNDATION DATA  
ABUTMENTS AND PIERS SHALL BE FOUNDED ON 12" Ø CAST-IN PLACE REINFORCED CONCRETE PILES, THE ESTIMATED AVERAGE PILE LENGTH IS 55 LIN. FT. AT THE ABUTMENTS AND 35 LIN. FT. AT THE PIERS.

LEGEND:  
● FOUNDATION INVESTIGATION BORING  
B.T.A. = BRIDGE TERMINAL ASSEMBLY

EXISTING STRUCTURE	
TYPE:	FOUR SPAN CONTINUOUS REINFORCED CONCRETE DECK SLAB WITH REINFORCED CONCRETE SUBSTRUCTURE.
SPANS:	38'-0" (247'-6") AND 38'-0" (92' BEARINGS)
ROADWAY:	TWO AT 39'-8" FACE TO FACE OF CURBS
SKEW:	14° 56' 30" LEFT FORWARD
DESIGN LOADING:	CF 20DD
DATE BUILT:	1959
STRUCTURE FILE NUMBER:	43DD99B LEFT BRIDGE (WESTBOUND) A3D1D21 RIGHT BRIDGE (EASTBOUND)
APPROACH SLABS:	A5-1-54 (25'-0" LONG)
WEARING SURFACE:	LATEX MODIFIED CONCRETE

PROPOSED STRUCTURE	
TYPE:	CONTINUOUS COMPOSITE, A-572 STEEL BEAM WITH REINFORCED CONCRETE DECK AND SUBSTRUCTURE
SPANS:	86'-0" AND 95'-0" CENTER TO CENTER OF BEARINGS
ROADWAY:	TWO AT 52'-0" TDE TO TDE OF BARRIERS
DESIGN LOADING:	H52D-44 (CASE I) AND THE ALTERNATE MILITARY LOADING
SKEW:	14° 59' 49" LEFT FORWARD
WEARING SURFACE:	MONOLITHIC CONCRETE
APPROACH SLABS:	A5-1-81 (20'-0" LONG)
ALIGNMENT:	TANGENT
NORMAL CROWN:	(3/16" / FT.)
LATITUDE:	41 DEG. 41.2 MIN.
LONGITUDE:	81 DEG. 20.4 MIN.
TRAFFIC:	63,790 A.D.T. (2013) 5,103 A.D.T.T. (2013)

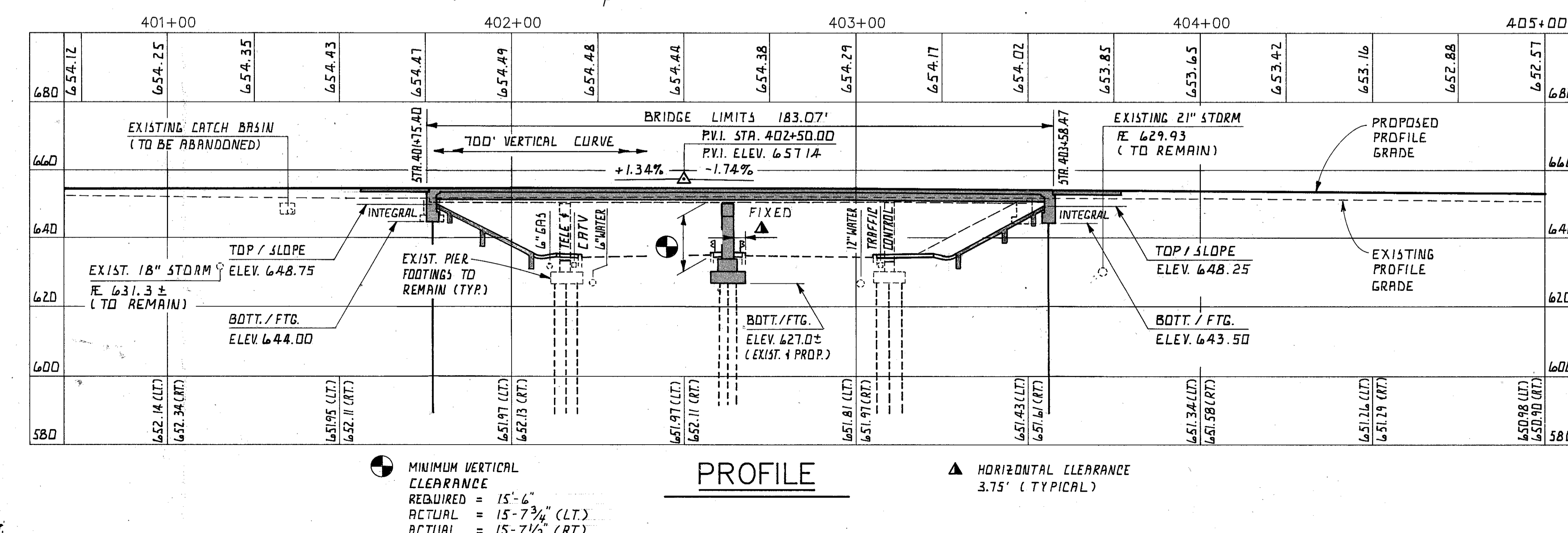

REVIEWED BY BURGESS & NIPLE, LTD.  
R.M.K. 10-04-94

adache-ciuni-lynn associates CONSULTING ENGINEERS  
 DATE 4/19/94  
 DRAWN T.M.J.  
 DESIGNED C.T.  
 LAKE COUNTY STR. 401+75.40  
 BRIDGE NUMBER LAK-2-0955 L/R OVER STATE ROUTE 615  
 LAK-2-946  
 1/24  
 48  
 71