

T.B.M. STA 411+45 (E)
TOP OF NORTH BOLT
ON LIGHT POLE FOUNDATION ELEV. 640.36
MATCH LINE SEE SHEET No. 21
STA. 410+00

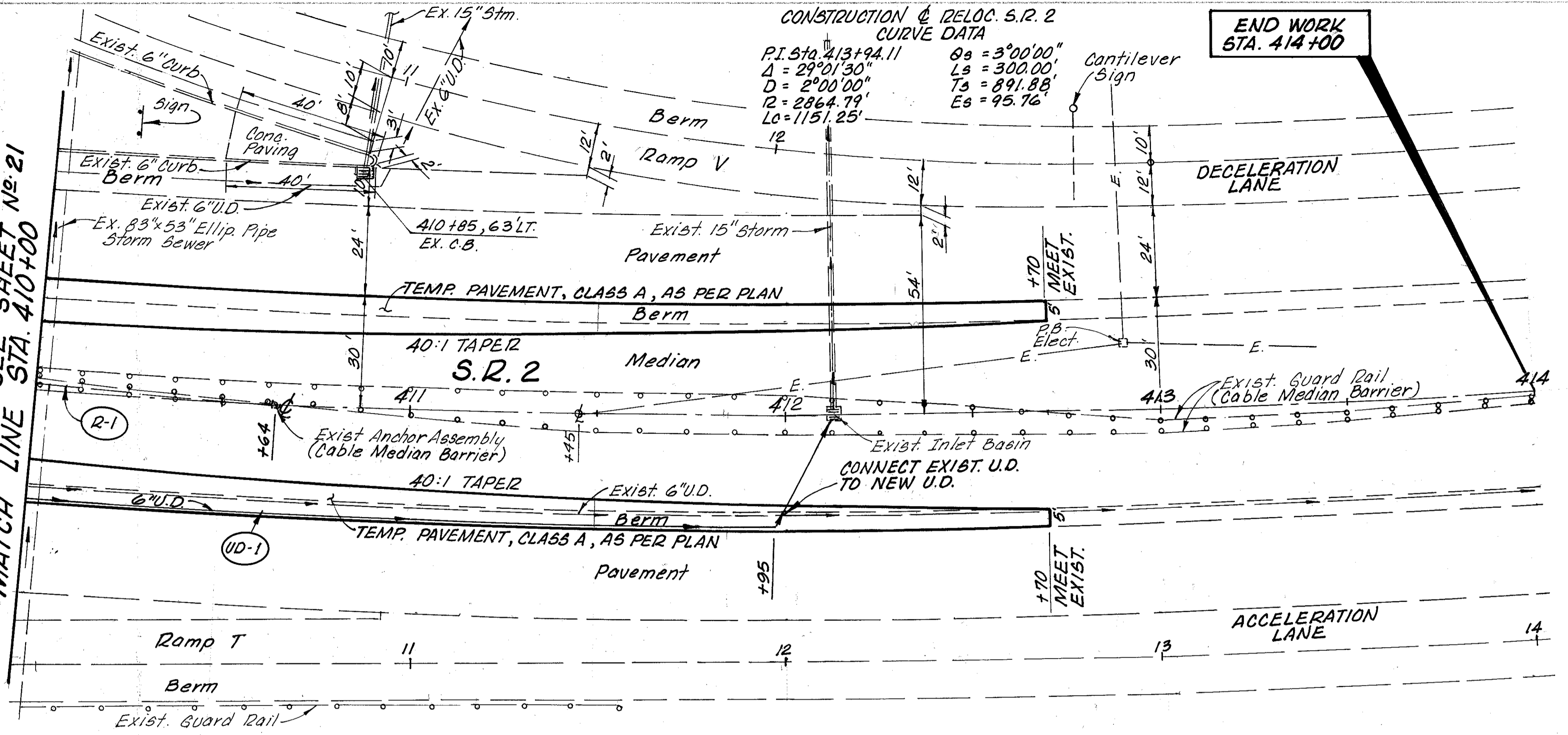

CONSTRUCTION & RELOC. S.R. 2
CURVE DATA
P.I. Sta. 413+94.11
Δ = 29°01'30"
D = 2°00'00"
L = 2364.79'
LC = 1151.25'
Es = 3°00'00"
Ls = 300.00'
Ts = 891.88'
Es = 95.76'

END WORK
STA. 414+00

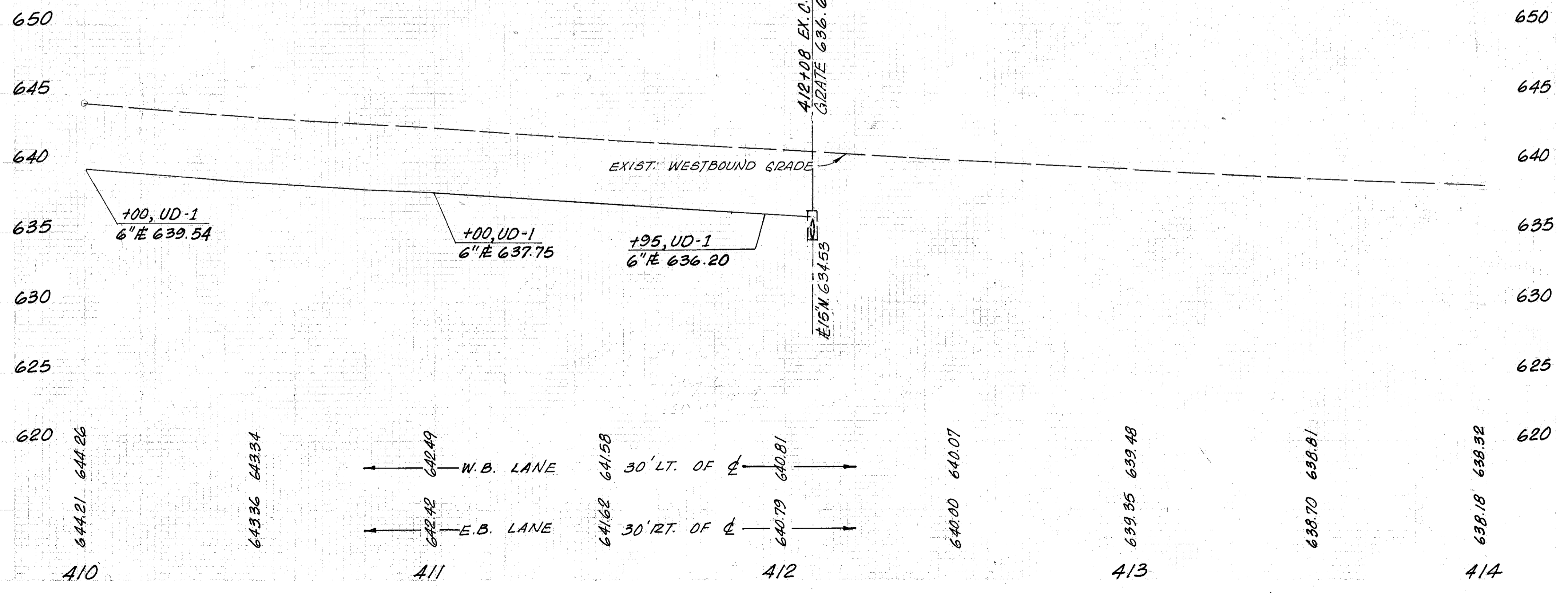

ESTIMATED QUANTITIES

| REF. NO. | STATION TO STATION | SIDE | GUARDRAIL REMOVED | ANCHOR ASSEMBLY REMOVED | 6" CONDUIT, TYPE F | 6" SHALLOW PIPE UNDEGROUND W/ FABRIC WRAP | EST. QTY | UNIT | | |
|-----------------------------------|--------------------|------|-------------------|-------------------------|--------------------|---|----------|------|----|-----|
| UD-1 | 410+00 TO 412+13 | RT. | L.F. | EACH | L.F. | L.F. | 64 | 1 | | |
| R-1 | 410+00 TO 410+64 | ℄ | L.F. | EACH | L.F. | L.F. | 64 | 1 | | |
| TOTALS CARRIED TO GENERAL SUMMARY | | | | | | | 64 | 1 | 95 | 195 |

* FOR 3 CABLE MEDIAN BARRIER

PLAN AND PROFILE
STA. 410+00 TO STA. 414+00

LAK-2-9.46

