

RETROFIT BASE PLATES FOR FENCE POSTS

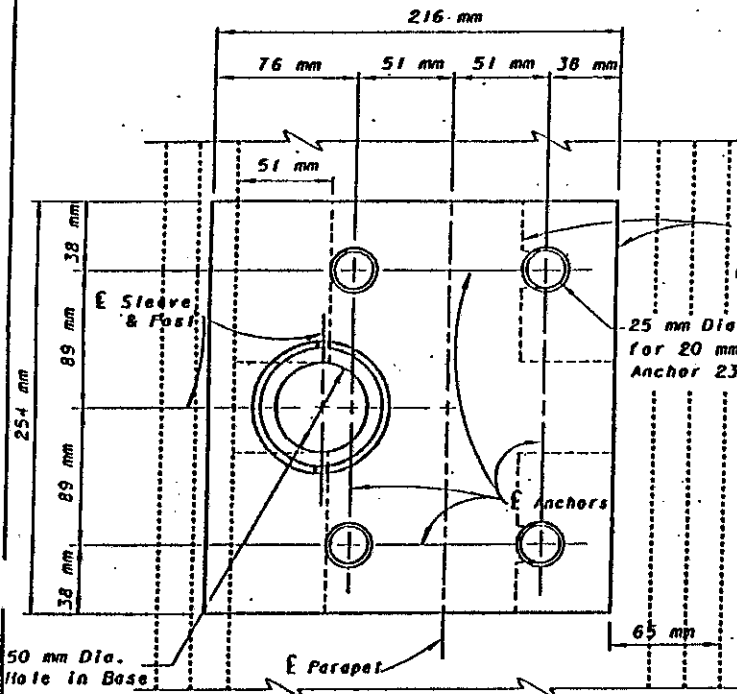

PLAN BP-1

SHIM POSITIONS ARE SHOWN, POST AND SET SCREWS NOT SHOWN

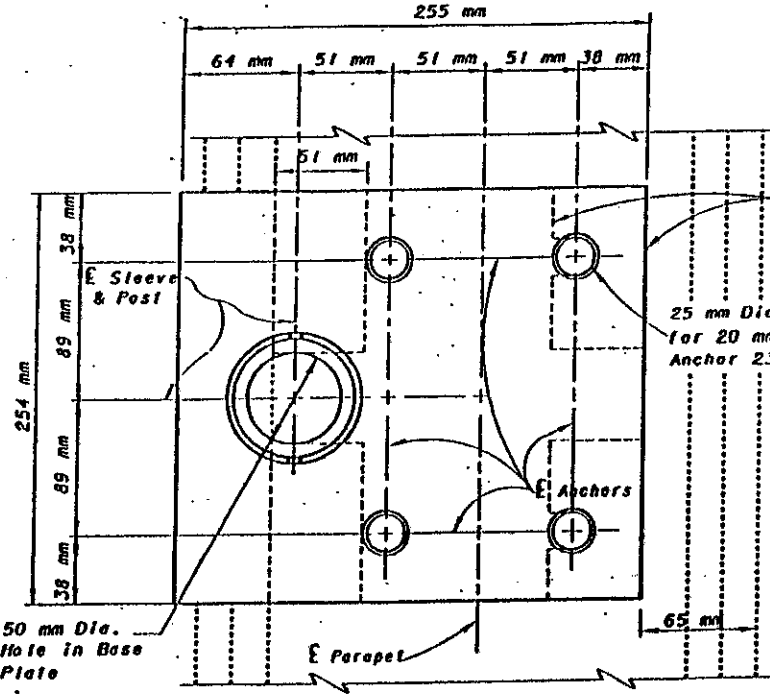

PLAN BP-2

SHIM POSITIONS ARE SHOWN, POST AND SET SCREWS NOT SHOWN

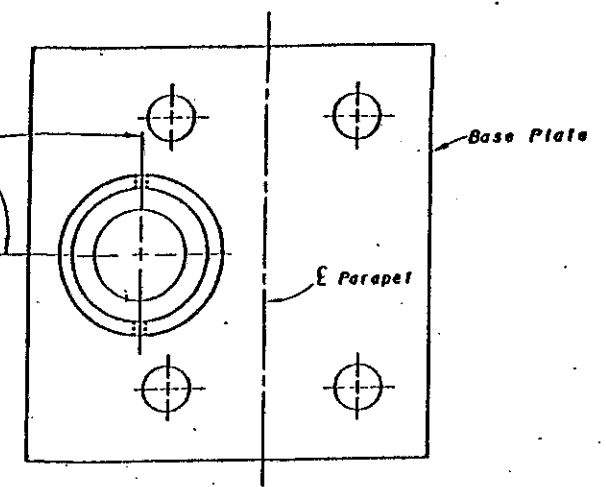

POST SLEEVE PLAN

POST AND SET SCREWS NOT SHOWN

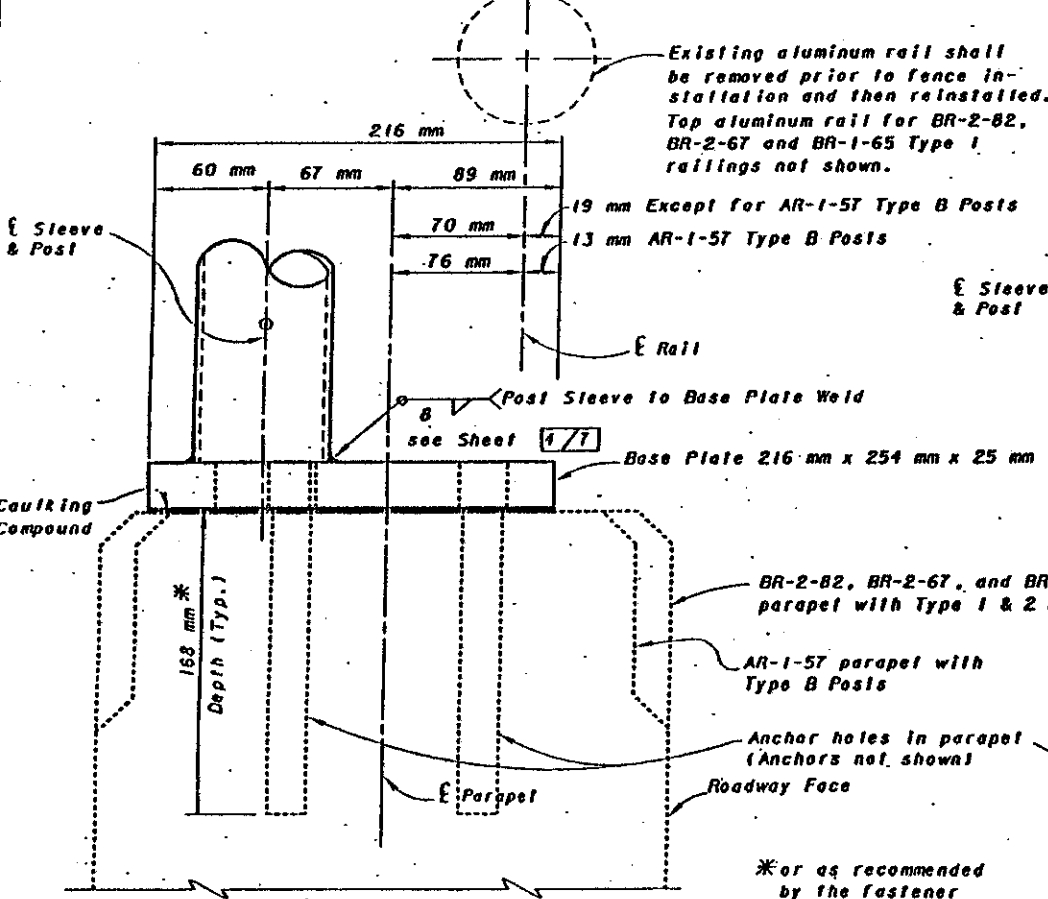

END VIEW BP-1

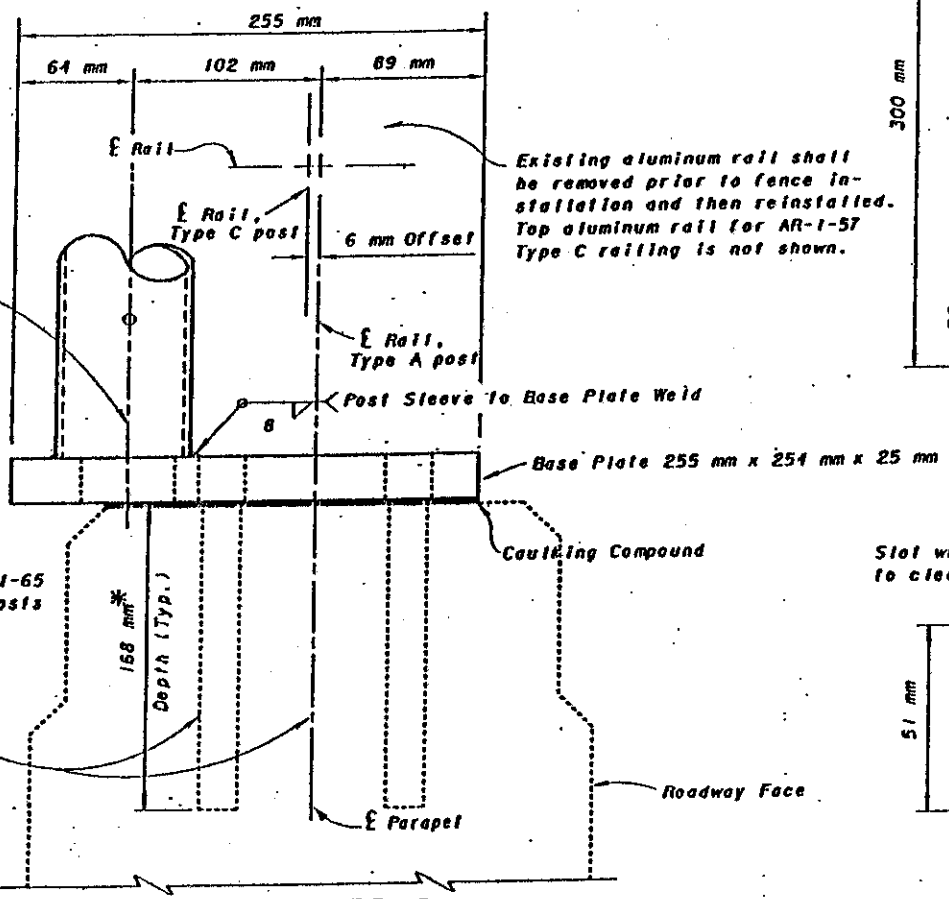

END VIEW BP-2

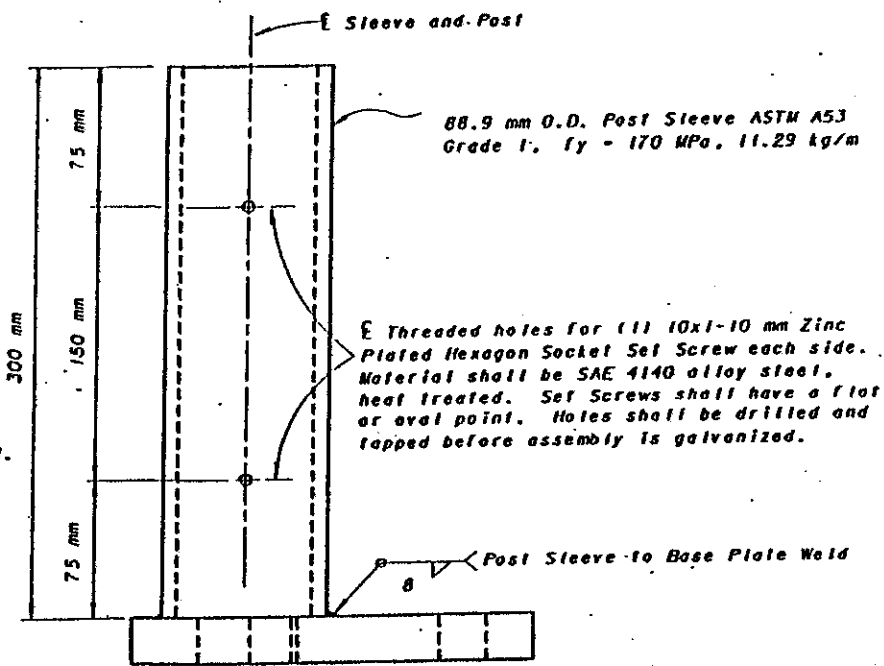

POST SLEEVE ELEVATION

POST AND SET SCREWS NOT SHOWN

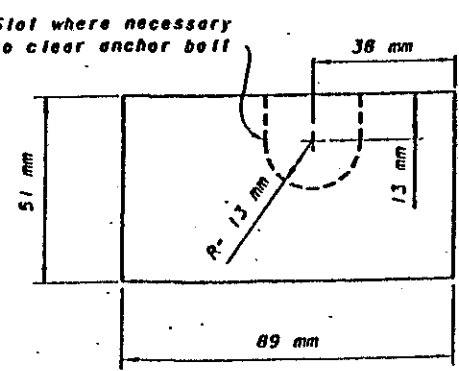

BASE PLATE SHIMS

2 mm, 3 mm and 6 mm thick

Fence shall be installed by removing and reinstalling the aluminum rail(s). Base Plate shall be used on parapets having aluminum railing as shown on Standard Drawings BR-2-82, BR-2-67, BR-1-65 with Types 1 & 2 Posts and AR-1-57 with Type B Posts. Base Plate requires a sleeve. See Post Sleeve Detail on this sheet.

Fence shall be installed by removing and reinstalling the aluminum rail(s). Base Plate shall be used on parapets having aluminum railing as shown on Standard Drawing AR-1-57 with Types A and C posts. Base Plate requires a sleeve. See Post Sleeve Details on this sheet.

*or as recommended by the fastener manufacturer.

DESIGN AGENCY	BUREAU OF BRIDGES AND STRUCTURAL DESIGN
DATE	3-20-75
ENGINEER OF BRIDGES	<i>Richard E. Engel</i>
STATE OF OHIO DEPARTMENT OF TRANSPORTATION	
REVISIONS	PREPARED JCR
CHECKED	RLD
REVIEWED	WTF/LAW
DRAWING NO.	VFF-1-90M
DRAWN	GF/J/RJS
STANDARD DRAWING	VANDAL PROTECTION FENCE RETROFIT BASE PLATES WHEN RAILS ARE REMOVED AND REINSTALLED
PAGE	3/7