

BUTT JOINT AS PER BP-3.1
 DRIVEWAY REPLACEMENT, FOR DETAILS SEE SHEET 20.
 FOR TYPICAL SECTIONS SEE SHEET 2-3.
 FOR CROSS SECTIONS SEE SHEETS 15-19.
 FOR PAVEMENT QUANTITY TABLES SEE SHEET 9.
 FOR ROADWAY AND DRIVEWAY QUANTITY TABLES SEE SHEET 14.
 FOR BRIDGE DETAILS SEE SHEETS 21-40.
 FOR DRIVEWAY PROFILE SEE SHEETS 16.
 FOR GENERAL SUMMARY SEE SHEETS 10-11.
 FOR PAVEMENT MARKING DETAILS SEE SHEET 20.

BENCHMARK: CHIELED □ ON SOUTHWEST CORNER CONCRETE ABUTMENT FOR RAILROAD BRIDGE. (S.R.2) STA. 139+02.79, 61.03' RT. ELEV. 625.81

EXISTING STRUCTURE
 TYPE: 4 SPAN CONTINUOUS STEEL BEAMS WITH REINFORCED CONCRETE DECK AND SUBSTRUCTURE
 SPANS: 53'±, 75'±, 75'±, 75'± C/C BEARINGS
 ROADWAY: 30'-0"± F/F 2'-2" CURBS
 SKEW: 38°-57'-34" L.F.
 ALIGNMENT: TANGENT AND 8° CURVE LEFT
 CONDITION: FAIR
 DATE BUILT: 1960
 STRUCTURE FILE NUMBER: 4300637

PROPOSED STRUCTURE
 TYPE: 4 SPAN CONTINUOUS STEEL BEAMS WITH REINFORCED CONCRETE DECK AND SUBSTRUCTURE
 SPANS: 53', 75', 75', 75' C/C BEARINGS
 ROADWAY: 28'-0" F/F 4' SIDEWALKS W/CONC. PARAPETS AND CHAIN LINK FENCE
 LOADING: HS20-44 AND THE ALTERNATE MILITARY LOADING (CASE II)
 WEARING SURFACE: MONOLITHIC CONCRETE
 CROWN: 1/4" PER FOOT
 APPROACH SLABS: AS-1-81 (25'-0" LONG)
 SKEW: 38°-57'-34" L.F.
 ALIGNMENT: TANGENT AND 8° CURVE LEFT

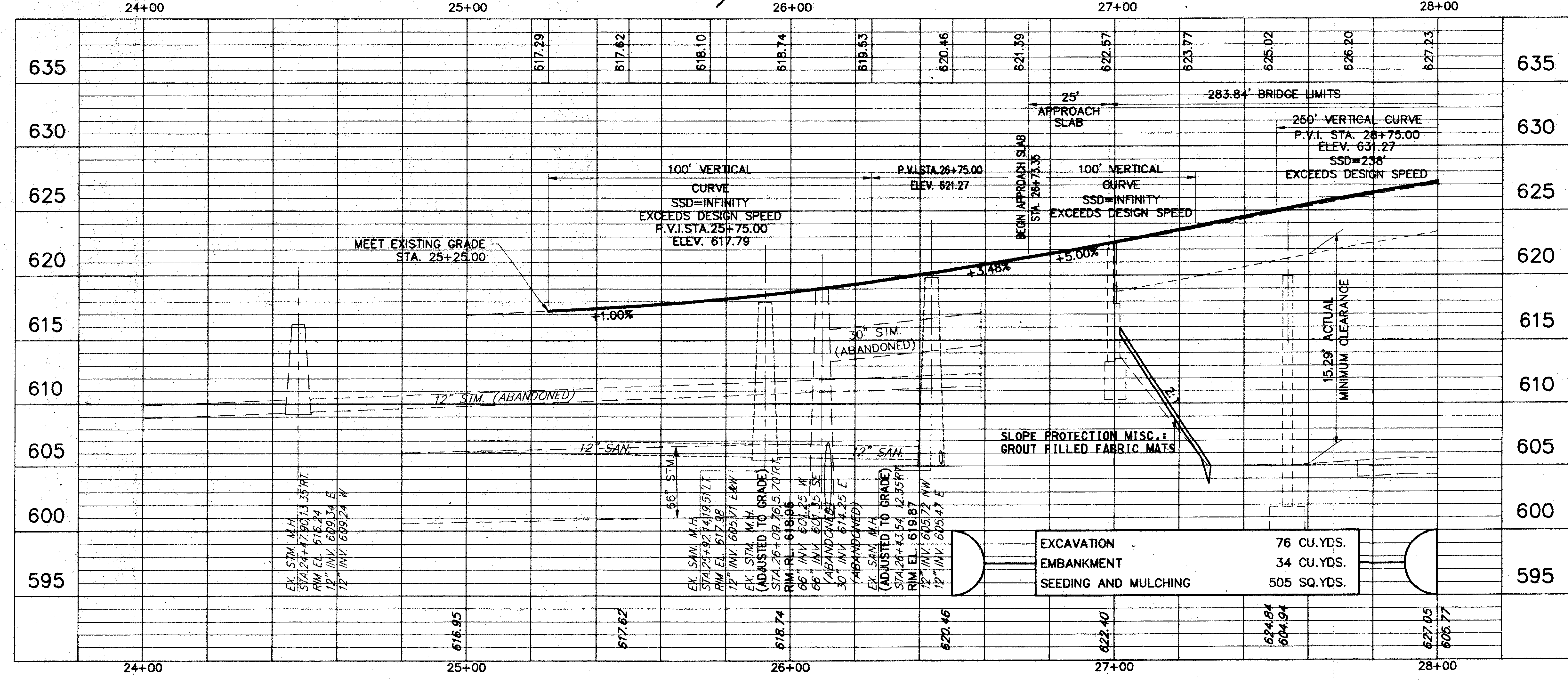

PLAN AND PROFILE STA. 25+00 TO STA. 28+00