

MICROFILMED
SEP 23 1985

FED. RD. DIVISION	STATE	PROJECT
2	OHIO	

248
297

LAKE COUNTY
SEC LAK-2-4.42

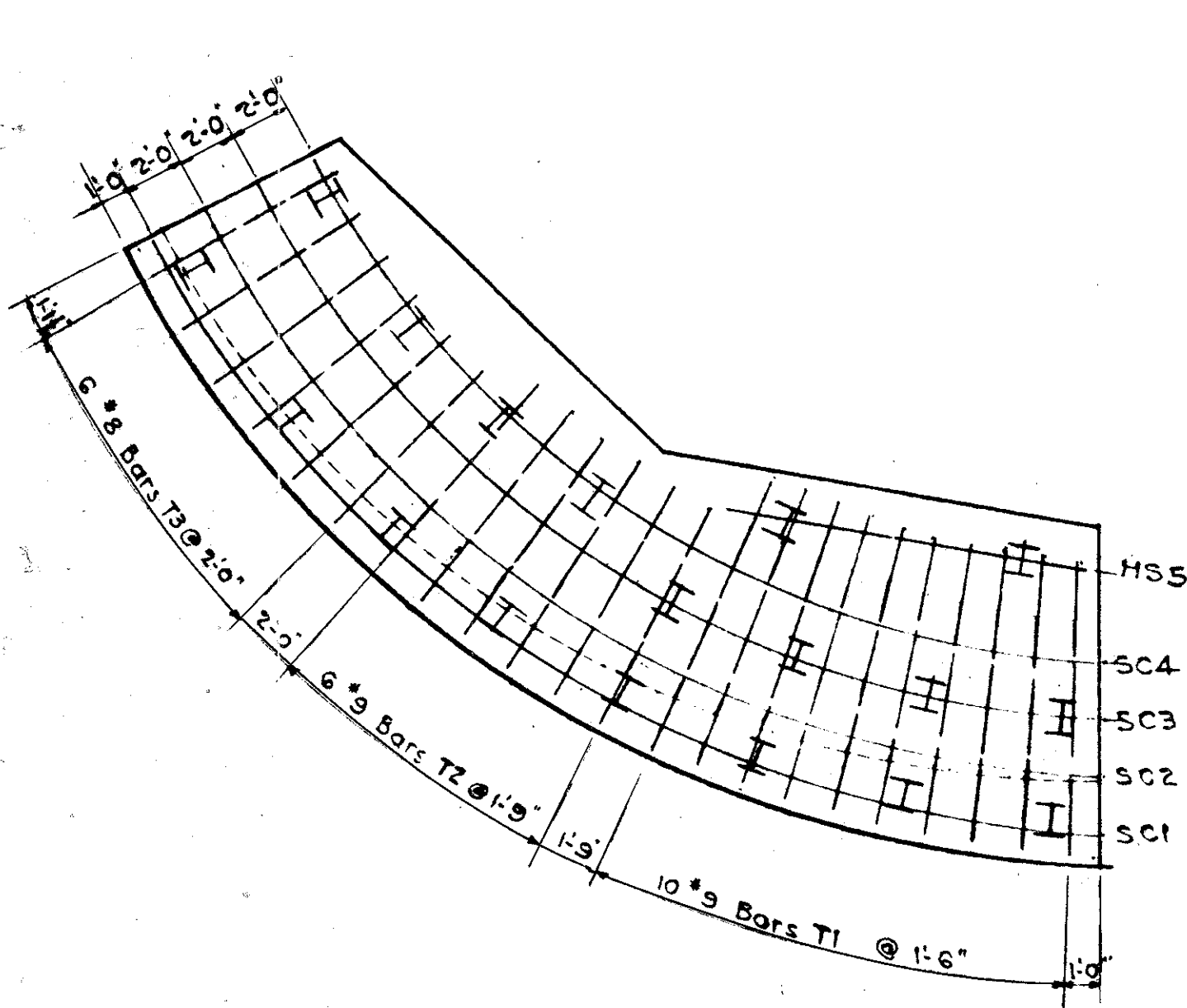

FOOTING PLAN

Toe reinf. bars placed radially and spaced along face of Wing.

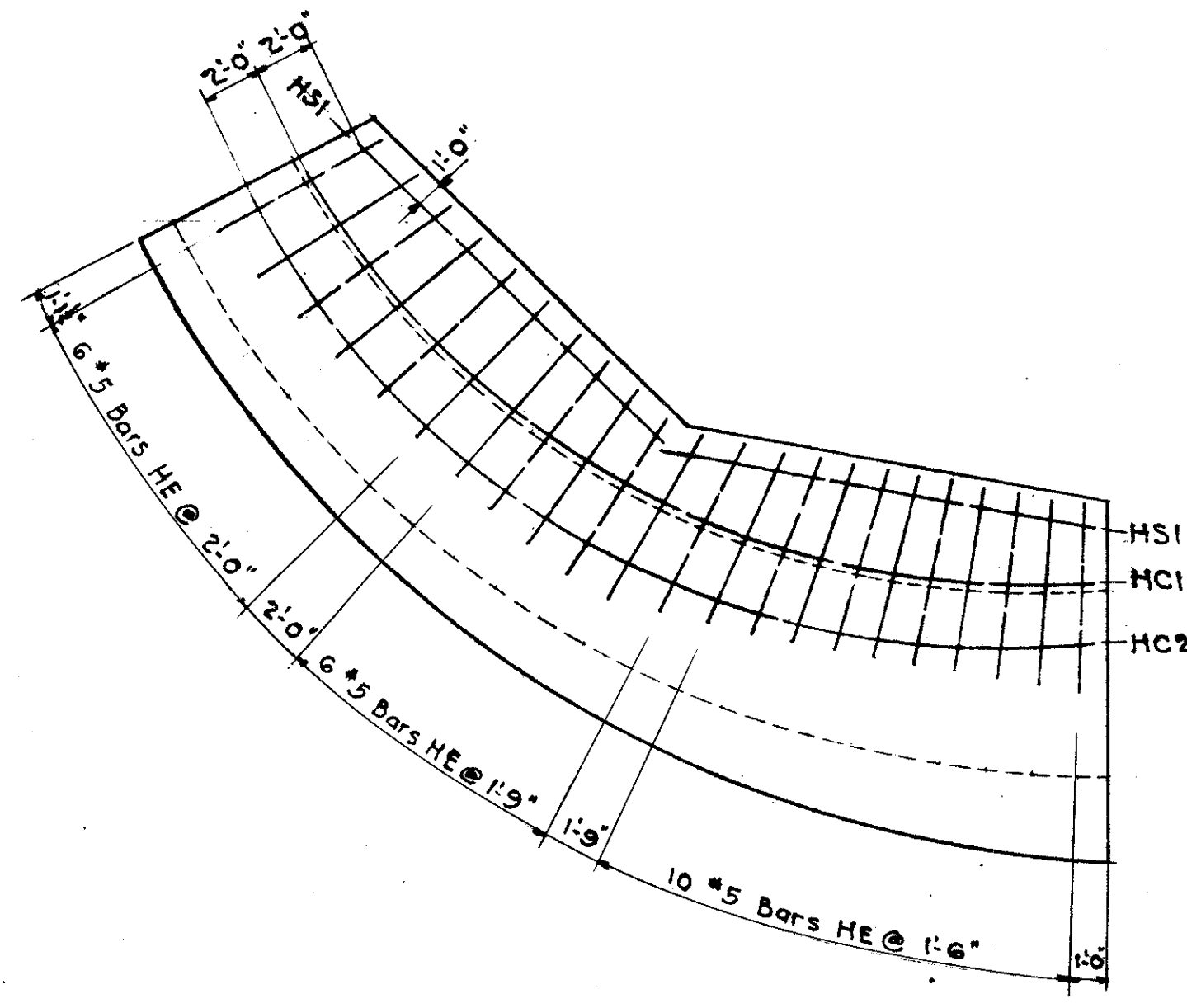
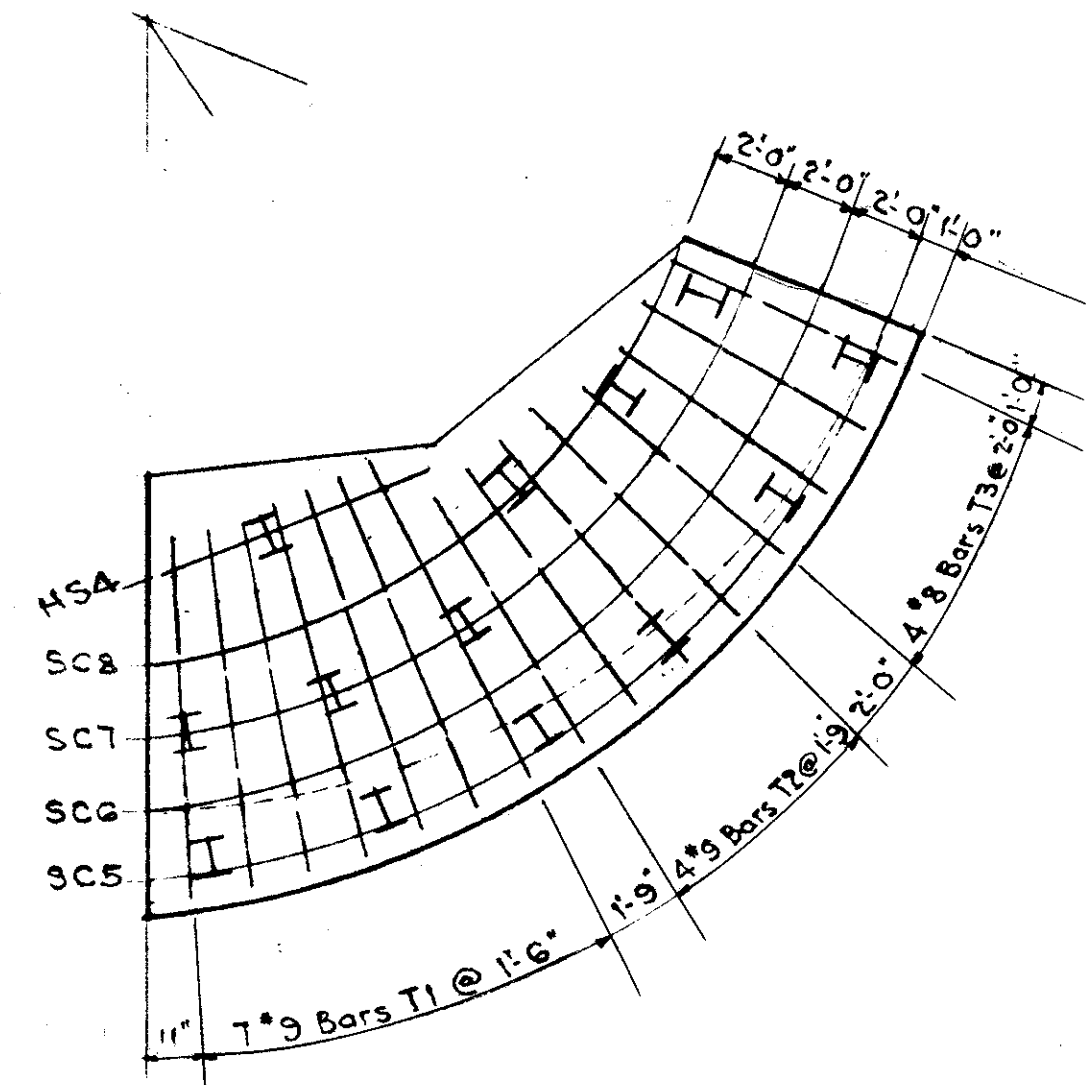

FOOTING PLAN

Reinf. bars in top of footing placed radially and spaced along face of Wing.

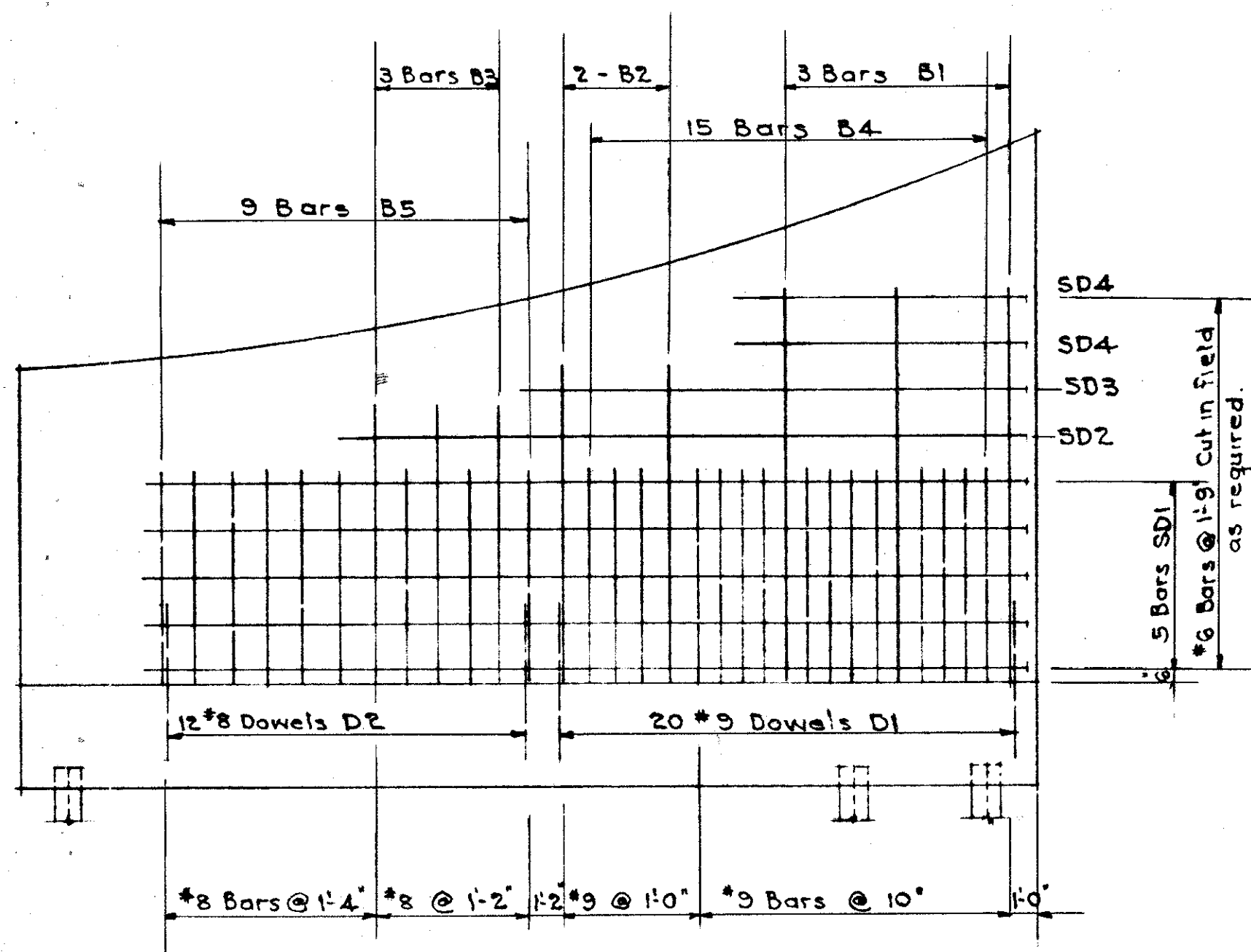
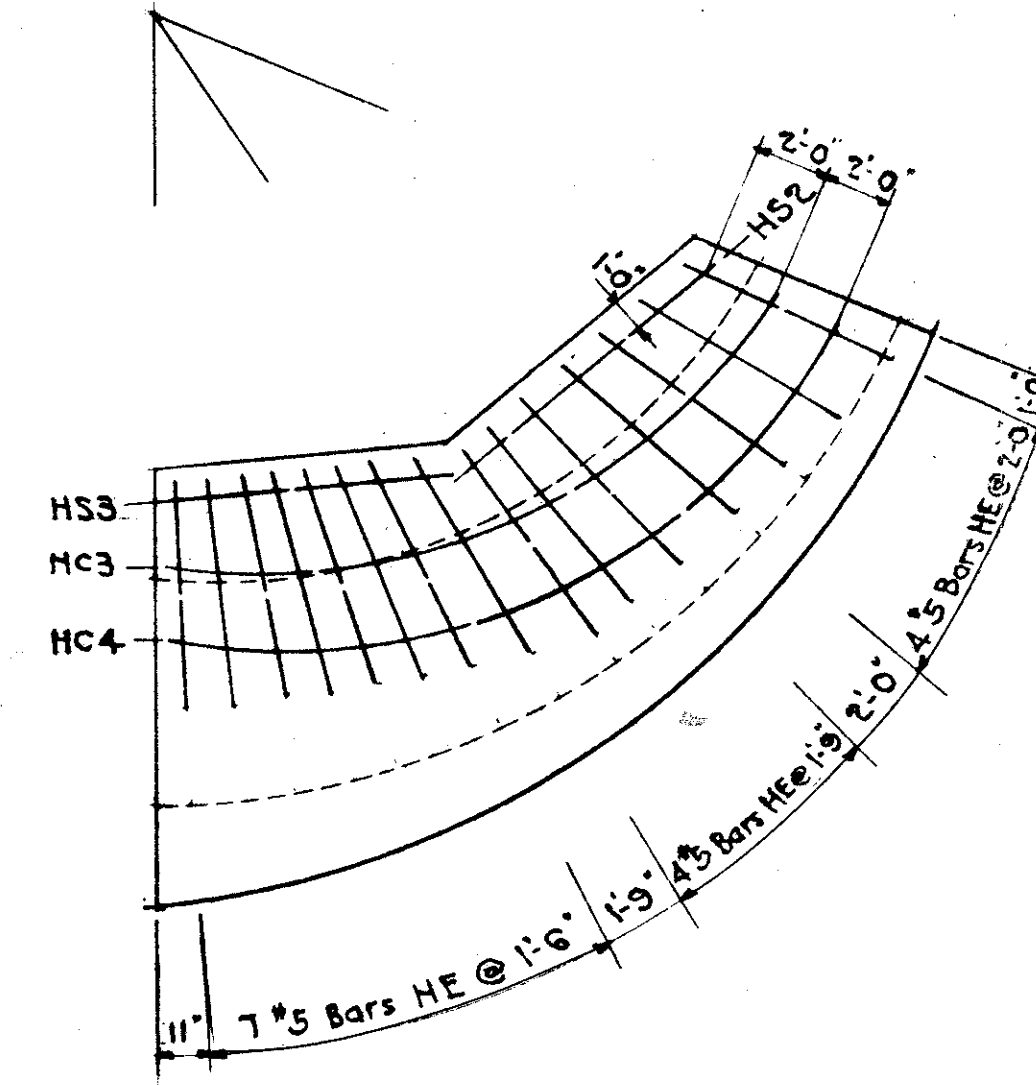

ELEVATION OF WINGS
Reinf. bars in the back of wings shown.

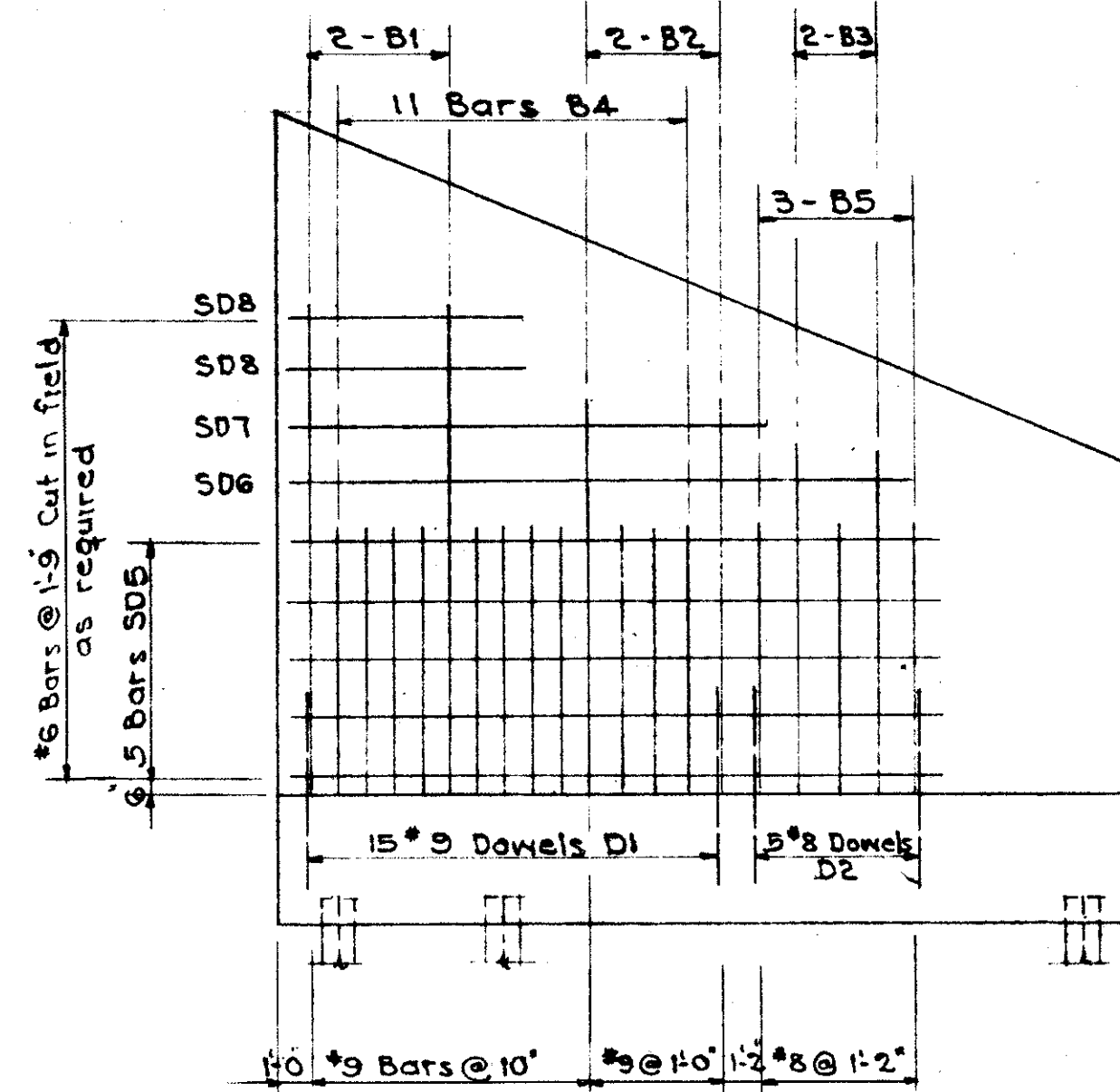

ESTIMATED QUANTITIES - SUBSTRUCTURE

ITEM	DESCRIPTION	TOTAL
E2	Unclassified Excavation	585 c.y.
S1	Class 'E' Concrete, Footings	341 c.y.
S1	Class 'E' Concrete, Walls	606 c.y.
S1	Class 'C' Concrete, Pier	43 c.y.
S3	Type 'A' Waterproofing	385 s.f.
S4	Reinforcing Steel	31,000 lbs.
S9	1" Reformed Expansion Joint Filler (Cork)	345 s.f.
S9	6" x 7.5" Lead Water Stop	98 L.F.
S9	15" x 7.5" Lead Flashing	84 L.F.
S18	Steel H Piles 12" DP x 53"	3750 L.F.
S29	64 Perforated Bituminous Coated Corrugated Metal Pipe, Sec. M-6.4 (F)	235 L.F.
S29	64 Bituminous Coated Corrugated Metal Pipe, Sec. M-6.4 (C)	80 L.F.
S29	Parous Back-fill	193 c.y.
S-16	First test pile	Lump Sum
S-15	Temporary railroad run-around	Lump Sum
E-2	Cofferdams, cribs and sheeting	Lump Sum

Correct *John T. Budik*
Engineer of Structures
Correct *Geo. E. Robinson*
Assistant Chief Engineer
Approved *C.E. Spindel*
Chief Engineer

Highway Bridge No. LAK-2-0453
N.Y.C. SYSTEM OFFICE OF CHIEF ENGINEER NEW YORK, N.Y.
BRIDGE No. 56 1/2 C.E.I. Co. SPUR
GRADE SEPARATION
LAKELAND EXPRESSWAY (S.R.2)
WILLOUGHBY, OHIO
MASONRY PLAN-WINGS
Western District Lake Division Sheet 9 of 11
Scale: 3/8" = 1'-0" Dec. 22, 1958 Val. Sec. 203 File No. 93143

DATE	BY	REVISIONS
5-29-59	R.A.L.	Revised for filing

