

H-5 F-10
 MICROFILMED
 SEP 23 1986

FED. RD. DIVISION	STATE	PROJECT	239
2	OHIO	F-U-329 (15)	297

LAKE COUNTY
 SEC. LAK - 2 - 4.42

B.M. # 3 Lag Bolt in Root 20" Poplar
 150' Rt. Sta. 137 + 50 El. 629.563

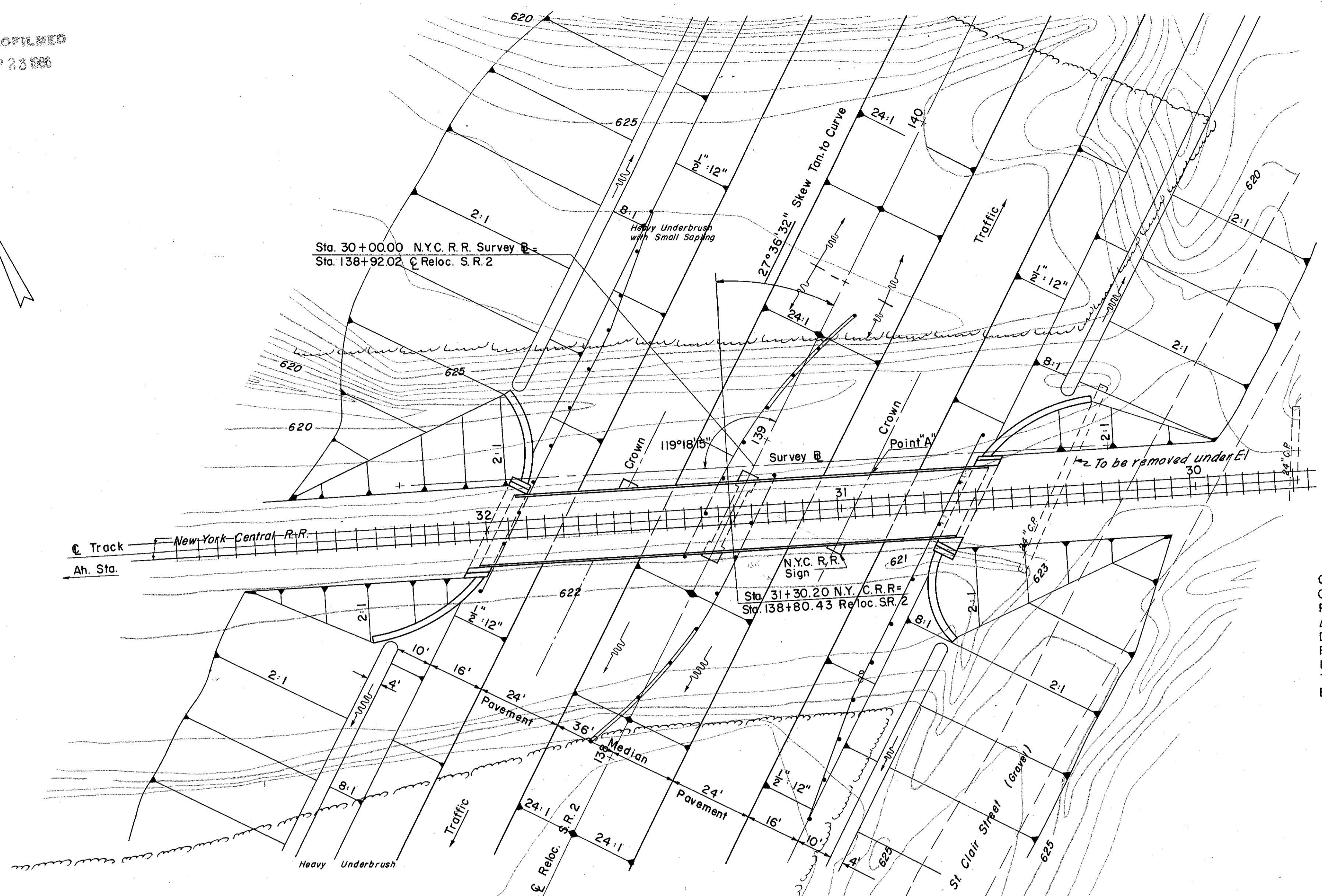

CONSTR. @ SR-2
 CURVE DATA
 P.I. Sta. 134 + 29.14
 $\Delta = 8^\circ 07' 10''$ Rt.
 $D = 0^\circ 28'$
 $R = 12,277.66'$
 $L = 1739.88'$
 $T = 871.39'$
 $E = 30.83'$

PROPOSED STRUCTURE
 TYPE: 2 Simple Spans, half thru Plate Girder (Riveted) with Reinforced concrete, Substructure.
 SPANS: 65'-6", 65'-6" @ Pier to @ Abut. Brgs. Single Track 19'-0" @c Girders.
 SKEW: 27° 36' 32" Tangent to Curve.
 LOADING: Cooper's E-72.
 ALIGNMENT: N.Y.C.R.R. Tangent, SR-2 0° 28' Curve Rt.
 TRAIN TRAFFIC: Two (2) Freight Trains daily @ 15 M.P.H.

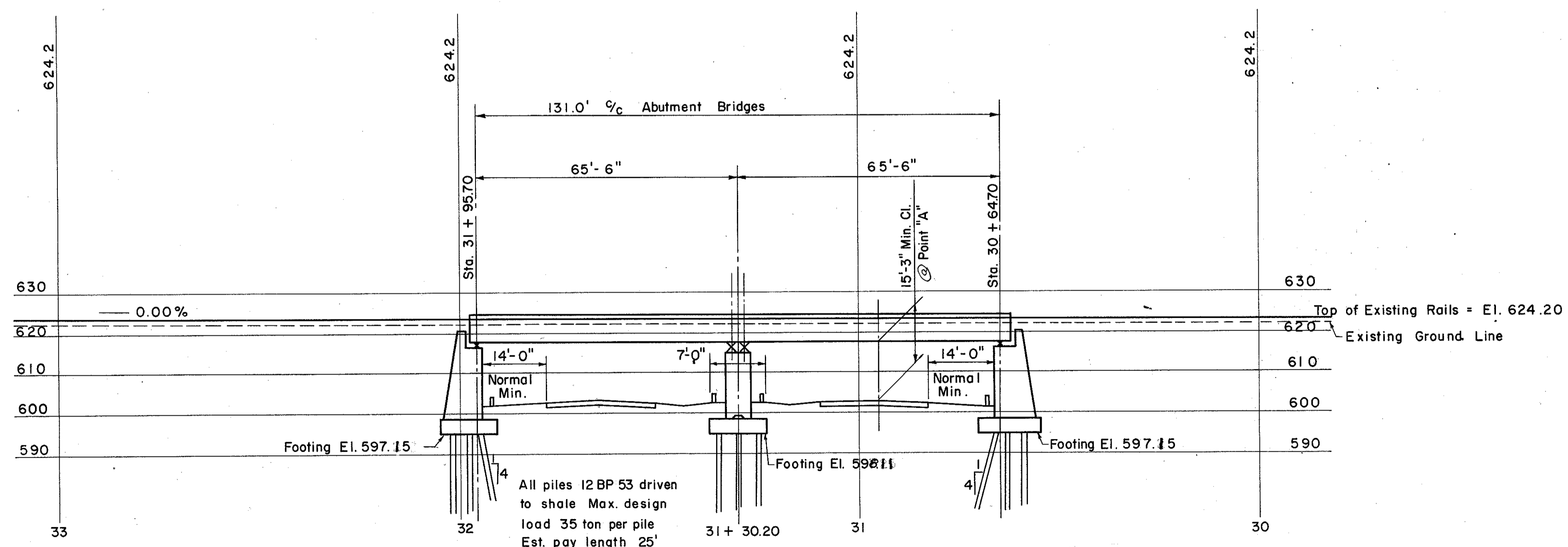

PROFILE ALONG @ TRACK N.Y.C.R.R.

FOUNDATION SOUNDINGS
 Foundation design and foundation quantities are based on a study of borings and soil-samplings made at the site. This sounding information may be inspected in the office of the Bureau of Bridges in Columbus or in the Division office, but the State does not guarantee the accuracy thereof.

PREPARED BY
 CAPITOL ENGINEERING ASSOCIATES, DILLSBURG, PA.
 FOR

STATE OF OHIO
 DEPARTMENT OF HIGHWAYS
 DIVISION OF DESIGN AND CONSTRUCTION
 BUREAU OF BRIDGES

SITE PLAN
 BRIDGE NO. LAK-2-0453
 RELOC. S.R. 2 UNDER N.Y.C.R.R.
 LAKE COUNTY
 STA. 138 + 80.43

DESIGNED	DRAWN	TRACED	CHECKED	REVISED	DATE	REVISED
		J.B.				