

LAKE COUNTY  
LAK-2-4.42

P.C. Sta. 6+10.14

S. R. 306  
SPIRAL DATA  
P.I. Sta. 24+15.15  
 $\Delta_s = 4^\circ 49' 00''$   
 $\Delta_c = 3^\circ 00' 00''$   
 $D_c = 3^\circ 00' 00''$   
 $L_s = 200.00'$   
 $L_c = 160.56'$   
 $T_s = 280.89'$   
 $E_s = 9.41'$

Sta 24+31.66 Constr. C. S. R. 306 =  
Sta. 0+04.69 C. Ramps M & N

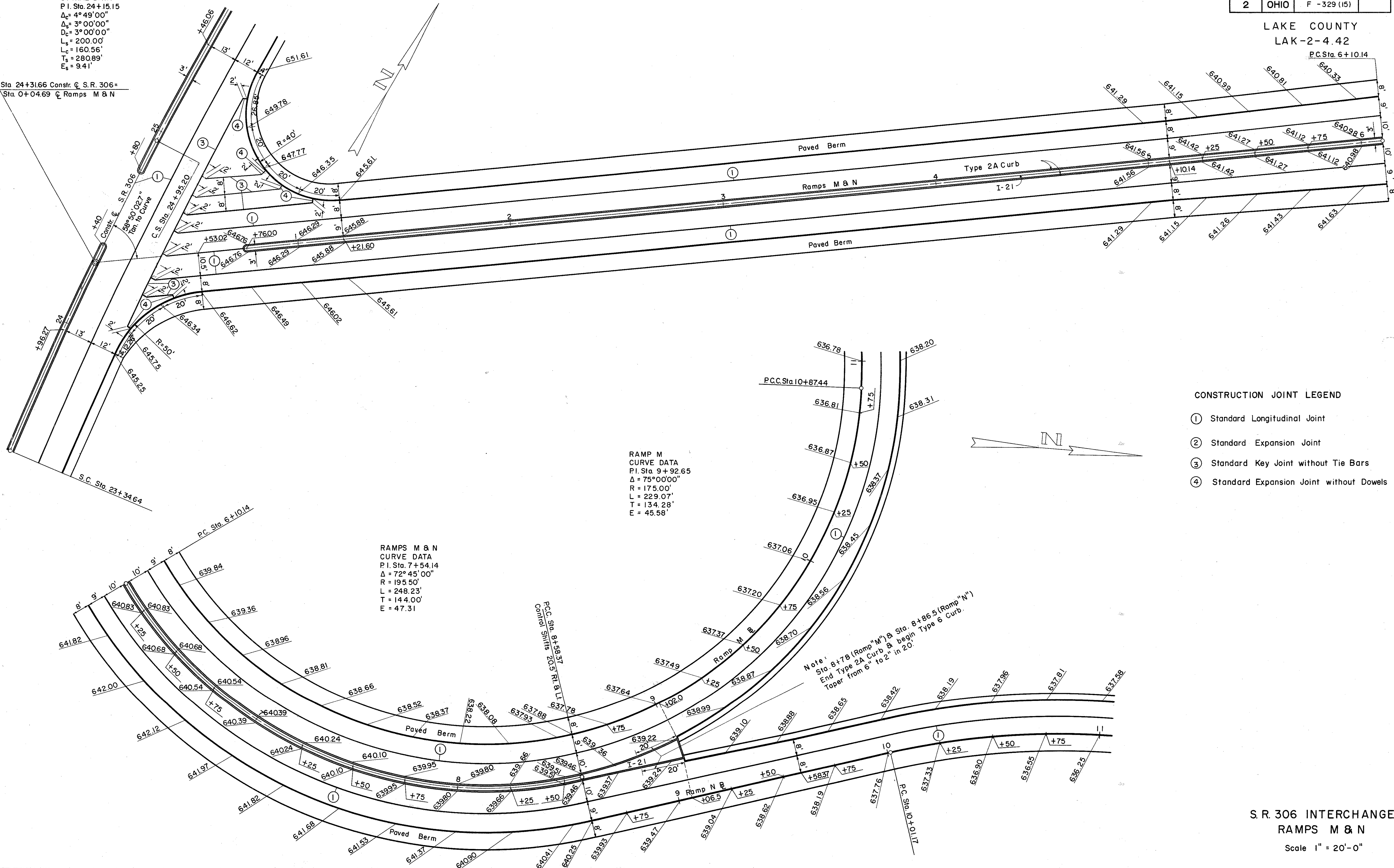

CONSTRUCTION JOINT LEGEND

- ① Standard Longitudinal Joint
- ② Standard Expansion Joint
- ③ Standard Key Joint without Tie Bars
- ④ Standard Expansion Joint without Dowels

S. R. 306 INTERCHANGE  
RAMPS M & N

Scale 1" = 20'-0"