

LAKE COUNTY
LAK - 2 - 4.42

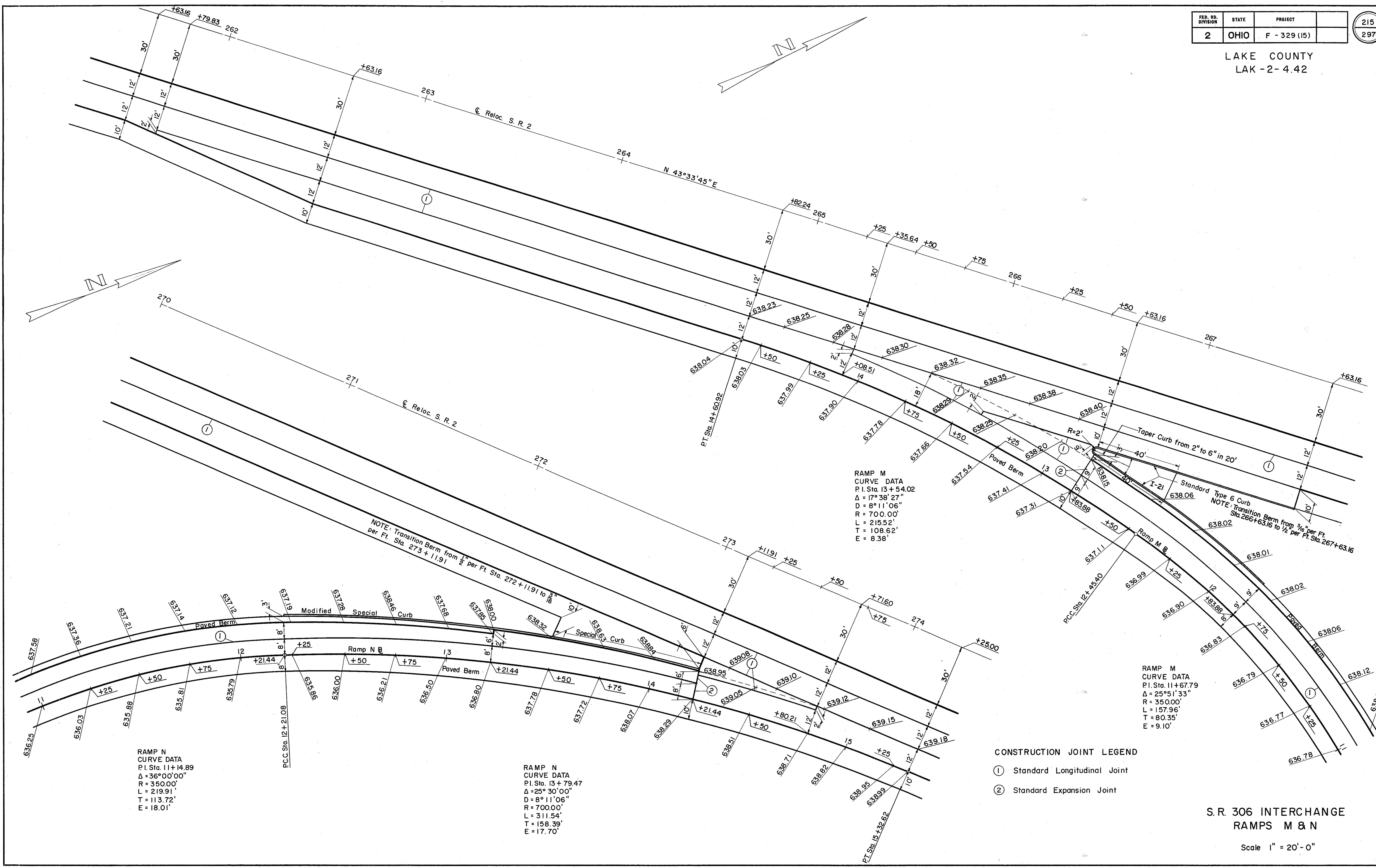

RAMP M
CURVE DATA
P.I. Sta. 13 + 54.02
 $\Delta = 17^{\circ}38'27''$
 $D = 8^{\circ}11'06''$
 $R = 700.00'$
 $L = 215.52'$
 $T = 108.62'$
 $E = 8.38'$

RAMP M
CURVE DATA
P.I. Sta. 11 + 67.79
 $\Delta = 25^{\circ}51'33''$
 $R = 350.00'$
 $L = 157.96'$
 $T = 80.35'$
 $E = 9.10'$

RAMP N
CURVE DATA
P.I. Sta. 11 + 14.89
 $\Delta = 36^{\circ}00'00''$
 $R = 350.00'$
 $L = 219.91'$
 $T = 113.72'$
 $E = 18.01'$

RAMP N
CURVE DATA
P.I. Sta. 13 + 79.47
 $\Delta = 25^{\circ}30'00''$
 $D = 8^{\circ}11'06''$
 $R = 700.00'$
 $L = 311.54'$
 $T = 158.39'$
 $E = 17.70'$

NOTE: Transition Berm from $\frac{1}{2}$ " per Ft. Sta. 272 + 11.91 to $\frac{3}{8}$ " per Ft. Sta. 273 + 11.91

- CONSTRUCTION JOINT LEGEND
- ① Standard Longitudinal Joint
 - ② Standard Expansion Joint

S.R. 306 INTERCHANGE
RAMPS M & N

Scale 1" = 20'-0"