

LAKE COUNTY
LAK-2- 4.42

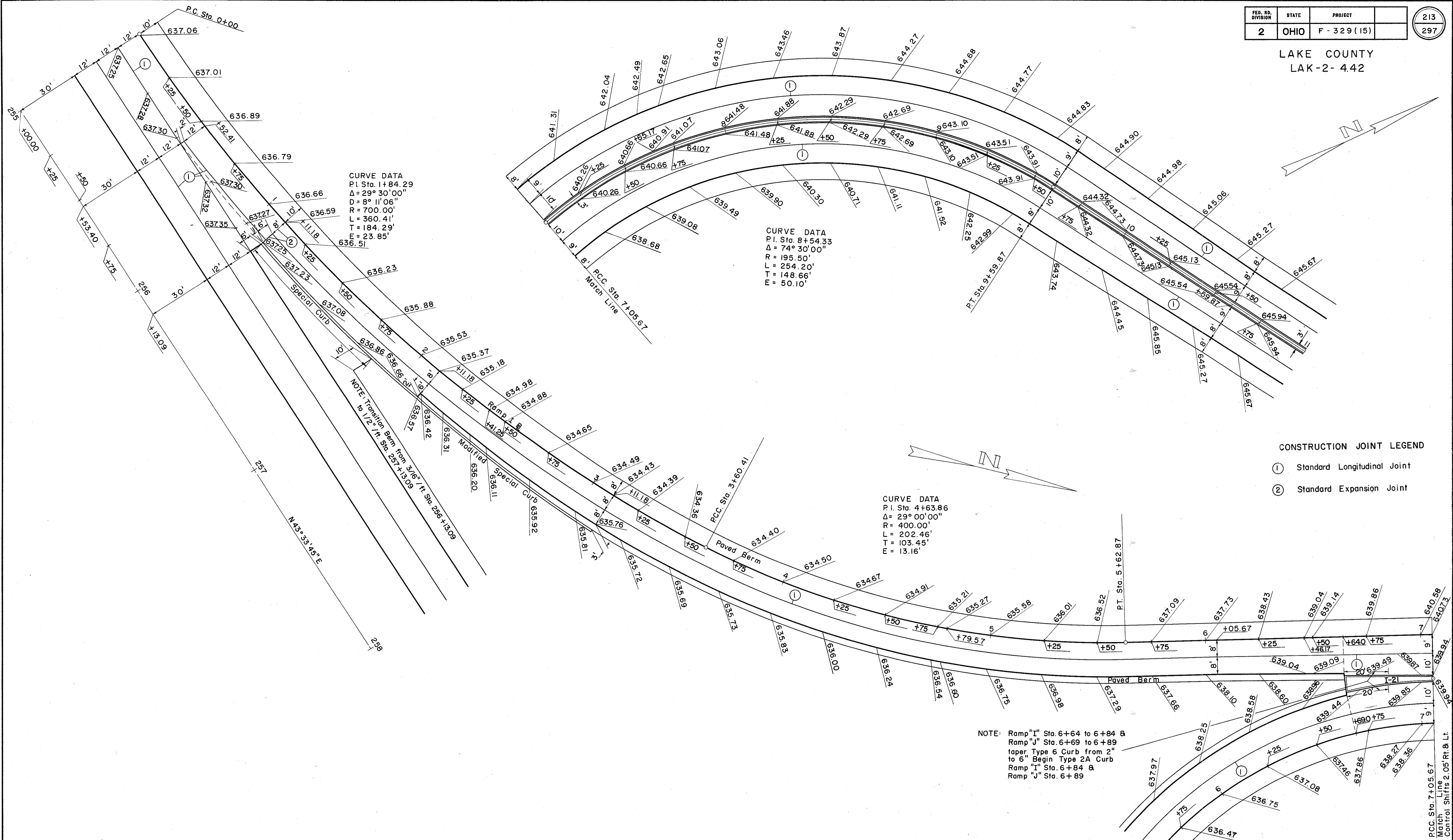

CURVE DATA
P.I. Sta. 1+84.29
 $\Delta = 29^\circ 30' 00''$
 $D = 8^\circ 11' 06''$
 $R = 700.00'$
 $L = 360.41'$
 $T = 184.29'$
 $E = 23.85'$

CURVE DATA
P.I. Sta. 8+54.33
 $\Delta = 74^\circ 30' 00''$
 $R = 195.50'$
 $L = 254.20'$
 $T = 148.66'$
 $E = 50.10'$

CURVE DATA
P.I. Sta. 4+63.86
 $\Delta = 29^\circ 00' 00''$
 $R = 400.00'$
 $L = 202.46'$
 $T = 103.45'$
 $E = 13.16'$

CONSTRUCTION JOINT LEGEND

- ① Standard Longitudinal Joint
- ② Standard Expansion Joint

NOTE: Transition Berm from 3/16" Ft. Sta. 257+13.09 to 1/2" Ft. Sta. 257+13.09

NOTE: Ramp "I" Sta. 6+64 to 6+84 &
Ramp "J" Sta. 6+69 to 6+89
taper Type 6 Curb from 2" to 6" Begin Type 2A Curb
Ramp "I" Sta. 6+84 &
Ramp "J" Sta. 6+89

SR. 306 INTERCHANGE
RAMPS I & J
SCALE: 1" = 20'

P.C. Sta. 7+05.67
Line
Match
Control Shifts 2.05' Rt. & Lt.