

SEEDING  
END AREA  
1753

U-329 (15)

155  
297

LAKE COUNTY  
LAK-2-4.42

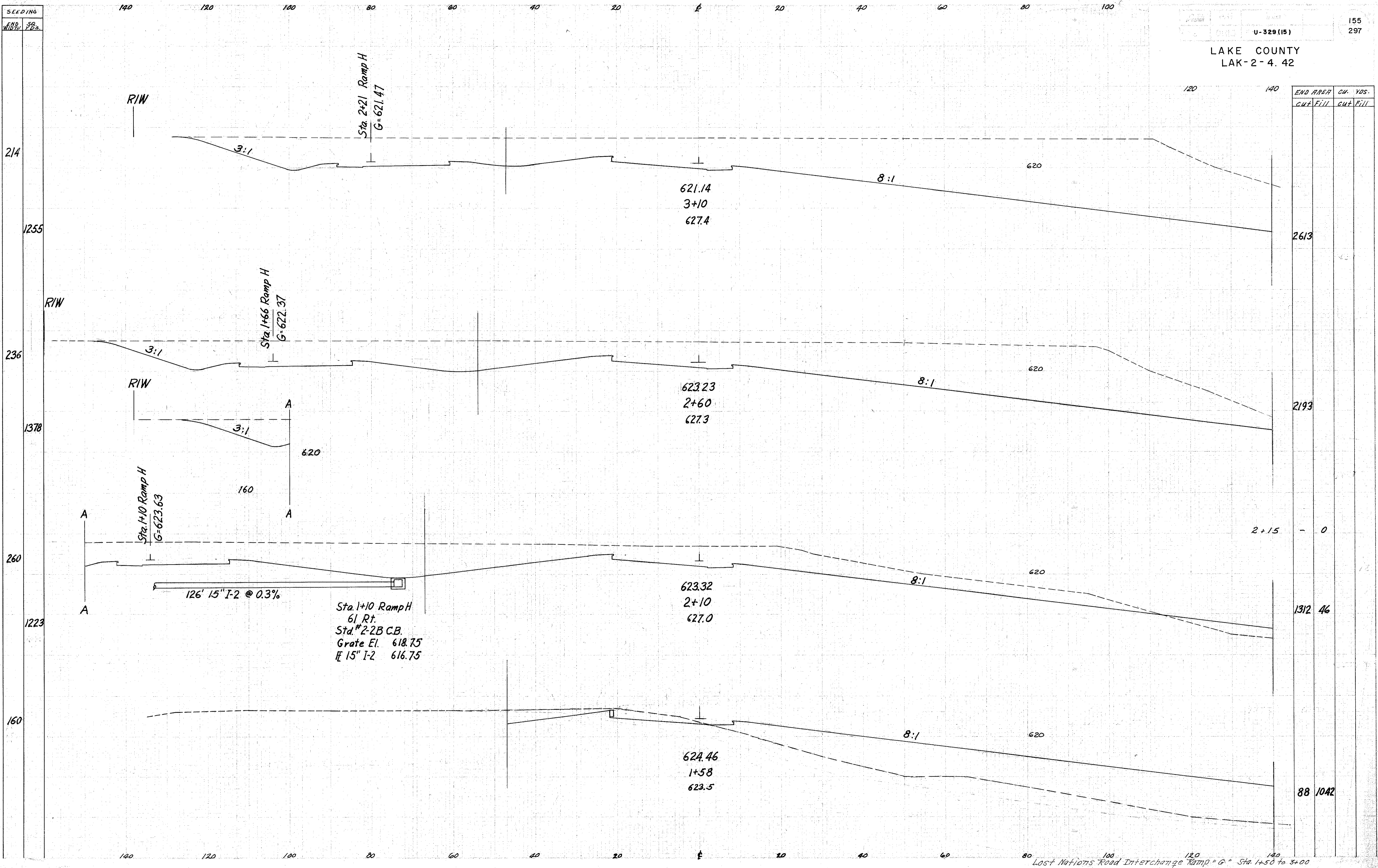

END AREA	CUT	FILL	CUT	FILL
----------	-----	------	-----	------

214				
1255				
236				
1378				
260				
1223				
160				
2613				
2193				
2+15	-	0		
1312	46			
88	1042			

Lost Nations Road Interchange Ramp "G" Sta. 1+50 to 3+00