

LAKE COUNTY  
LAK-2-4.42

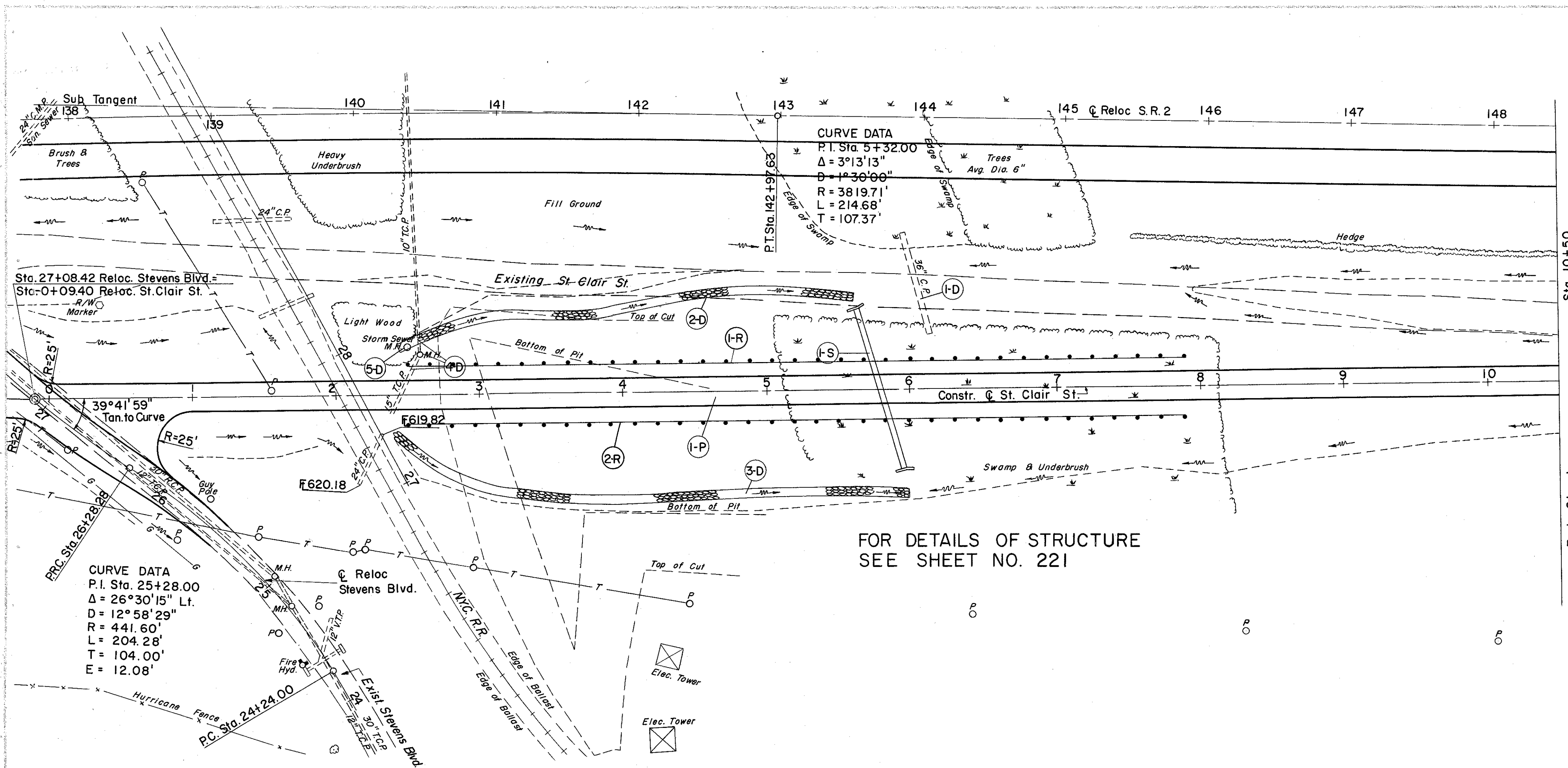

End Sheet  
Sta. 10+50

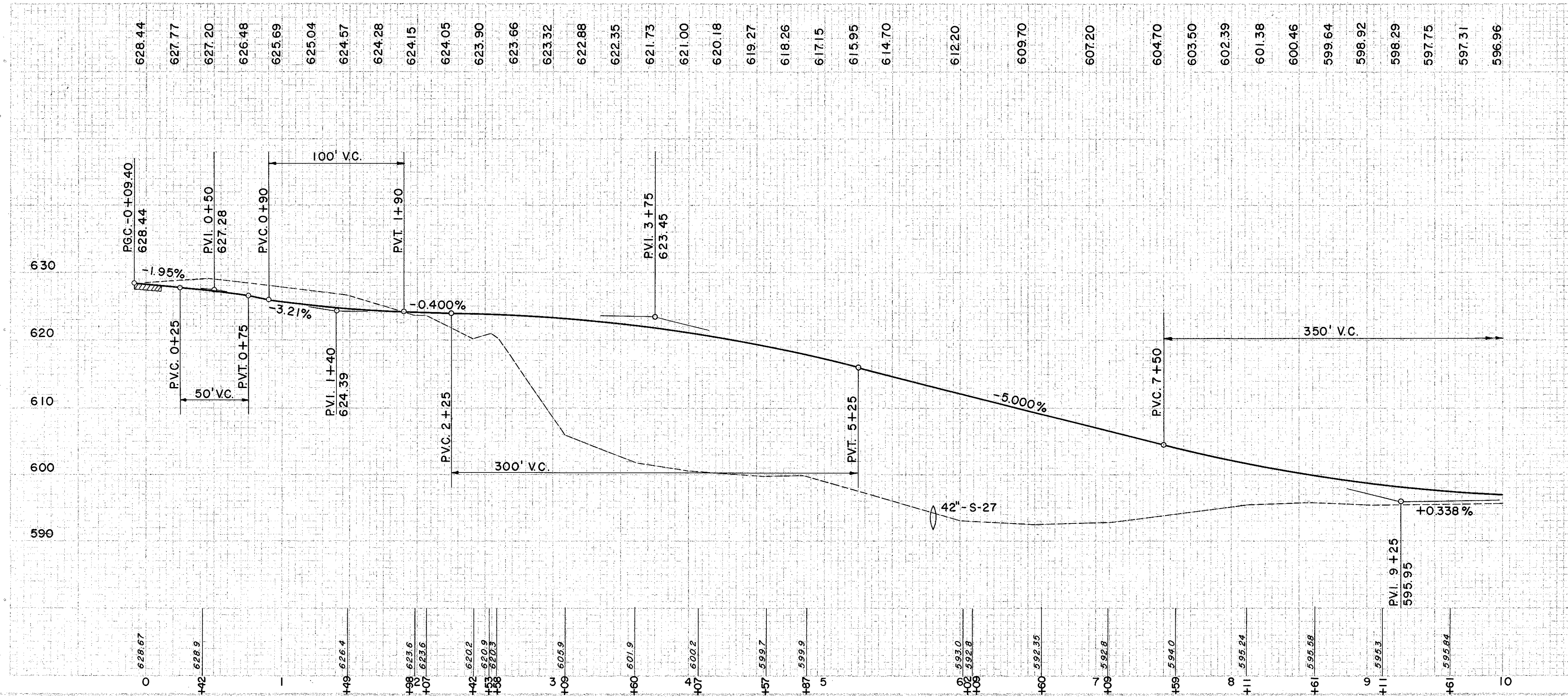

(S) STRUCTURES

REF. STATION NO.	STRUCTURE	QTY	UNIT
I-S 5181.5	EXCAV. CHANNEL FOR EXCAV. STRUCT.	180	C.Y.
	CONC. FOR STRUCT. CL "C"	28.8	C.Y.
	SODDING	8	S.Y.
	REINF. FOR ROWY CULVERT	1,236	LBS.
	42" PIPE FOR ROWY CULVERT	114	L.F.

(R) ROADWAY

REF. STATION NO.	ROADWAY	QTY	UNIT
	EXCAV. CHANNEL FOR EXCAV. STRUCT.	180	C.Y.
	CONC. FOR STRUCT. CL "C"	28.8	C.Y.
	SODDING	8	S.Y.
	REINF. FOR ROWY CULVERT	1,236	LBS.
	42" PIPE FOR ROWY CULVERT	114	L.F.
	GUARD RAIL	544	LT.
	WIRE CABLE TYPE (3 CABLE)	544	RT.
	TOTAL	1088	

(D) DRAINAGE

REF. STATION NO.	DRAINAGE	QTY	UNIT
I-D 6+15	PIPE REMOVAL UNDER 15" L.F.	75	C.Y.
2-D 2+45	PIPE REMOVAL UNDER 15" L.F.	98	C.Y.
3-D 2+45	PIPE REMOVAL UNDER 15" L.F.	179	C.Y.
4-D 2+40	PIPE REMOVAL UNDER 15" L.F.	206	C.Y.
5-D 2+50	PIPE REMOVAL UNDER 15" L.F.	206	C.Y.

(P) PAVEMENT

REF. STATION NO.	PAVEMENT	QTY	UNIT
I-P 10+09	CRUSHED BASE COURSE 15"	340	C.Y.
	CRUSHED SUB-GRADE	2448	S.Y.
	CRUSHED COMPACTED ALUMINUM SUB-CHLORIDE	2448	S.Y.
	TOTAL	1.22	TONS

EXCAVATION	=	3,096 C.Y.
EMBANKMENT	=	19,386 C.Y.
EMBANKMENT 20"	=	23,263 C.Y.