

CURVE DATA
P.I. Sta. 1+84.29
Δ=29°30'00"
D=8°11'06"
R=700.00'
L=360.41'
T=184.29'
E=23.85'

CURVE DATA
P.I. Sta. 3+90.24
Δ=25°11'15"
D=350.00'
L=153.86.00'
T=78.19.9'
E=8.63'

CURVE DATA
P.I. Sta. 2+04.13
Δ=17°48'45"
D=8°11'06"
R=700.00'
L=217.62'
T=109.70'
E=8.54'

LAKE COUNTY
LAK-2-4.42

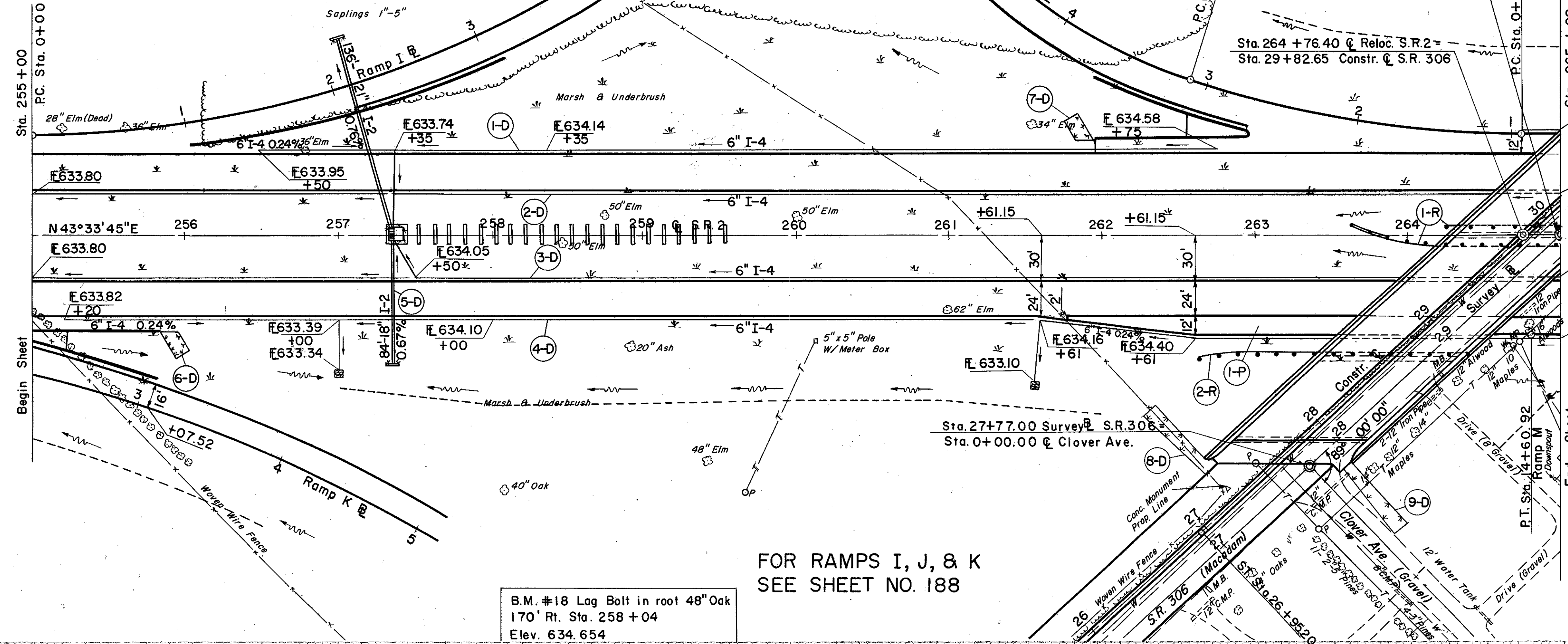

FOR RAMPS I, J, & K
SEE SHEET NO. 188

B.M. #18 Lag Bolt in root 48\"/>

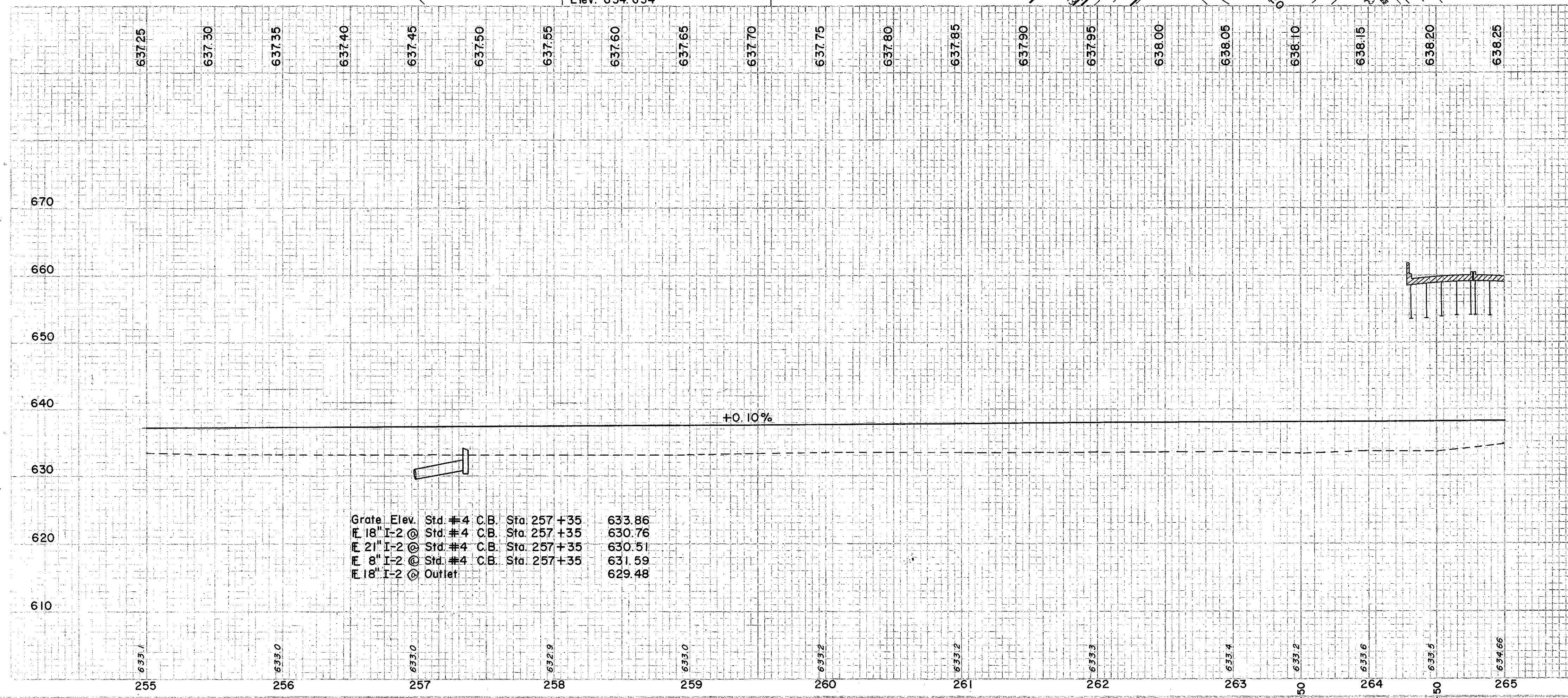

Grate Elev.	Std. #4	C.B. Sta. 257+35	633.86
E 18\"/>			

REF. NO.	STATION	DRAINAGE		ROADWAY		PAVEMENT	
		FROM	TO	FROM	TO	FROM	TO
I-D	255+50	262+75	LT.	6\"/>			

REF. NO.	SIDE	STATION	PAVEMENT	
			FROM	TO
I-P	RT.	261+61.15	264+82.24	361
T-71	CONC.	10\"/>		

REF. NO.	STATION	SIDE		TOTAL
		FROM	TO	
I-R	263+63	265+00	RT.	175.0
2-R	262+62	264+40	RT.	175.0
TOTAL				362.5

EXCAVATION	=	1,201 C.Y.
EMBANKMENT	=	22,661 C.Y.
EMBANKMENT + 20\"/>		

243+48+49
21+58.91
265+06.95

46+39.43
5+85.15
+24.88