

**CONSTRUCTION NOTE:**  
 PROPOSED 4" STEEL GAS LINE TO BE DIRECTIONALLY DRILLED, EXCEPT IN AREAS WITH POSSIBLE EXISTING UTILITY CONFLICTS. CONTRACTOR SHALL VERIFY LOCATION AND DEPTH OF ALL UTILITIES PRIOR TO CONSTRUCTION, HAND DIGGING MAY BE REQUIRED.

SEE SHEET 15 FOR ADDITIONAL NOTES AND DETAILS.

**NOTE TO CONTRACTOR:**  
 CONTRACTOR SHALL LOCATE AND VERIFY DEPTH OF UNDERDRAINS (underdrain depths vary 30" to 50") ALONG LOST NATION ROAD, AND DRAINS GOING INTO CATCH BASINS AND CURB INLETS USING POTHOLE METHOD PRIOR TO DIRECTIONAL DRILLING.  
 ±Sta. 23+00 to ±Sta. 25+50, ±Sta. 33+50 to ±Sta. 38+25, ±Sta. 40+80 to ±Sta. 50+80, ±Sta. 55+40 to ±Sta. 55+92, ±Sta. 57+25 to ±Sta. 59+80 and ±Sta. 61+50 to ±Sta. 69+80 location of underdrains at approximately 50" all others are at approximately 30" contractor to verify] ANY ROAD UNDERDRAINS DISTURBED MUST BE REPLACED, AS PER THE CITY OF WILLOUGHBY SPECIFICATIONS.

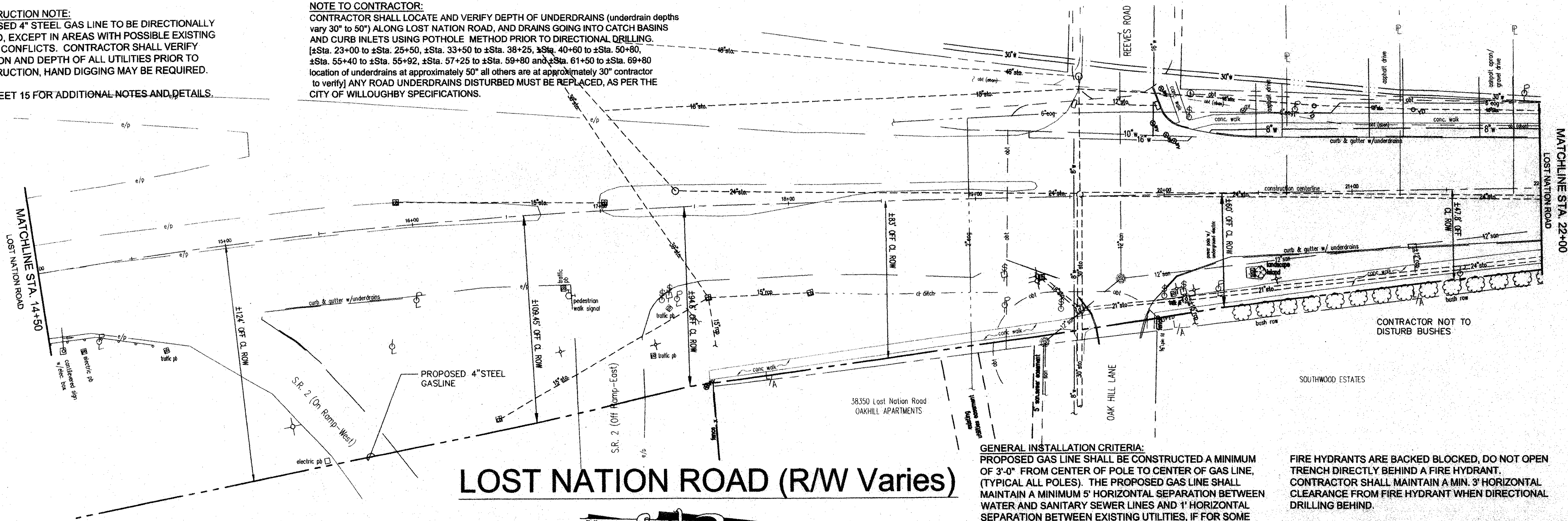

## LOST NATION ROAD (R/W Varies)

**PRE-CONSTRUCTION CONFERENCE:**  
 THE CONTRACTOR/OWNER SHALL CONTACT THE CITY OF WILLOUGHBY ENGINEER, TO SET UP A PRE-CONSTRUCTION MEETING. PRIOR TO ANY WORK STARTING.

**GENERAL INSTALLATION CRITERIA:**  
 PROPOSED GAS LINE SHALL BE CONSTRUCTED A MINIMUM OF 3'-0" FROM CENTER OF POLE TO CENTER OF GAS LINE, (TYPICAL ALL POLES). THE PROPOSED GAS LINE SHALL MAINTAIN A MINIMUM 5' HORIZONTAL SEPARATION BETWEEN WATER AND SANITARY SEWER LINES AND 1' HORIZONTAL SEPARATION BETWEEN EXISTING UTILITIES, IF FOR SOME REASON THIS IS NOT POSSIBLE, THE CONTRACTOR SHALL COORDINATE WITH APPROPRIATE UTILITY COMPANY.

CONTRACTOR SHALL VERIFY LOCATION AND DEPTH OF ALL UTILITIES PRIOR TO CONSTRUCTION

ANY ROAD UNDERDRAINS DISTURBED MUST BE REPLACED, AS PER THE CITY OF WILLOUGHBY SPECIFICATIONS.

FIRE HYDRANTS ARE BACKED BLOCKED, DO NOT OPEN TRENCH DIRECTLY BEHIND A FIRE HYDRANT. CONTRACTOR SHALL MAINTAIN A MIN. 3' HORIZONTAL CLEARANCE FROM FIRE HYDRANT WHEN DIRECTIONAL DRILLING BEHIND.

WATER SERVICE CONNECTIONS TO HOUSES ARE ±3'-4" DEEP. CONTRACTOR IS RESPONSIBLE FOR LOCATING AND AVOIDING. ANY DAMAGE TO SERVICE LATERALS SHALL BE REPAIRED IMMEDIATELY.

NO ROADWAY WILL BE OPEN CUT WITHOUT PERMIT FROM CITY BUILDING DEPARTMENT.

ANY DRIVES OR SIDEWALK DAMAGED SHALL BE REPLACED IN KIND OR AS DIRECTED BY CITY ENGINEER.

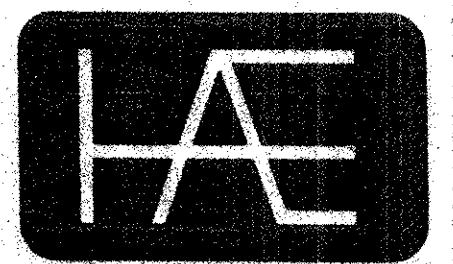
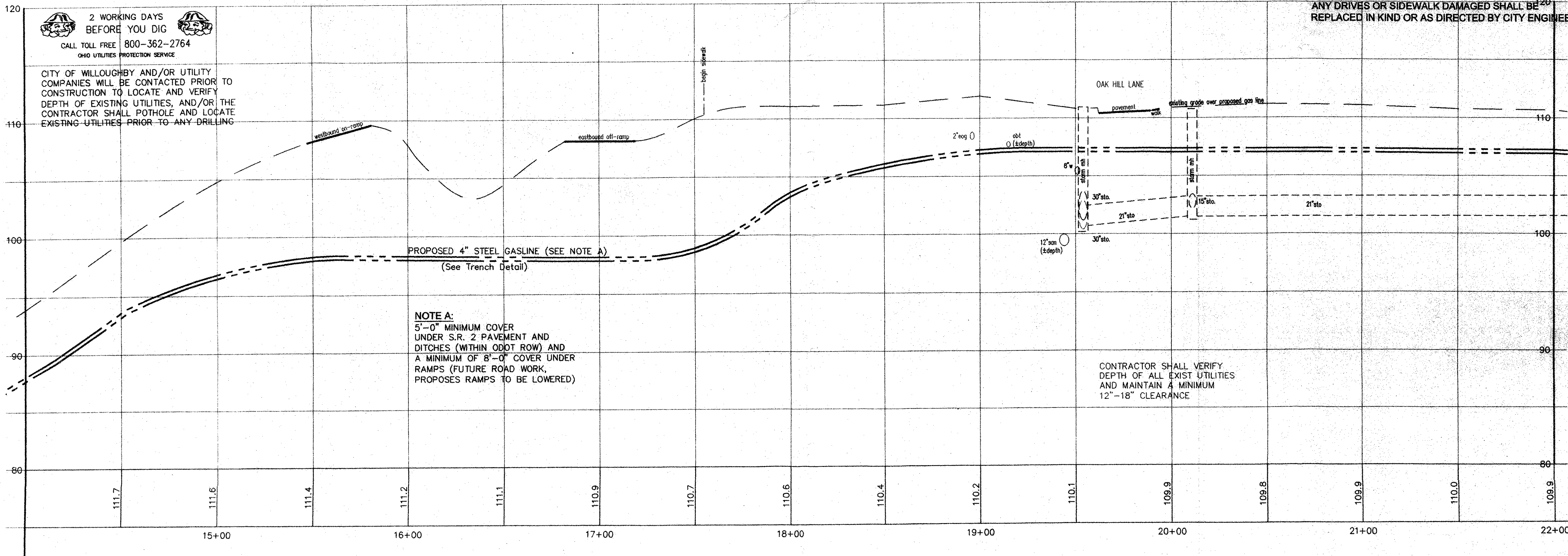

**HESS & ASSOCIATES  
 ENGINEERING INC.**  
 12121 KINSMAN ROAD  
 NEWBURY, OHIO 44065

Telephone: (440) 564-8008  
 Fax: (440) 564-8176

PREPARED UNDER THE SUPERVISION OF:

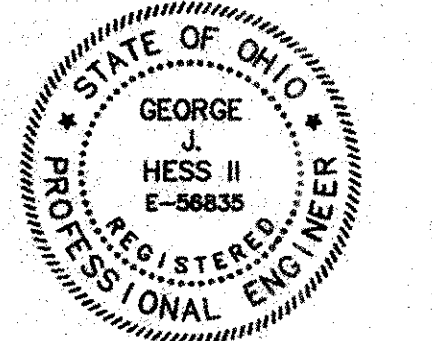

**REVISIONS**

① (03-07-2006) REVISED AS PER CT CONSULTANTS COMMENTS  
 DATED: 02-14-2006

Printed: March 7, 2006

ORWELL NATURAL GAS  
 LOST NATION ROAD DISTRIBUTION LINE

Plan  
 STA. 14+50 Thru STA. 22+00

PROJECT LOCATION:  
 CITY OF WILLOUGHBY, LAKE COUNTY, STATE OF OHIO

Project Name and Address  
**ORWELL NATURAL GAS**  
 8500 STATION STREET  
 SUITE 100  
 MENTOR, OHIO 44060

Telephone: (440) 205-4600  
 Fax: (440) 974-5114

Contact Person:  
 Mr. Ottar Magnusson  
 Mobile # (440) 669-6700

HESS Project: LOST NATION ROAD

DESIGNED BY: JED  
 DRAWN BY: JED/SSD  
 CHECKED BY: GJH  
 DATE: 01/2006  
 SCALE: 1"=30' H.  
 1"=5' V. 4 of 15