



HESS & ASSOCIATES
ENGINEERING INC.

12121 KINSMAN ROAD
NEWBURY, OHIO 44065

Telephone: (440) 564-8008
Fax: (440) 564-8176

PREPARED UNDER THE
SUPERVISION OF:



REVISIONS

PRINTED: JUNE 24, 2005

ORWELL NATURAL GAS
LOST NATION ROAD DISTRIBUTION LINE

Plan
STA. 116+50 Thru STA. 124+50

PROJECT LOCATION:
CITY OF WILLOUGHBY, LAKE COUNTY, STATE OF OHIO

Project Name and Address

ORWELL NATURAL GAS
8500 STATION STREET
SUITE 100
MENTOR, OHIO 44060

Telephone: (440) 205-4600
Fax: (440) 974-5114

Contact Person:
Mr. Ottar Magnusson
Mobile # (440) 669-6700

HESS Project: LOST NATION ROAD

DESIGNED BY: JED
DRAWN BY: JED/SSD
CHECKED BY: G.J.H.
DATE: 06/2005
SCALE: 1"=30' H.
1"=5' V.

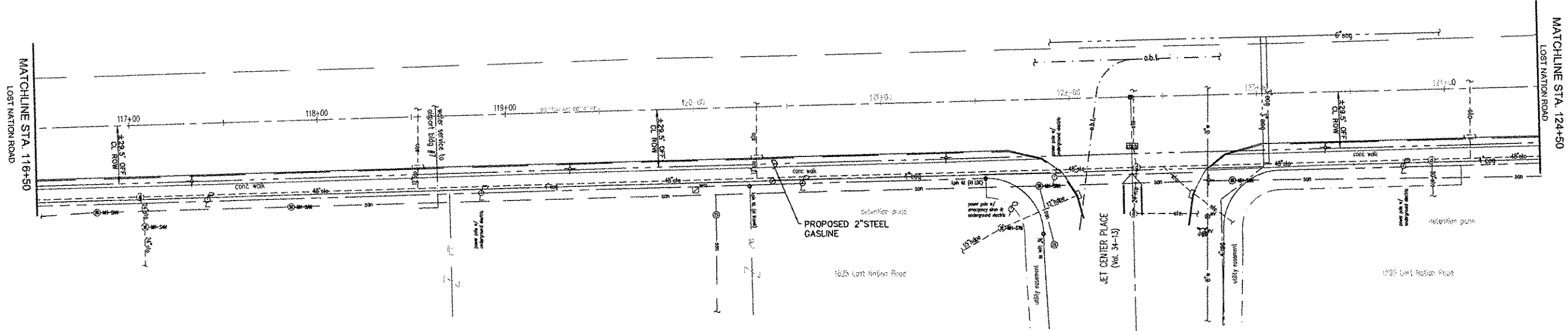

LOST NATION ROAD (80' R/W)



CONSTRUCTION NOTE:
PROPOSED 2" STEEL GAS LINE TO BE DIRECTIONALLY
DRILLED, EXCEPT IN AREAS WITH POSSIBLE EXISTING
UTILITY CONFLICTS. CONTRACTOR SHALL VERIFY
LOCATION AND DEPTH OF ALL UTILITIES PRIOR TO
CONSTRUCTION.

NO ROADWAY WILL BE OPEN CUT WITHOUT PERMIT
FROM CITY BUILDING DEPARTMENT.
ANY DRIVES OR SIDEWALK DAMAGED SHALL BE
REPLACED IN KIND OR AS DIRECTED BY CITY ENGINEER.

SEE SHEET 20 AND 22 FOR NOTES AND DETAILS.

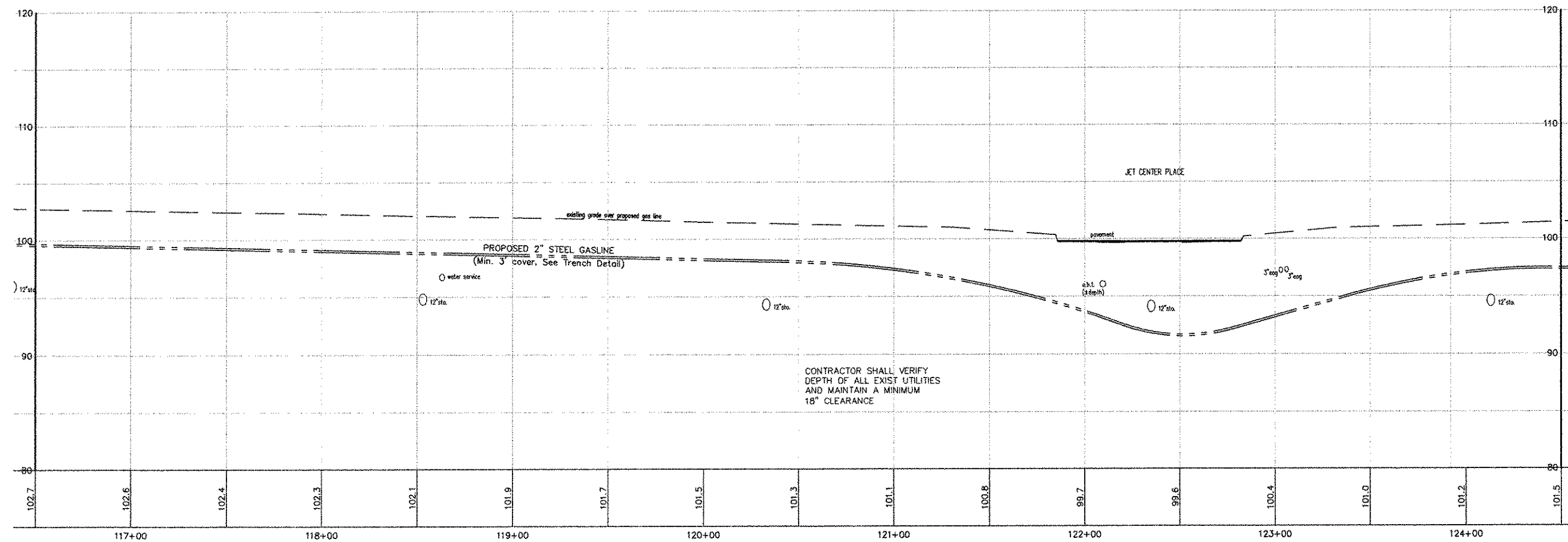
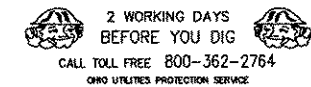

CONTRACTOR SHALL VERIFY
DEPTH OF ALL EXIST UTILITIES
AND MAINTAIN A MINIMUM
18" CLEARANCE