

F:\Land Projects\Orwell Natural Gas\Lost Nation Road\dwg\plan.dwg 6/25/2005 1:20:21 PM EST

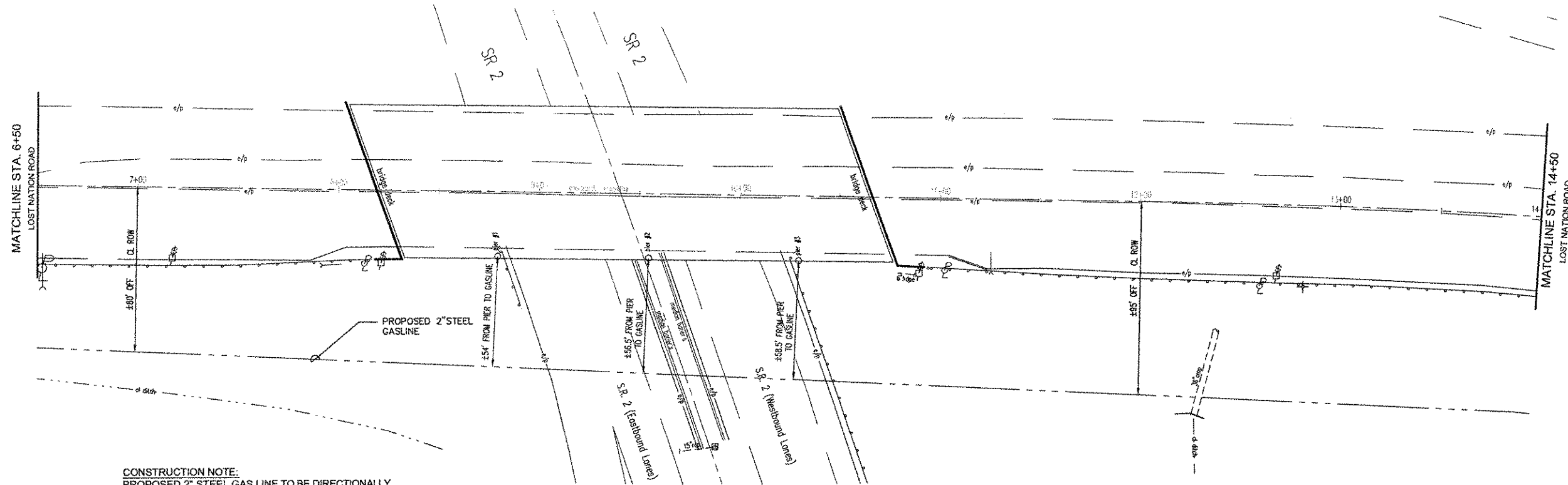

LOST NATION ROAD (R/W Varies)

CONSTRUCTION NOTE:
 PROPOSED 2" STEEL GAS LINE TO BE DIRECTIONALLY DRILLED, EXCEPT IN AREAS WITH POSSIBLE EXISTING UTILITY CONFLICTS. CONTRACTOR SHALL VERIFY LOCATION AND DEPTH OF ALL UTILITIES PRIOR TO CONSTRUCTION.

NO ROADWAY WILL BE OPEN CUT WITHOUT PERMIT FROM CITY BUILDING DEPARTMENT. ANY DRIVES OR SIDEWALK DAMAGED SHALL BE REPLACED IN KIND OR AS DIRECTED BY CITY ENGINEER.

SEE SHEET 20 AND 22 FOR NOTES AND DETAILS.

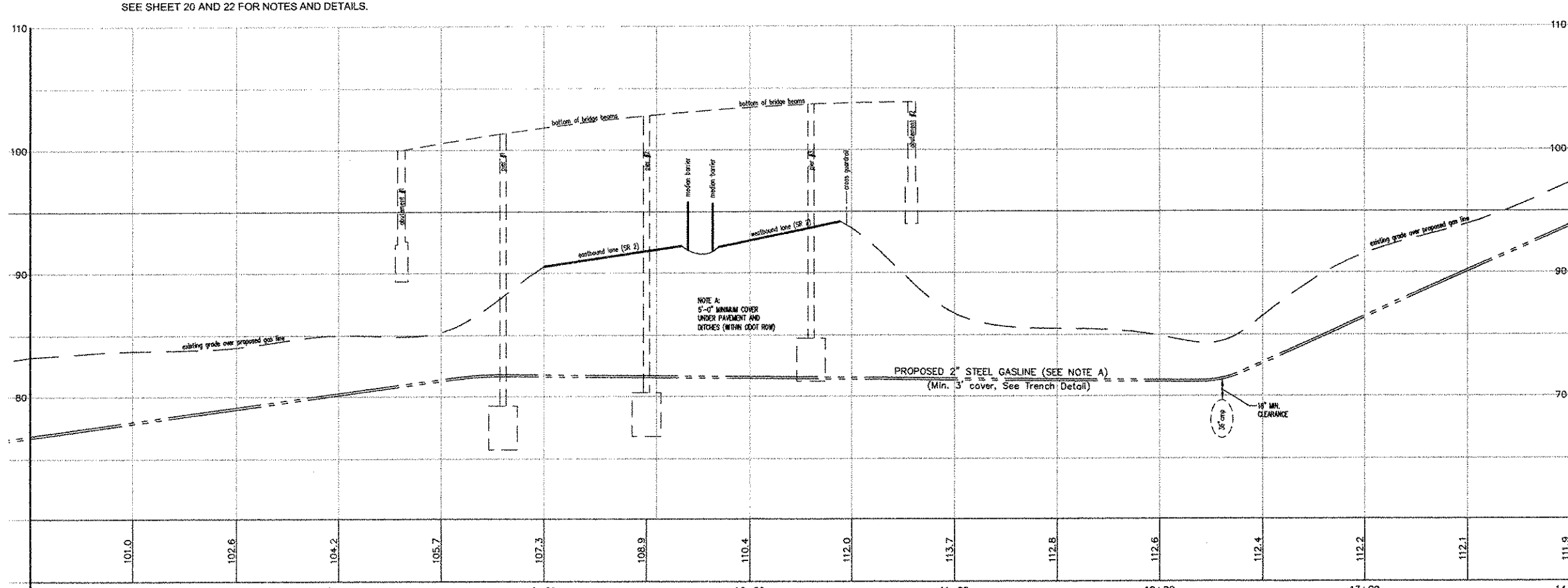
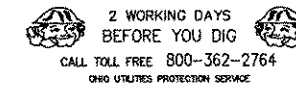

HESS & ASSOCIATES ENGINEERING INC.
 12121 KINSMAN ROAD
 NEWBURY, OHIO 44065
 Telephone: (440) 564-8008
 Fax: (440) 564-8176

PREPARED UNDER THE SUPERVISION OF:



REVISIONS

PRINTED: JUNE 24, 2005

ORWELL NATURAL GAS
 LOST NATION ROAD DISTRIBUTION LINE
 Plan
 STA. 6+50 Thru STA. 14+50
 PROJECT LOCATION:
 CITY OF WILLOUGHBY, LAKE COUNTY, STATE OF OHIO

Project Name and Address
ORWELL NATURAL GAS
 8500 STATION STREET
 SUITE 100
 MENTOR, OHIO 44060
 Telephone: (440) 205-4600
 Fax: (440) 974-5114

Contact Person:
 Mr. Ottar Magnusson
 Mobile # (440) 669-6700

HESS Project: LOST NATION ROAD
 DESIGNED BY: JED
 DRAWN BY: JED/SSD
 CHECKED BY: GJH
 DATE: 06/20/05
 SCALE: 1"=30' H.
 1"=50' V.
 3 of 22