

THE C.E.I. CO. PROJECT NO. 11556912 DATE 6/5/08 SHEET 4 OF 4 GRID # 3336

2 WORKING DAYS BEFORE YOU DIG "IT'S THE LAW" OHIO UTILITIES PROTECTION SERVICE

STATE OF OHIO
S.R. 2 VINE ST
WILLOUGHBY
SHIFT FOR ROAD IMP.
L-4-MB-L 13.2KV

ORDER # 12310282
WBS-CN-000795

FLAGMEN NEEDED
FREEWAY CROSSING

STATE OF OHIO
LAK 2-332
PID 13486
SALE DATE 12/08
CONST. START SPRING '09

DATE	DESCRIPTION	APPROVED BY

DATE	DESCRIPTION	APPROVED BY

DATE	DESCRIPTION	APPROVED BY

UNITS OF WORK COMPLETED

ITEMS	INSTALLED	REMOVED	SHIFTED
POLES			
WIRES			
ANCHORS			

UNDERGROUND FACILITIES WARNING

HIGH PRESSURE PIPELINE	AT SYMBOL	CHECKED BY

O.H. TRANSMISSION CLEARANCE WARNING

AT SYMBOLS	FT. MIN. CLEARANCE REQUIRED AT	DEGREES F.

MAXIMUM RMS SYMMETRICAL FAULT CURRENT AVAILABLE AT SERVICE ENTRANCE IS

THE CUSTOMER SHALL PROVIDE THE GROUNDING ELECTRODE CONDUCTOR AND GROUNDING ELECTRODE TO THE SERVICE ENTRANCE LOCATION.

- BETWEEN (12) & (20)
- REMOVE - 1-3" 6ALW STATIC WIRE (803')
 - REMOVE - 6" 1/2 OCU 36KV WIRE (803' EA)
 - INSTALL - 1-3" 6ALW STATIC WIRE (800')
 - INSTALL - 6-477 KCMIL ACSR 36KV WIRE (300' EA)
 - REMOVE - 3-636 KCMIL PRI (639' EA)
 - REMOVE - 1-336.4 KCMIL NEUT. (639')
 - INSTALL - 3-636 KCMIL BA. PRI. (637' EA)
 - INSTALL - 1-336.4 KCMIL BA. NEUT. (637')
 - TRANS - 3-636 KCMIL PRI + 1-336.4 NEUT.
 - TRANS - 6" 1/2 OCU 36KV WIRE
 - TRANS - 3-636 KCMIL PRI + 1-336.4 NEUT.
 - INSTALL - 3-3/8" HT. TIE GUYS (224' EA) (4,000' MOT)
- (16) P#528628 (NEW DBF=3°)
REM-60' FULL 2006
SET-70' (61' NORTH)
STA 129+97, 191' LT (VINE ST)
REM-P.T. STATIC, JI-15
" - 17-335
" - 10' X 3-636 KCMIL PRI'S
" - R6-1
INST-P.T. STATIC, JI-15
" - GROUND
" - 17-335 (4' GAINS)
BOT. INSUL. @ 42'
" - 477 KCMIL LINE GUARDS
" - 477 KCMIL CLAMPS
INST-10' X 6 PIN + INSUL @ 41'
" - R6-1 (NEUT) @ 35'
INST-2-3/8" ANC GUYS
" - 12" EXP. ANCHOR 20' LD. WEST
FE FIBER TO ATT. @ 31'
NO CATV
NO TEL
- (17) P#528629
REM-55' FULL 75
SET-75' (63' N, 10' E)
STA 318+30, 61' LT (RAMP 'A')
SET POLE 1 1/2' DEEP
CUTTING GRADE 2'
REM-10' X BAY X, JI-15
" - 17-331 DX
" - 10' X 3-636 KCMIL PRI'S
" - R6-1
" - 2- HT. ANC GUYS
" - 1- 015T. ANC. GUY
" - ANCHOR 30' LD. N.
INST-P.T. STATIC, JI-15
" - 17-335 (4' GAINS)
BOT. INSUL. @ 49.5' (51.5' FINAL GRADE)
INST-6-477 KCMIL LINE GUARDS
" - 6-477 KCMIL CLAMPS
" - 10' X 3 PIN + INSUL. @ 43.5'
(TO BE @ 45.5' FINAL GRADE)
INST-R6-1 @ 37.5' (39.5' FINAL GRADE)
FE FIBER TO ATT. @ 33.5'
TO BE @ 35.5' FINAL GRADE
NO CATV
NO TEL

SAG NOTE FOR NEW CONDUCTORS

SAG-477 KCMIL ACSR 36KV WIRES PER 4-605
2,600' MOT, 180' SPAN SAG 29' @ 30', 37' @ 70', 54' @ 200'

SAG-636 KCMIL BA 13.2KV WIRES PER 4-606
2,800' MOT, 180' SPAN SAG 29' @ 30', 37' @ 70', 59' @ 200'

SAG-336.4 KCMIL BA. NEUTRAL PER 4-604
2,000' MOT, 179' SPAN SAG 22' @ 30', 37' @ 70', 77' @ 200'

- (18) P#528630
REM-60' FULL 75
SET-70' (41' N, 5' E)
STA 319+78, 49' LT (RAMP 'A')
SET POLE 12' DEEP
CUTTING GRADE 3'
REM-10' BAY X, JI-15
" - GROUND
" - 17-330 SX
" - 10' X 3-636 KCMIL PRI.
" - R6-1
INST-P.T. BRKT, JI-15
" - GROUND
" - 17-335 (4' GAINS)
BOT. INSUL. @ 44' (TO BE @ 47' FINAL GRADE)
INST-6-477 KCMIL LINE GUARDS
" - 6-477 KCMIL CLAMPS
" - 10' X 3 PIN + INSUL @ 38'
(TO BE @ 41' FINAL GRADE)
INST-R6-1 @ 32'
(TO BE @ 35' FINAL GRADE)
FE FIBER TO ATT. @ 28'
(TO BE @ 31' FINAL GRADE)
NO CATV
NO TEL
- (19) P#528631
REM-60' FULL 75
SET-70' (47' N, 3' E.) (GRADE OK)
STA 321+37, 30' RT (RAMP 'A')
REM-10' BAY X, JI-15
" - 17-330 SX
" - 10' X 3-636 PRI'S
" - R6-1
INST-P.T. BRKT, JI-15
" - 17-335 (4' GAINS)
BOT. INSUL. @ 47'
INST-6-477 KCMIL LINE GUARDS
" - 6-477 KCMIL CLAMPS
" - 10' X 3 PIN + INSUL @ 41'
" - R6-1 @ 35'
FE FIBER TO ATT. @ 31'
NO CATV
NO TEL

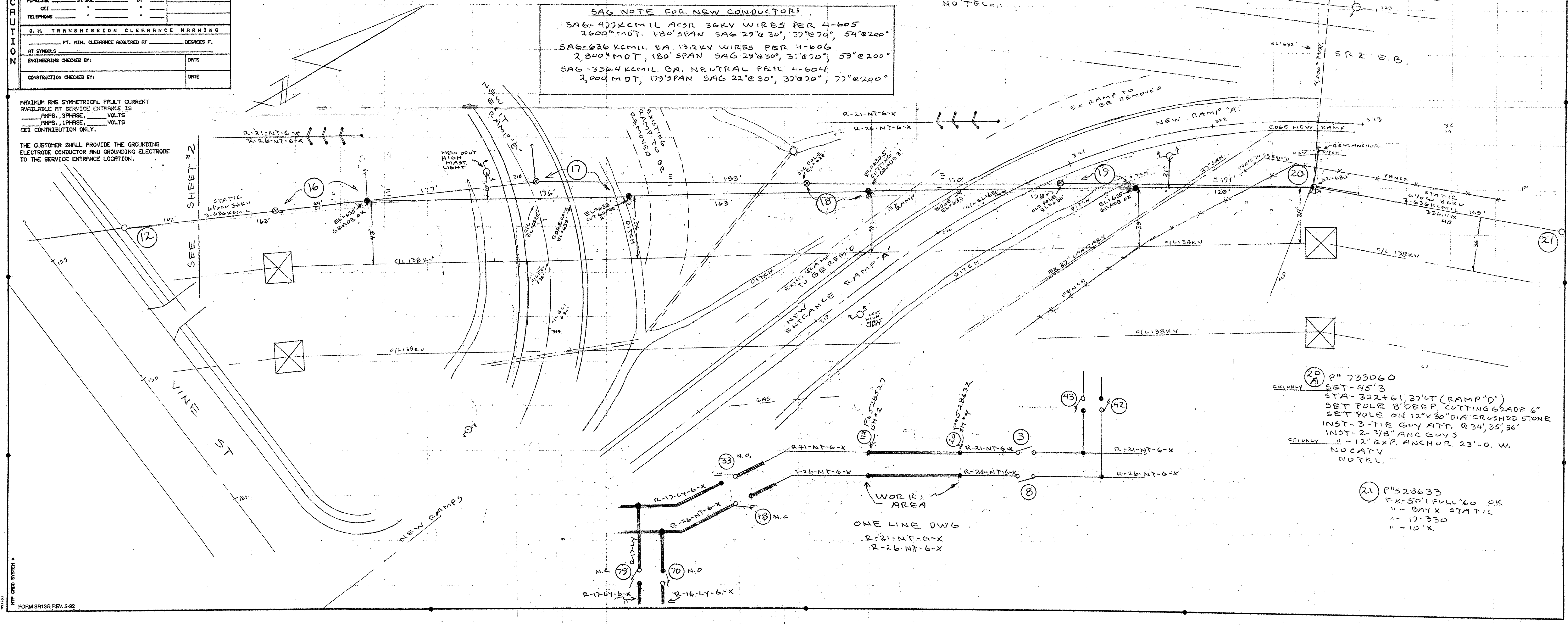
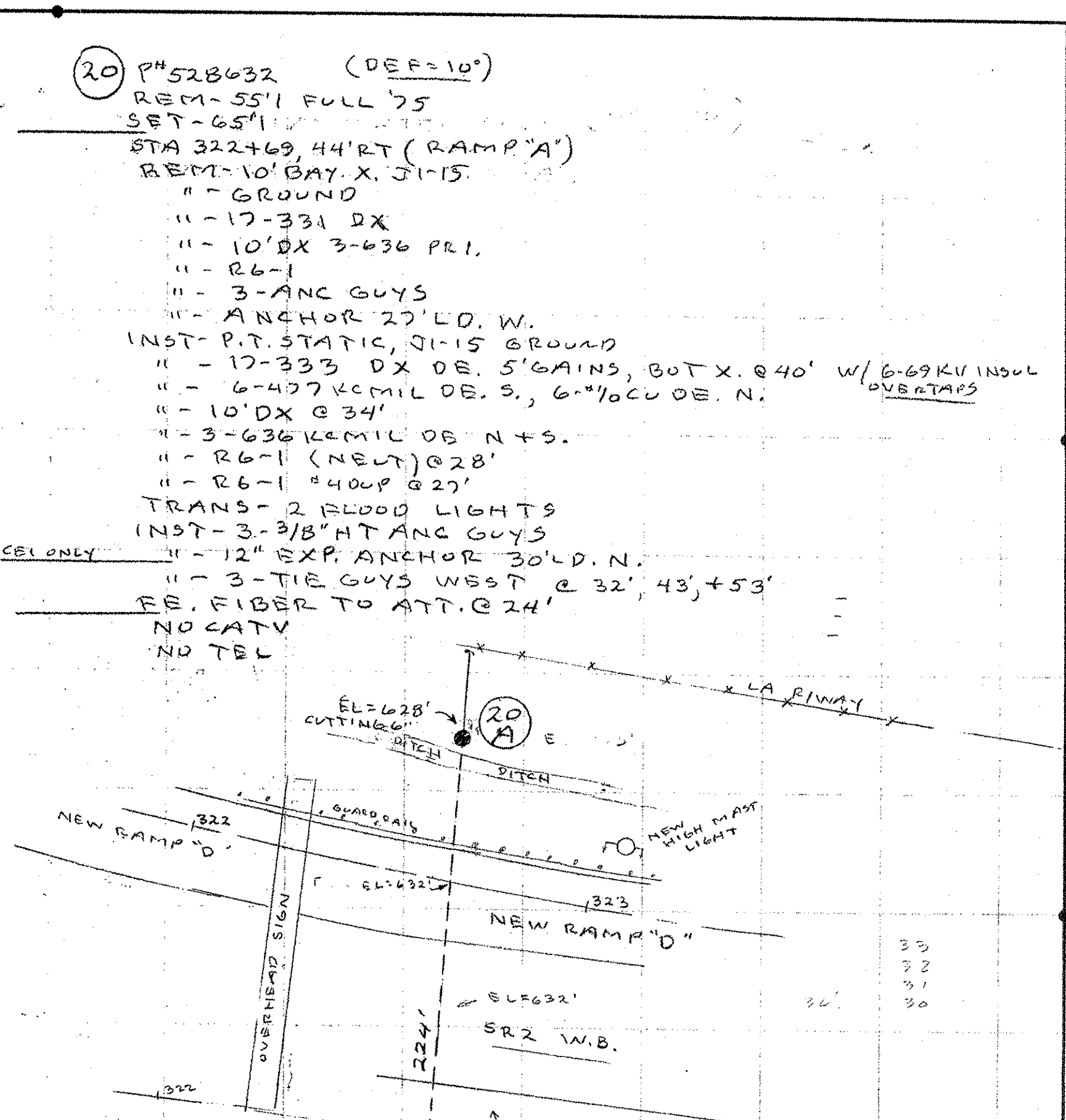

- (20) P#733060
SET-45' 3
STA-322+61, 37' LT (RAMP 'D')
SET POLE 8' DEEP CUTTING GRADE 6"
SET POLE ON 12" X 30" DIA CRUSHED STONE
INST-3-TIE GUY ATT. @ 34', 35', 36'
INST-2-3/8" ANC GUYS
" - 12" EXP. ANCHOR 23' LD. W.
NO CATV
NO TEL
- (21) P#528633
EX-50' FULL 60 OK
" - BAY X STATIC
" - 17-330
" - 10' X