

G:\Project\CV000048A001\Drawing\LAK\13486\bridge\LAK002\_0542CMD002.dgn 6/26/2008 3:33:33 PM jrufener

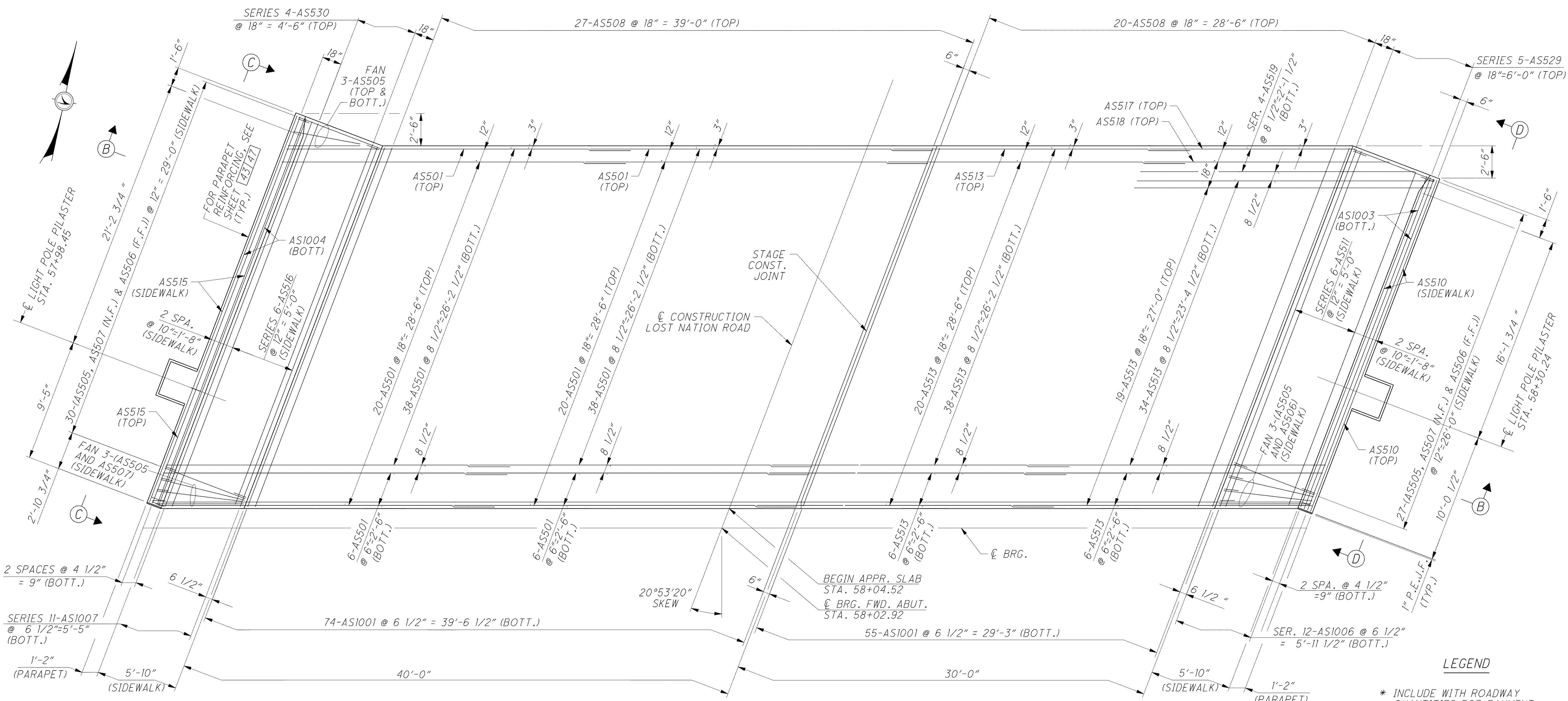

FORWARD APPROACH SLAB PLAN

- LEGEND**
- \* INCLUDE WITH ROADWAY QUANTITIES FOR PAYMENT
  - § INCLUDE WITH LIGHTING QUANTITIES FOR PAYMENT
  - §§ INCLUDE WITH TRAFFIC QUANTITIES FOR PAYMENT

**NOTES**

1. FOR ADDITIONAL NOTES AND DETAILS, SEE SHEETS 41/47 AND 43/47.
2. FOR LIST OF ABBREVIATIONS, SEE SHEET 3/47.
3. MINIMUM BAR LAPS:
  - #4 BARS = 31"
  - #5 BARS = 42"
  - #6 BARS = 46"
  - #8 BARS = 87"

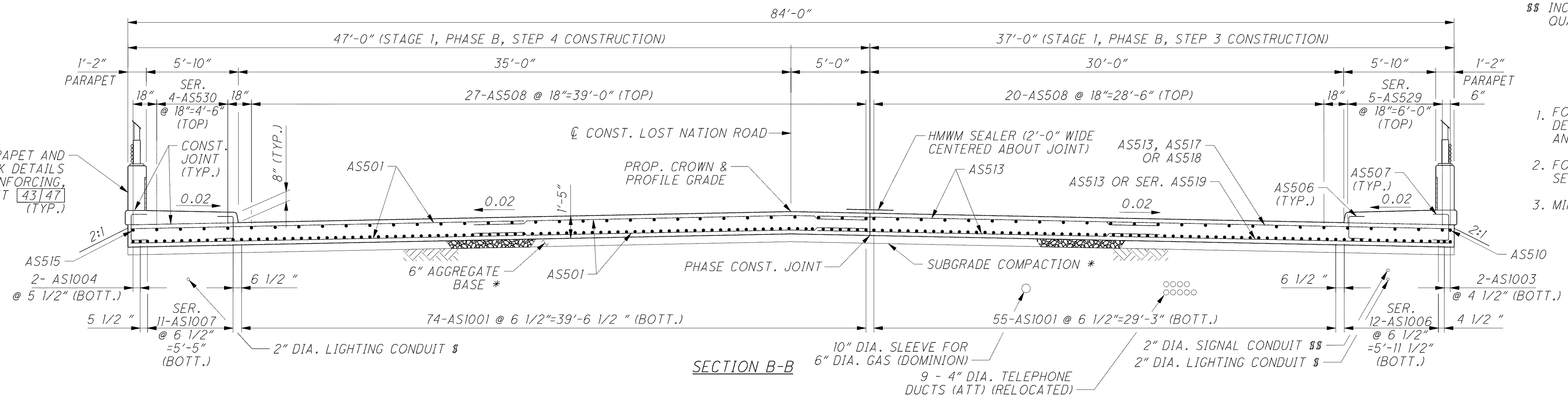

SECTION B-B

**ARCADIS**  
 ARCADIS U.S., Inc.  
 100 Superior Avenue, Suite 1250 Cleveland, Ohio 44114  
 Tel: 216-781-6177 Fax: 216-781-6243 www.arcadis-us.com

DESIGNED	RBB	CHECKED	SKS
DRAWN	MPB	REVISED	
REVIEWED	CMD	DATE	4/07
STRUCTURE FILE NUMBER			4500823

**FORWARD APPROACH SLAB PLAN AND SECTION**  
 BRIDGE NO. LAK-2-0542  
 LOST NATION ROAD OVER STATE ROUTE 2

**LAK-2-3.32**  
**PID 13486**

42 / 47

1588  
1679