

o:\project\cv000048a001\drawing\lak\13486\bridge\002_0542c\002_0542c\002_0542c.dgn 6/24/2008 4:57:52 PM troxberry

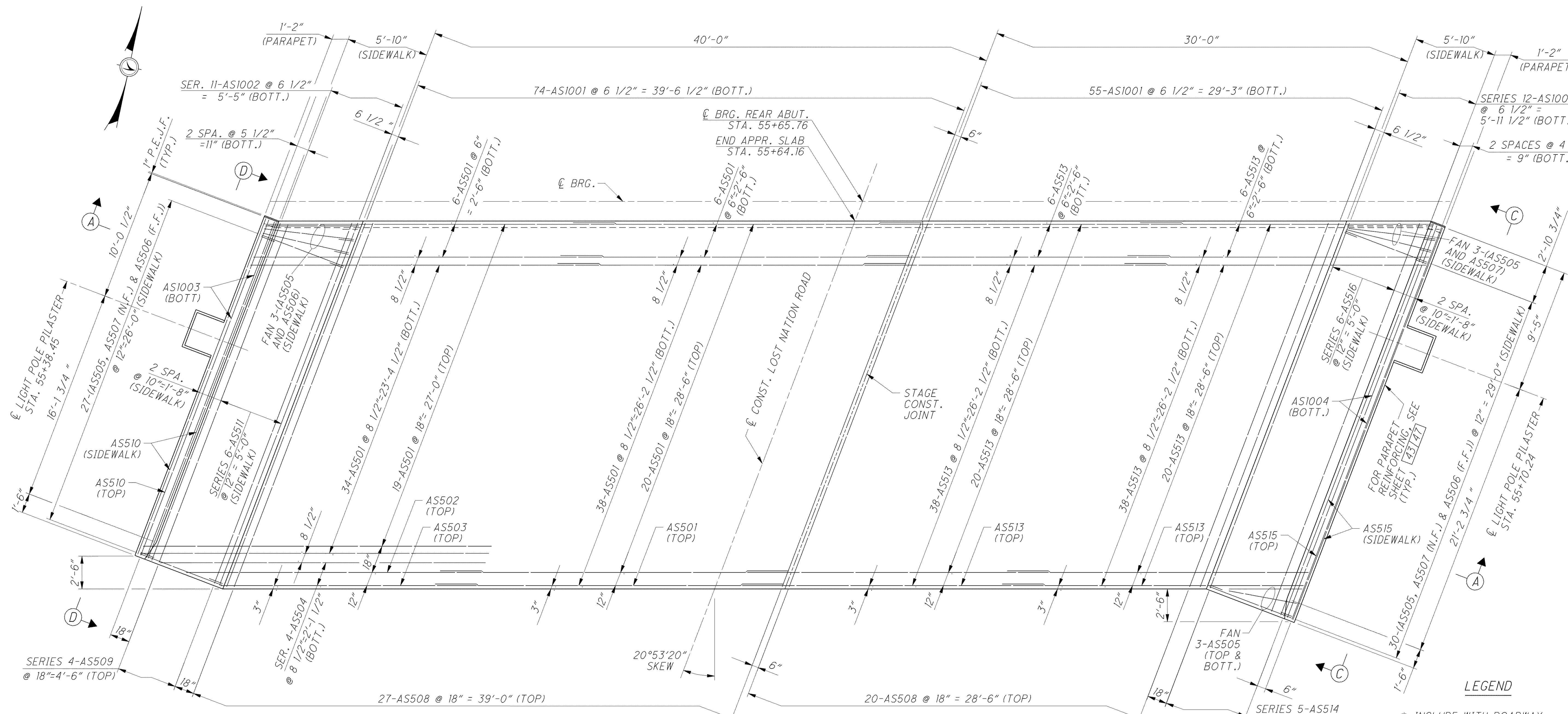

REAR APPROACH SLAB PLAN

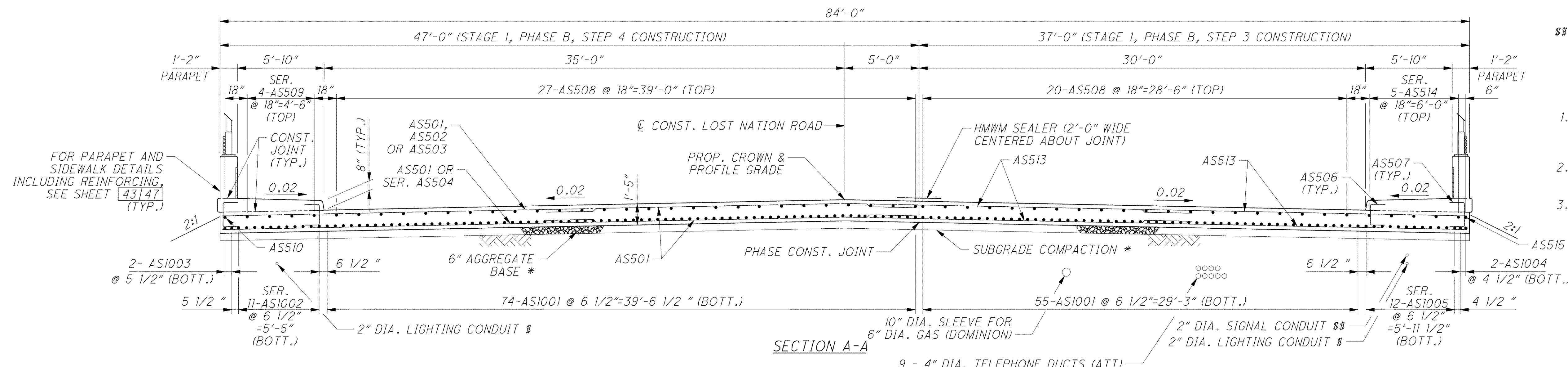

SECTION A-A

LEGEND

- * INCLUDE WITH ROADWAY QUANTITIES FOR PAYMENT
- § INCLUDE WITH LIGHTING QUANTITIES FOR PAYMENT
- §§ INCLUDE WITH TRAFFIC QUANTITIES FOR PAYMENT

NOTES

1. FOR ADDITIONAL NOTES AND DETAILS, SEE SHEETS [42|47] AND [43|47].
2. FOR LIST OF ABBREVIATIONS SEE SHEET [3|47].
3. MINIMUM BAR LAPS:
 - #4 BARS = 31"
 - #5 BARS = 42"
 - #6 BARS = 46"
 - #8 BARS = 87"

<p>ARCADIS U.S.A., INC. 1900 Superior Avenue, Suite 1250 Cleveland, Ohio 44114 Tel: 216-781-6177 Fax: 216-781-6243 www.arcadis-us.com</p>	<p>DESIGN AGENCY</p>	<p>DATE</p> <p>4/07</p>	<p>REVIEWED</p> <p>CMD</p>	<p>STRUCTURE FILE NUMBER</p> <p>4300823</p>
<p>DRAWN</p> <p>MPB</p>	<p>DESIGNED</p> <p>RBB</p>	<p>CHECKED</p> <p>SKS</p>	<p>REVISED</p>	<p>4300823</p>
<p>REAR APPROACH SLAB PLAN AND SECTION</p> <p>BRIDGE NO. LAK-2-0542</p> <p>LOST NATION ROAD OVER STATE ROUTE 2</p>				
<p>LAK-2-3.32</p> <p>PID 13486</p>				
<p>41 / 47</p>				
<p>1587</p> <p>1679</p>				