

C:\Project\CV000048A001\Drawing\LAK\13486\bridge\LAK002_0542C\sheets\002_0542CMD004.dgn 6/26/2008 3:27:35 PM jrufener

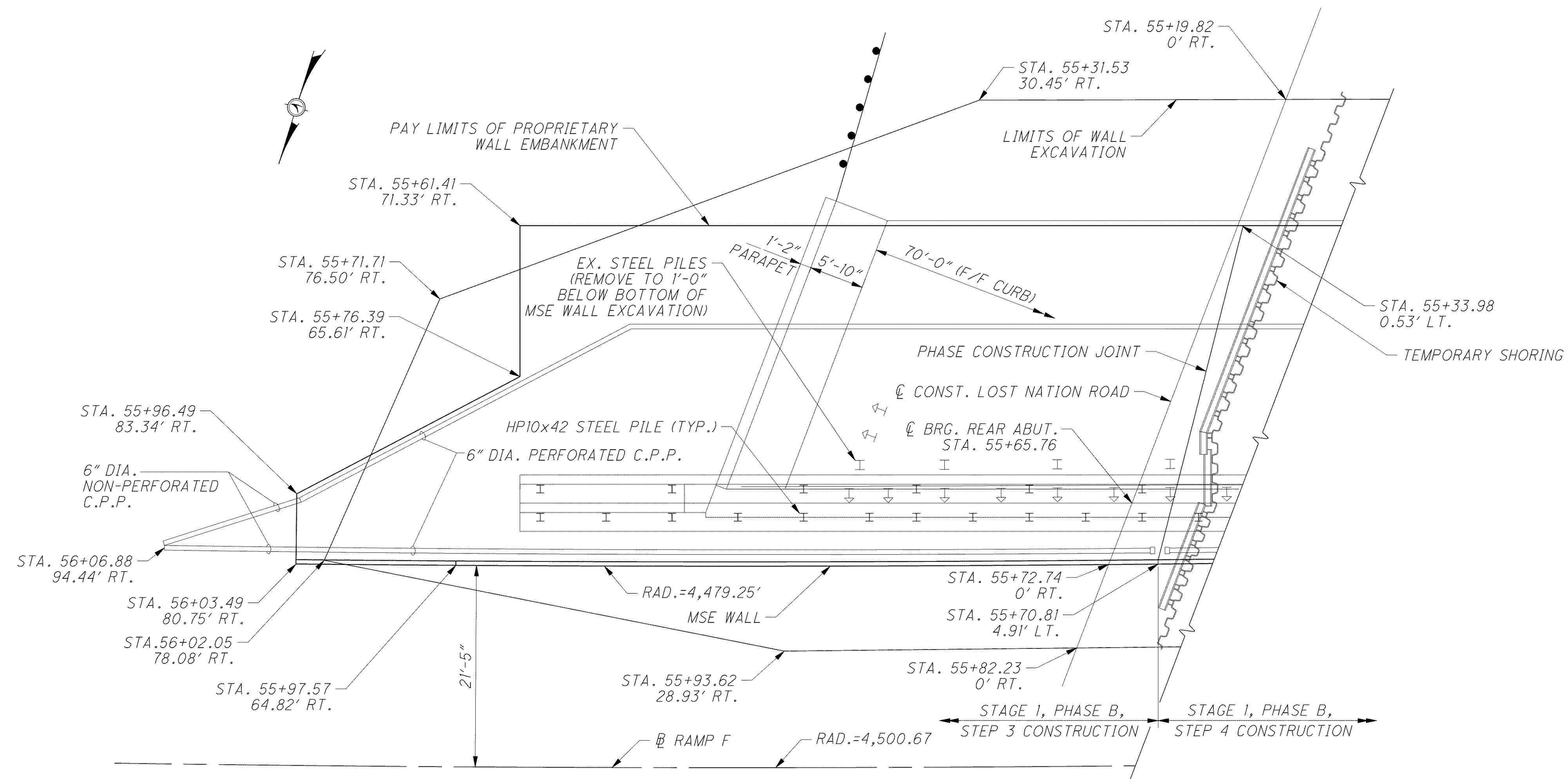

PLAN

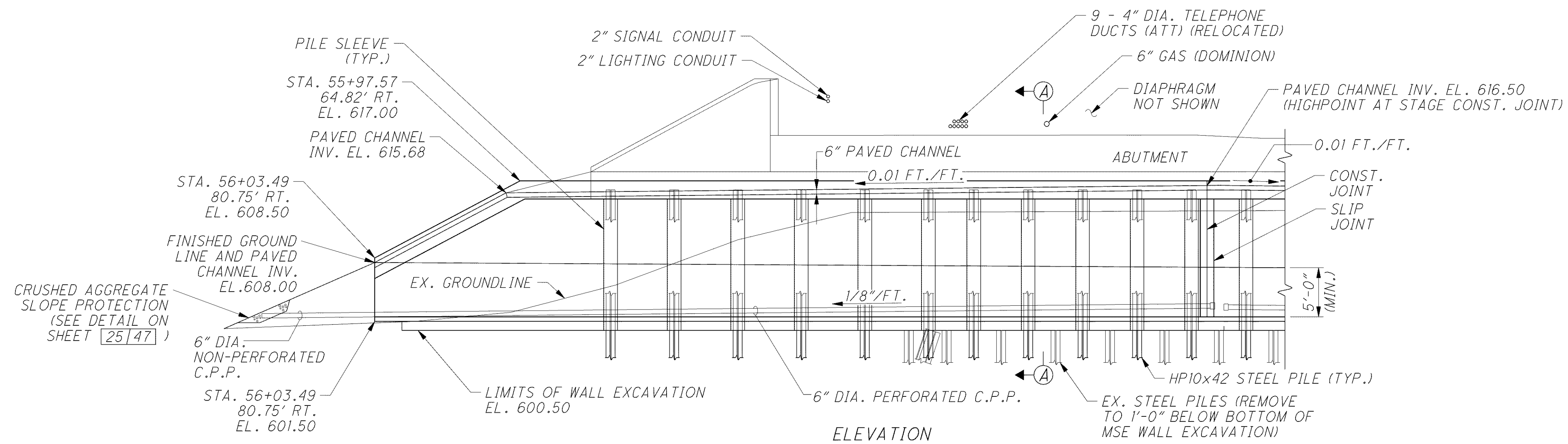

ELEVATION

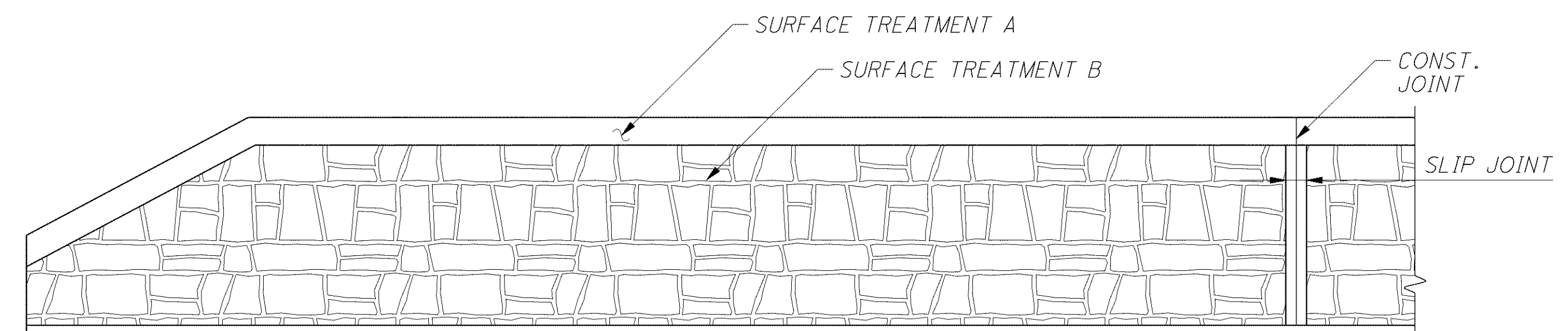

MSE WALL AESTHETIC TREATMENT

NOTES

1. FOR TEMPORARY SHORING DETAILS SEE SHEETS [9/47] THRU [12/47].
2. FOR REAR ABUTMENT DETAILS SEE SHEETS [21/47], [22/47] AND [25/47].
3. FOR ADDITIONAL MSE WALL DETAILS SEE SHEETS [16/47] AND [19/47].
4. FOR A LIST OF ABBREVIATIONS, SEE SHEET [3/47].
5. FOR DESCRIPTION OF SURFACE TREATMENTS A AND B, SEE SHEET [40/47].

 <small>DESIGN AGENCY</small> ARCADIS U.S., Inc. <small>1100 Superior Avenue, Suite 1250 Cleveland, Ohio 44114 Tel: 216-781-6177 Fax: 216-781-6243 www.arcadis-us.com</small>		<small>DATE</small> 4/07
<small>REVIEWED</small> CMD	<small>STRUCTURE FILE NUMBER</small> 4500823	
<small>DRAWN</small> MPB	<small>REVISED</small> SKS	
MSE WALL DETAILS - REAR ABUTMENT BRIDGE NO. LAK-2-0542 LOST NATION ROAD OVER STATE ROUTE 2		
LAK-2-3.32 PID 13486		
15 / 47		
<div style="border: 1px solid black; border-radius: 50%; width: 30px; height: 30px; display: flex; align-items: center; justify-content: center; margin: 0 auto;"> 1561 1679 </div>		