

NOTES:

1. ALL DIMENSIONS ARE PERPENDICULAR TO THE CL , UNLESS NOTED OTHERWISE.
2. ALL VARIABLE DIMENSIONS ARE MEASURED AT THE BRIDGE LIMITS, UNLESS NOTED OTHERWISE.
3. TYPICAL REINFORCEMENT FOR 7'-6" BEAM SPACING. (U.N.O.)
4. TYPICAL REINFORCEMENT FOR 8'-11" BEAM SPACING.
5. MINIMUM BAR LAPS:
 #4 BARS = 2'-7" #5 BARS = 3'-2"
6. DECK SLAB CONCRETE QUANTITY: THE ESTIMATED QUANTITY OF DECK SLAB CONCRETE IS BASED ON THE CONSTANT DECK SLAB THICKNESS, AS SHOWN, PLUS THE QUANTITY OF CONCRETE THAT FORMS EACH BEAM/GIRDER HAUNCH. THE ESTIMATE ASSUMES A CONSTANT HAUNCH THICKNESS OF 2 INCHES AND A CONSTANT HAUNCH WIDTH OUTSIDE THE EDGE OF EACH BEAM/GIRDER FLANGE OF 9 INCHES. DEVIATE FROM THIS HAUNCH THICKNESS AS NECESSARY TO PLACE THE DECK SURFACE AT THE FINISHED GRADE. THE ALLOWABLE TOLERANCE FOR THE HAUNCH WIDTH OUTSIDE THE EDGE OF EACH BEAM/GIRDER FLANGE IS +/- 3 INCHES.
7. FOR QUANTITIES AND ADDITIONAL LIGHTING DETAILS SEE LIGHTING PLAN SHEETS $\frac{1240}{1679}$.
8. FOR LIST OF ABBREVIATIONS SEE SHEET $\frac{4}{70}$.
9. HMWM SEALER (2'-0" WIDE CENTERED ABOUT JOINT) INCLUDED WITH ITEM 511, CLASS HP CONCRETE, BRIDGE DECK, AS PER PLAN FOR PAYMENT.
10. THE CONTRACTOR SHALL POUR THE DECKS ON BOTH SIDES OF A COMMON FORM CONCURRENTLY. THE FORMWORK SHALL REMAIN IN PLACE UNTIL STAGE 2, PHASE E CONSTRUCTION.

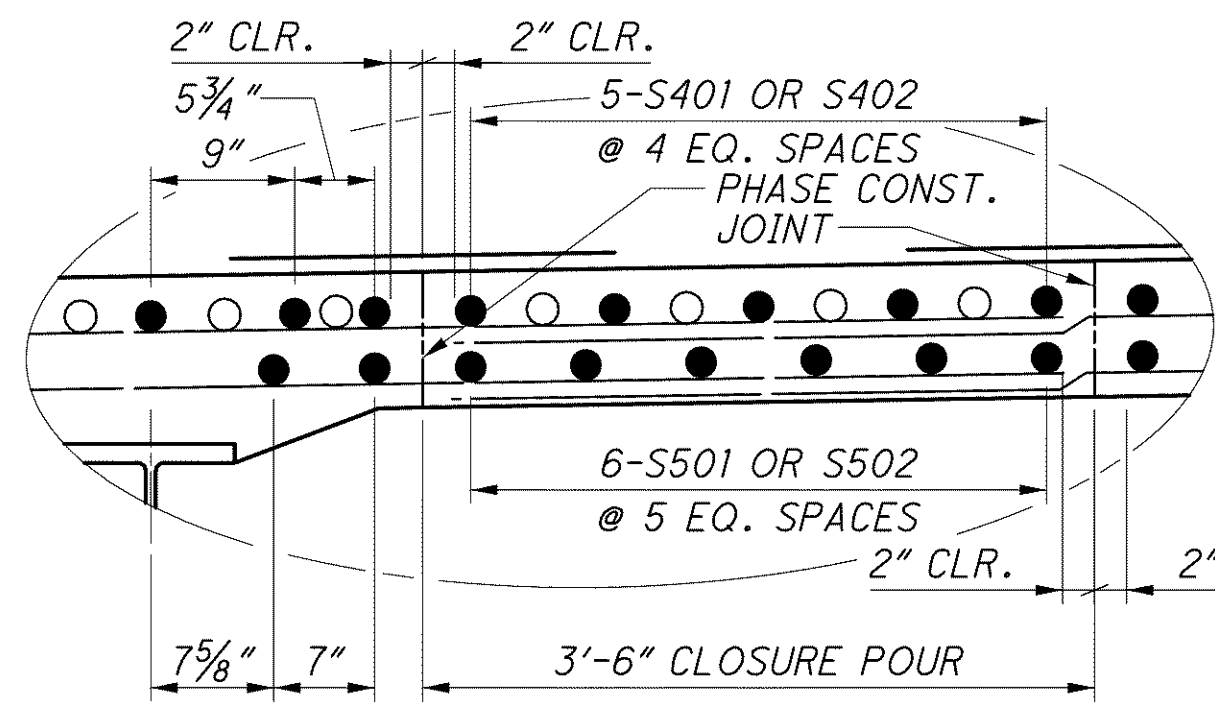

DETAIL A

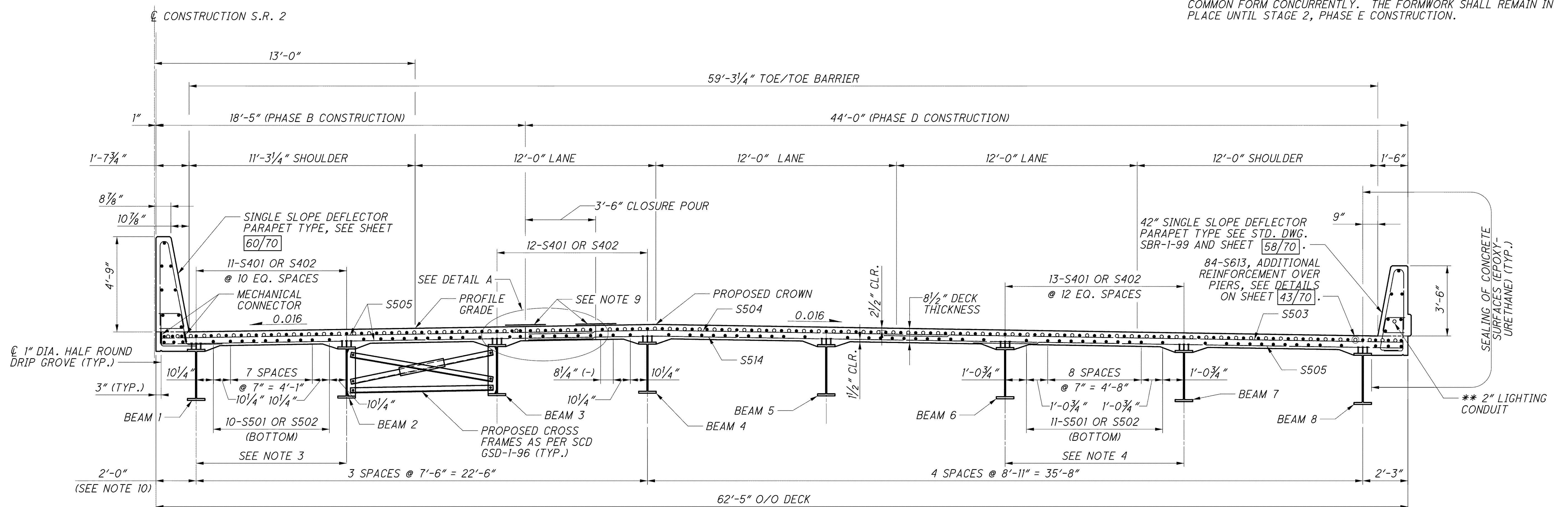

**TRANSVERSE SECTION
EASTBOUND**

** - INCLUDE WITH LIGHTING QUANTITIES FOR PAYMENT

<p>DESIGN AGENCY PARSONS BRINCKERHOFF QUADE & DOUGLAS, INC. 614 W. SUPERIOR AVE., SUITE 400 CLEVELAND, OHIO 44113</p>	<p>DATE 6-19-08</p> <p>REVIEWED RJO</p> <p>DESIGNED P.JL</p> <p>DRAWN LEL</p> <p>STRUCTURE FILE NUMBER 4300686 (L) 4500726 (R)</p>
<p>EASTBOUND TRANSVERSE SECTION</p> <p>LAK-2-0486 L&R</p> <p>STATE ROUTE 2 OVER ERIE ROAD</p>	
<p>LAK-2-3.32</p> <p>PID 13486</p>	
<p>42 / 70</p> <p>$\frac{1434}{1679}$</p>	

j:\LAK\13486\bridge\LAK002_0486C\sheets\02_0486CTS001.dgn 03-JUL-2008 1:44PM lintn