

j:\LAK\13486\bridge\LAK002_0486c\sheets\002_0486CPC005.dgn 03-JUL-2008 1:37PM lintn

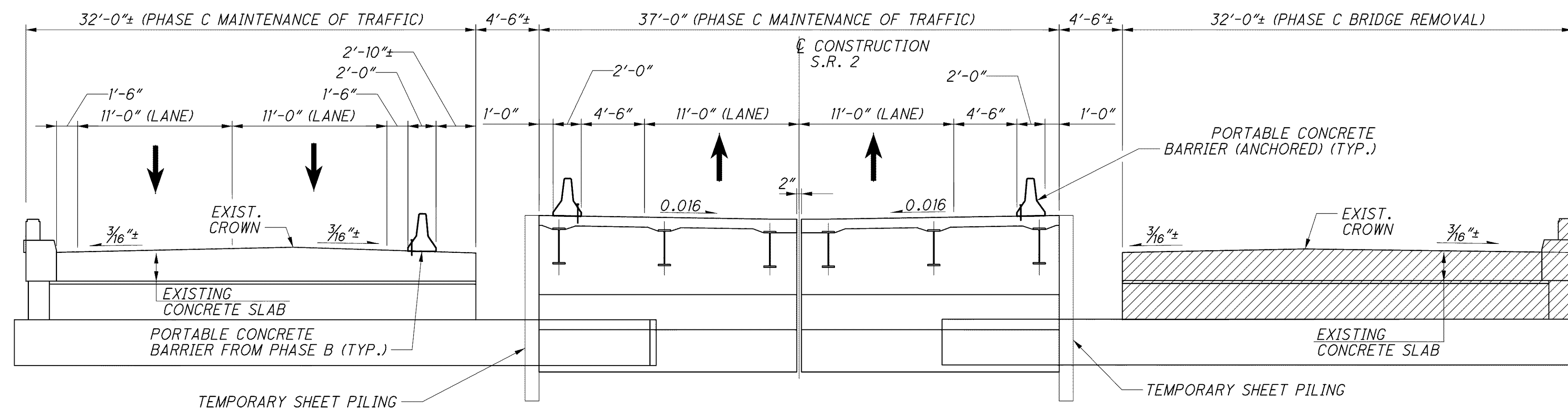

PHASE C MAINTENANCE OF TRAFFIC

PHASE C MAINTENANCE OF TRAFFIC

PHASE C REMOVAL

EASTBOUND REAR ABUTMENT
FORWARD SIMILAR

WESTBOUND REAR ABUTMENT
FORWARD SIMILAR

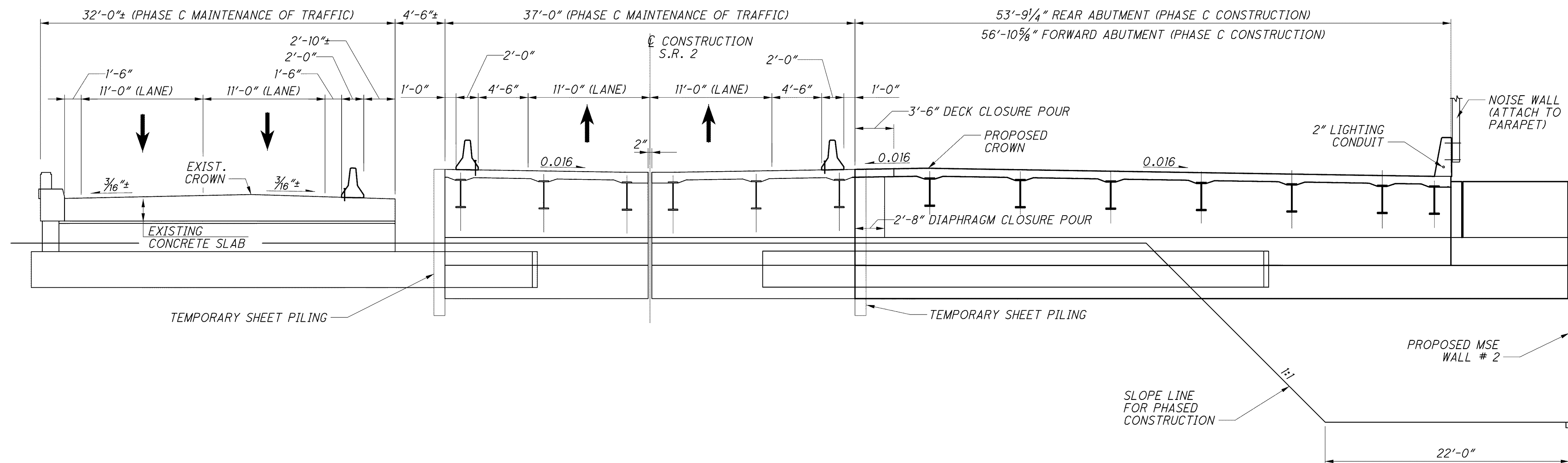

PHASE C MAINTENANCE OF TRAFFIC

PHASE C MAINTENANCE OF TRAFFIC

PHASE C CONSTRUCTION

EASTBOUND REAR ABUTMENT
FORWARD SIMILAR

WESTBOUND REAR ABUTMENT
SEE NOTE 1

NOTES:

1. WESTBOUND FORWARD ABUTMENT SHALL BE CONSTRUCTED WITH THE GIVEN DIMENSIONS WITH A STRAIGHT WINGWALL. MSE WALL APPLIES TO REAR ABUTMENT ONLY.
2. ABUTMENT PILES NOT SHOWN FOR CLARITY.
3. ALL PHASES SHALL BE CONSTRUCTED IN STAGE 2 AS SHOWN, HOWEVER, LIMITED SUBSTRUCTURE WORK MAY PROCEED DURING STAGE 1 (PHASE B), AS APPROVED BY THE ENGINEER.
4. FOR LIST OF ABBREVIATIONS SEE SHEET 4/70.
5. ALL DIMENSIONS ARE PERPENDICULAR TO THE ϕ .
6. PORTABLE CONCRETE BARRIER ANCHORS INCLUDED WITH ROADWAY QUANTITIES FOR PAYMENT.
7. ALL BARRIER SEGMENTS SHALL BE FASTENED TO THE BRIDGE DECK USING THREE (3) ONE INCH DIA. HIGH STRENGTH THROUGH BOLTS OR APPROVED RESIN ANCHORS. WHEN RESIN ANCHORS ARE USED THEY MUST BE EMBEDDED A MINIMUM OF 6 1/2" INTO FIRM CONCRETE. ALL ANCHORS SHALL BE PLACED ON THE TRAFFIC SIDE OF THE BARRIER WITH THE ANCHOR PATTERN SYMMETRICAL ABOUT THE CENTER OF EACH SEGMENT.

DESIGN AGENCY		DATE	
PARSONS BRINCKERHOFF QUADE & DOUGLAS, INC. 614 W. SUPERIOR AVE., SUITE 400 CLEVELAND, OHIO 44113		6-19-08	
DRAWN		REVIEWED	
LEL		RJO	
DESIGNED		STRUCTURE FILE NUMBER	
P.J.L.		4300686 (L) 4300726 (R)	
CHECKED		REVISED	
EJC			
PHASE CONSTRUCTION DETAILS			
LAK-2-3.32 LAK-2-0486 L&R STATE ROUTE 2 OVER ERIE ROAD			
LAK-2-3.32		PID 13486	
11 / 70		1403 1679	