

o:\project\c0000048a001\drawing\lak\13486\bridge\lak002_0363\sheet\002_0363\CD005.dgn 6/24/2008 3:50:41 PM troxberry

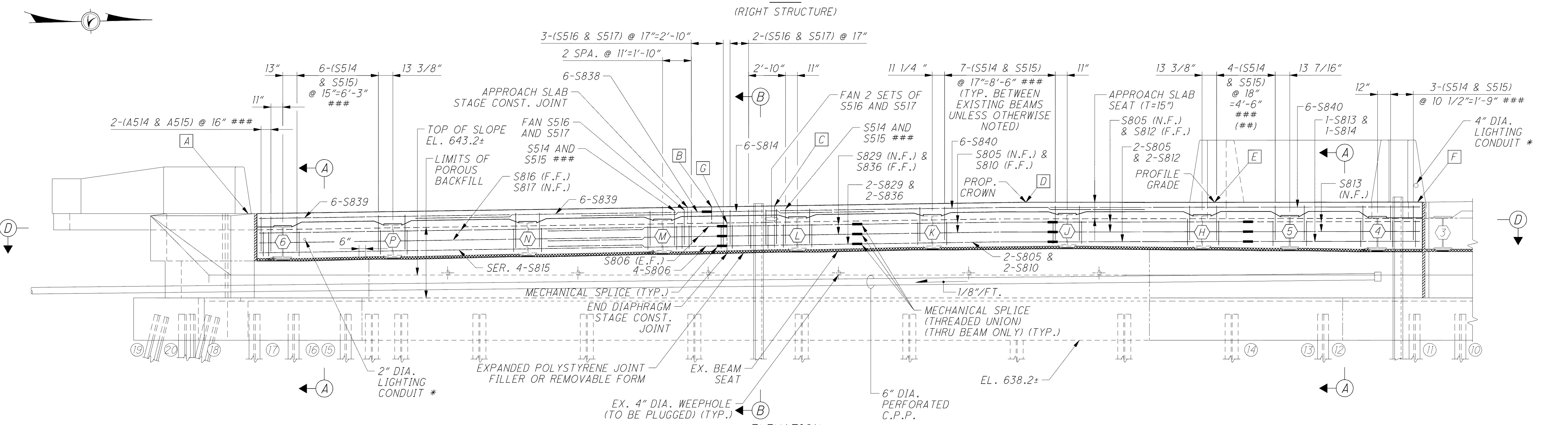
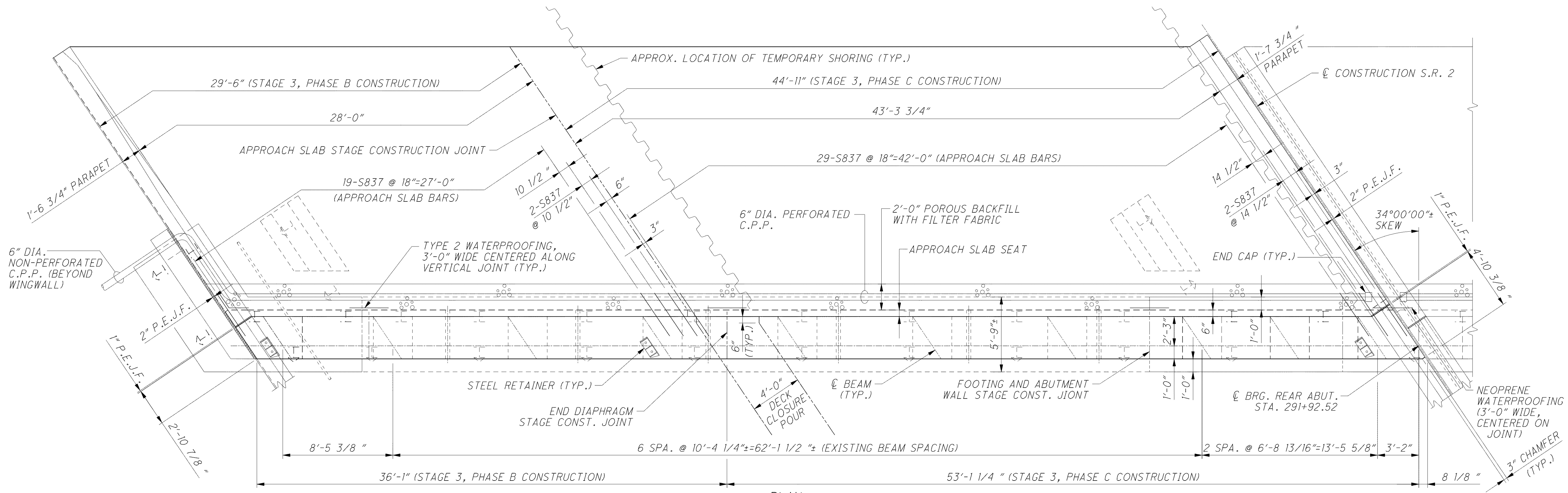

NOTES:

1. FOR SECTION A-A AND SECTION B-B SEE SHEET [28/44].
2. FOR PILE PLAN, SEE SHEET [10/44].
3. FOR SECTION D-D AND ADDITIONAL NOTES AND DETAILS, SEE SHEET [27/44].
4. ELEVATIONS TAKEN AT CENTERLINE OF BEARING.
5. MINIMUM BAR LAPS ARE AS FOLLOWS: #8 BARS = 87"

LEGEND

- * - INCLUDE WITH LIGHTING QUANTITIES FOR PAYMENT
- ## - TYPICAL BETWEEN BEAMS 4-5 AND 5-H.
- ### - BARS TO BE PLACED PARALLEL TO \hat{C} CONSTRUCTION.

REAR ABUTMENT DIAPHRAGM ELEVATION TABLE (RIGHT STRUCTURE)

A	B	C	D	E	F	G
647.88	648.50	648.58	648.91	648.77	648.61	647.27