

o:\project\lak\13486\lighting\sheets\13486LP016.dgn 7/11/2008 8:52:00 AM dshoner

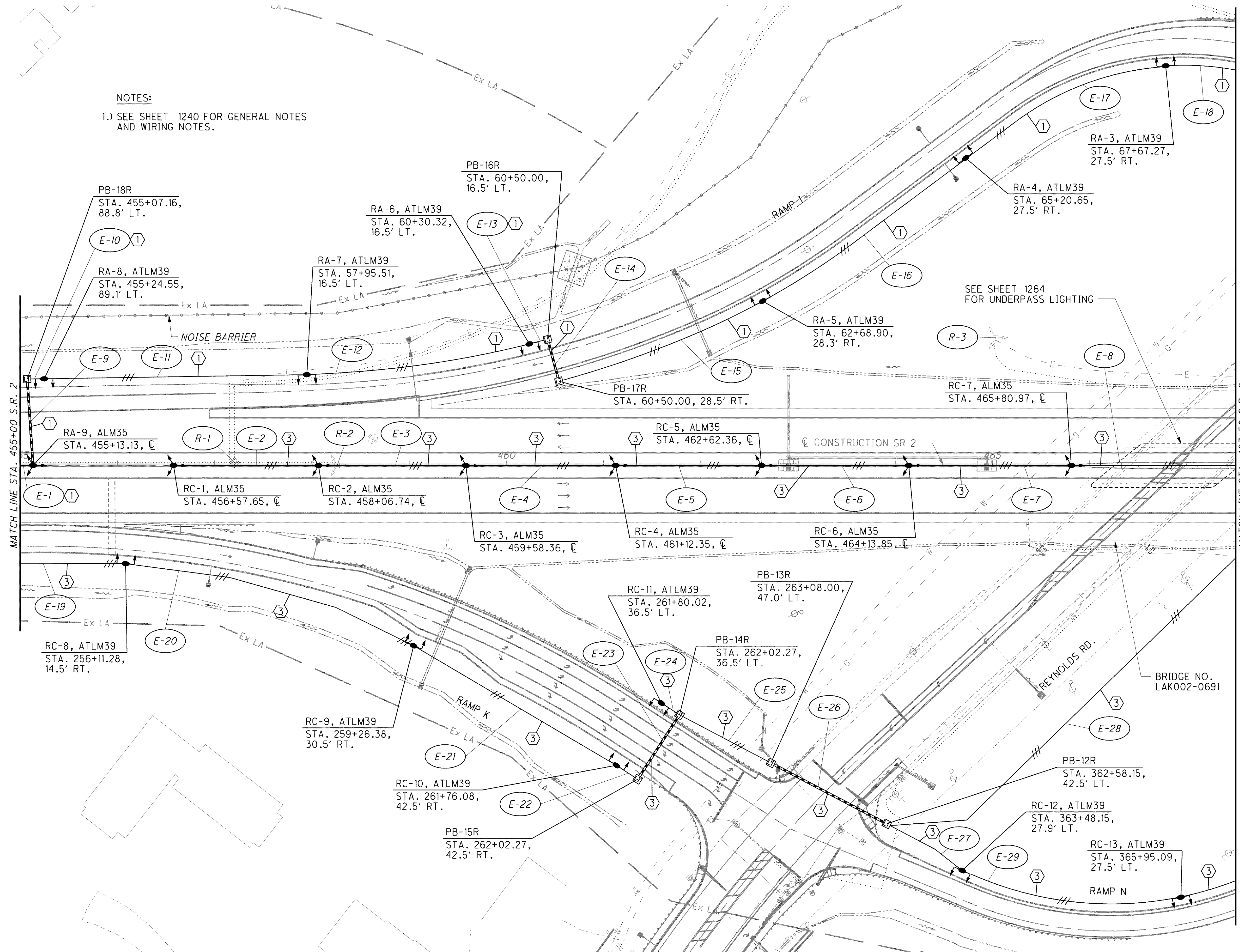

NOTES:
 1.) SEE SHEET 1240 FOR GENERAL NOTES AND WIRING NOTES.

MATCH LINE STA. 455+00 S.R. 2

MATCH LINE STA. 467+50 S.R. 2

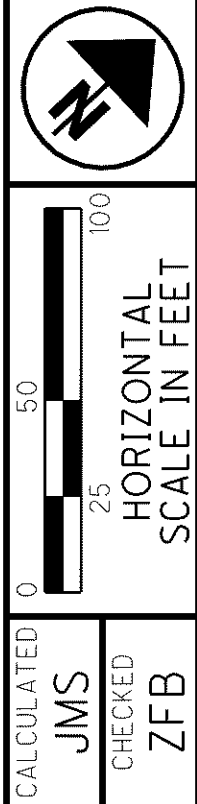

CALCULATED	JMS	CHECKED	ZFB
------------	-----	---------	-----

LIGHTING PLAN
STA. 455+00 TO STA. 467+50

LAK-2-3.32

1257
1679

PB-18R
 STA. 455+07.16,
 88.8' LT.

RA-8, ATLM39
 STA. 455+24.55,
 89.1' LT.

RA-9, ALM35
 STA. 455+13.13, C

RC-8, ATLM39
 STA. 256+11.28,
 14.5' RT.

RC-9, ATLM39
 STA. 259+26.38,
 30.5' RT.

RC-10, ATLM39
 STA. 261+76.08,
 42.5' RT.

PB-15R
 STA. 262+02.27,
 42.5' RT.

RA-6, ATLM39
 STA. 60+30.32,
 16.5' LT.

RA-7, ATLM39
 STA. 57+95.51,
 16.5' LT.

RC-1, ALM35
 STA. 456+57.65, C

RC-2, ALM35
 STA. 458+06.74, C

RC-3, ALM35
 STA. 459+58.36, C

RC-11, ATLM39
 STA. 261+80.02,
 36.5' LT.

PB-16R
 STA. 60+50.00,
 16.5' LT.

RC-5, ALM35
 STA. 462+62.36, C

RC-4, ALM35
 STA. 461+12.35, C

PB-13R
 STA. 263+08.00,
 47.0' LT.

PB-14R
 STA. 262+02.27,
 36.5' LT.

RC-6, ALM35
 STA. 464+13.85, C

RA-4, ATLM39
 STA. 65+20.65,
 27.5' RT.

RC-7, ALM35
 STA. 465+80.97, C

PB-12R
 STA. 362+58.15,
 42.5' LT.

RC-12, ATLM39
 STA. 363+48.15,
 27.9' LT.

RC-13, ATLM39
 STA. 365+95.09,
 27.5' LT.

RA-3, ATLM39
 STA. 67+67.27,
 27.5' RT.

BRIDGE NO.
 LAK002-0691

SEE SHEET 1264
 FOR UNDERPASS LIGHTING

REYNOLDS RD.

RAMP N

RAMP K

RAMP J

CONSTRUCTION SR 2

NOISE BARRIER

E-10

E-9

E-11

E-1

E-19

E-20

E-12

R-1

E-2

R-2

E-3

E-4

E-5

E-6

E-7

E-13

E-14

E-15

E-16

E-8

R-3

E-23

E-24

E-25

E-26

E-28

E-27

E-29

E-18

E-17