

C:\Project\ak\13486\drainage\sheet\13486DC05.dgn 6/25/2008 2:27:05 PM pberdis

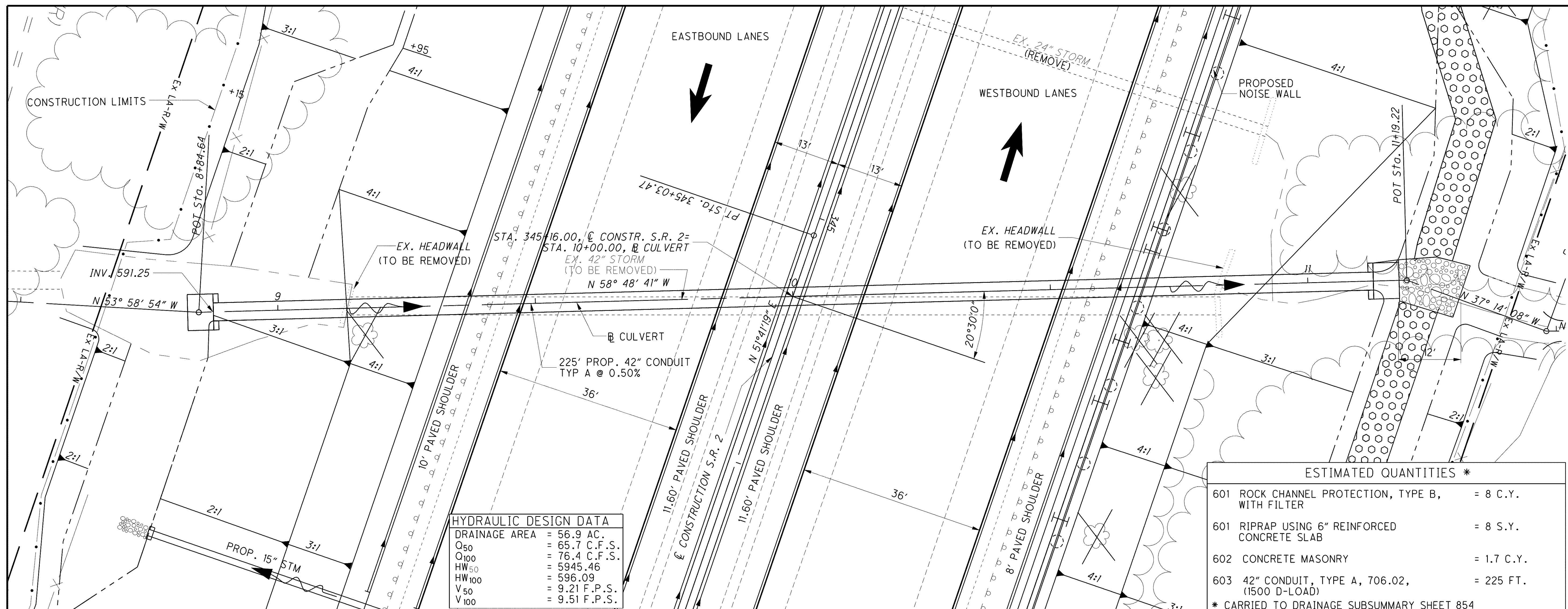

HYDRAULIC DESIGN DATA

DRAINAGE AREA	= 56.9 AC.
Q ₅₀	= 65.7 C.F.S.
Q ₁₀₀	= 76.4 C.F.S.
HW ₅₀	= 5945.46
HW ₁₀₀	= 596.09
V ₅₀	= 9.21 F.P.S.
V ₁₀₀	= 9.51 F.P.S.

ESTIMATED QUANTITIES *

601 ROCK CHANNEL PROTECTION, TYPE B, WITH FILTER	= 8 C.Y.
601 RIPRAP USING 6" REINFORCED CONCRETE SLAB	= 8 S.Y.
602 CONCRETE MASONRY	= 1.7 C.Y.
603 42" CONDUIT, TYPE A, 706.02, (1500 D-LOAD)	= 225 FT.

* CARRIED TO DRAINAGE SUBSUMMARY SHEET 854

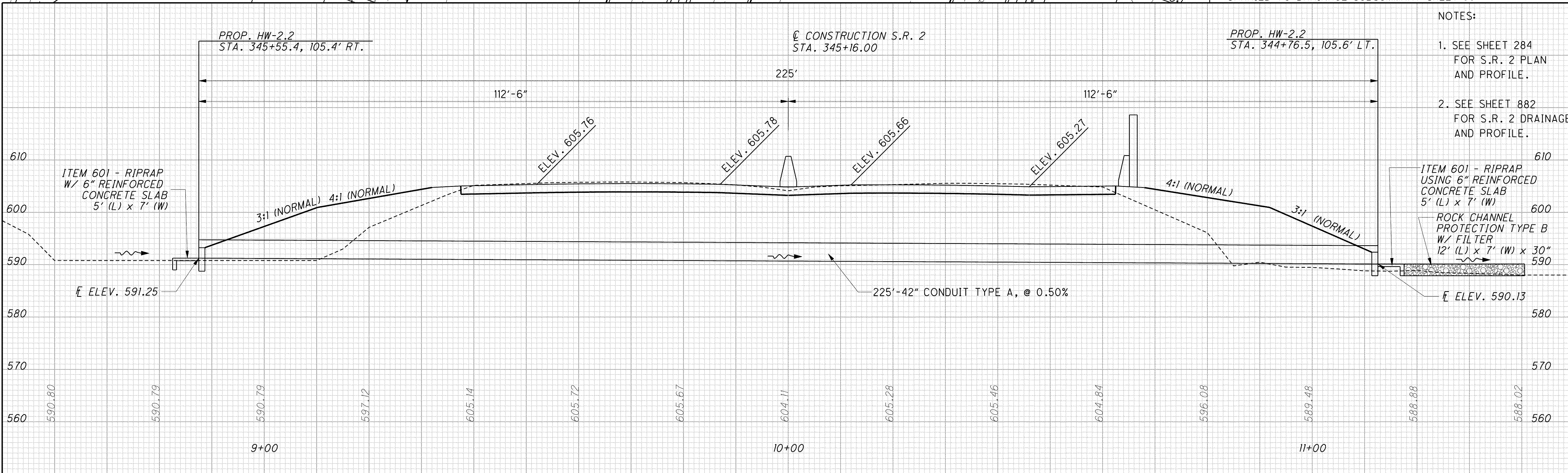

- NOTES:**
- SEE SHEET 284 FOR S.R. 2 PLAN AND PROFILE.
 - SEE SHEET 882 FOR S.R. 2 DRAINAGE AND PROFILE.

ITEM 601 - RIPRAP W/ 6" REINFORCED CONCRETE SLAB 5' (L) x 7' (W)

ROCK CHANNEL PROTECTION TYPE B W/ FILTER 12' (L) x 7' (W) x 30"

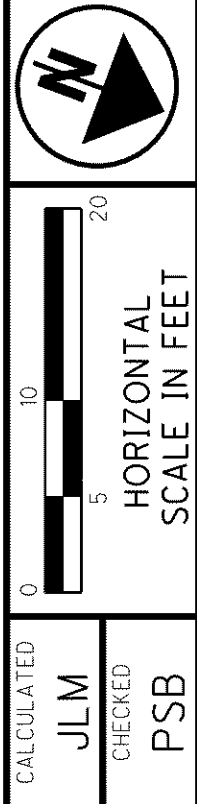

CULVERT DETAIL FOR LAK-2-0463
S.R. 2 STA. 345+16.00

LAK-2-3.32

855
1679