

**NOTES:**

- SEE SHEETS 947 TO 949 FOR WATER QUALITY BMP DETAILS AND QUANTITIES.
- SEE SHEETS 840 TO 847 FOR DRAINAGE SUBSUMMARY.
- SEE SHEETS 874 TO 896 FOR DRAINAGE PLAN AND PROFILES.
- SEE SHEETS 926 TO 938 FOR UNDERDRAIN DETAILS AND SUBSUMMARY.
- SEE SHEETS 1094 TO 1113 FOR TRAFFIC CONTROL PLANS.
- SEE SHEETS 1240 TO 1261 FOR LIGHTING PLANS.
- SEE SHEETS 561 TO 626 FOR SR 306 RAMP PLAN AND PROFILES.
- SEE SHEETS 248 TO 253 FOR ROADWAY SUBSUMMARY TABLES.

**LEGEND**

- EX. WETLANDS
- ITEM 670 DITCH EROSION PROTECTION, 660.02
- ITEM 601 ROCK CHANNEL PROTECTION TYPE C W/ FILTER
- ITEM 601 ROCK CHANNEL PROTECTION TYPE D W/ FILTER
- PAVEMENT TO BE REMOVED

**SR 2 CURVE DATA**  
 P.I. STA. 431+41.62  
 $\Delta = 36^\circ 36' 42''$  (LT)  
 $D_c = 1^\circ 15' 00''$   
 $R = 4,583.66'$   
 $T = 1,516.42'$   
 $L = 2,928.93'$   
 $E = 244.33'$   
 $eMAX = 0.036$

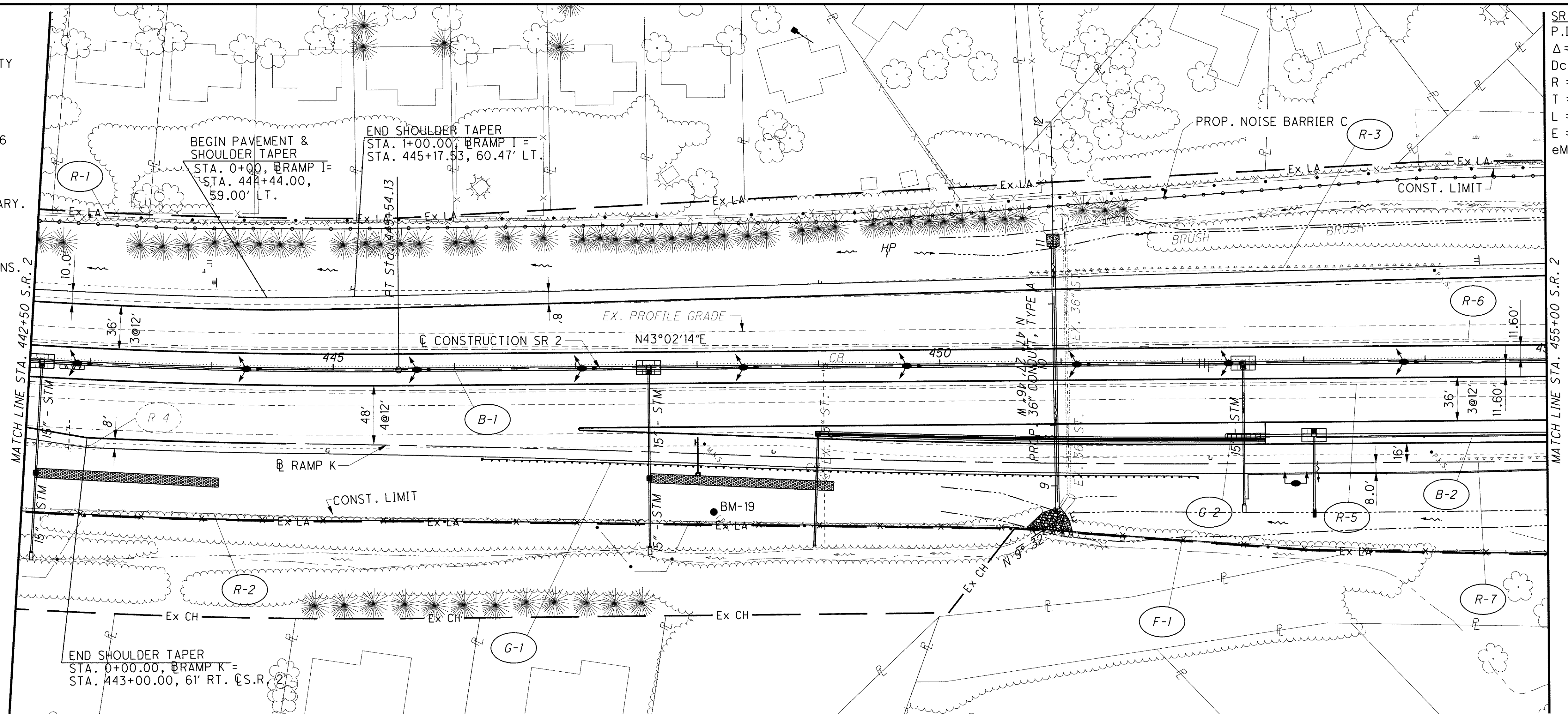

**BENCH MARK 19**  
 I.P. SET ON SOUTH SIDE S.R. 2  
 5' NORTH R/W FENCE NEAR STA. 448+00  
 STA. 448+12.81, 119.26' RT.  
 ELEV. = 633.41

**BENCH MARK 17**  
 I.P. SET ON SOUTH SIDE S.R. 2  
 5' NORTH R/W FENCE NEAR STA. 423+00  
 STA. 422+97.51, 115.79' RT.  
 ELEV. = 628.82

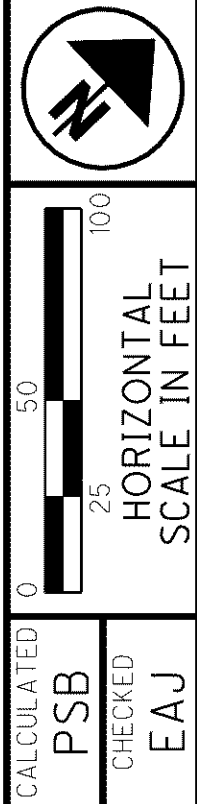

**PLAN AND PROFILE**  
**STA. 442+50 TO STA. 455+00**

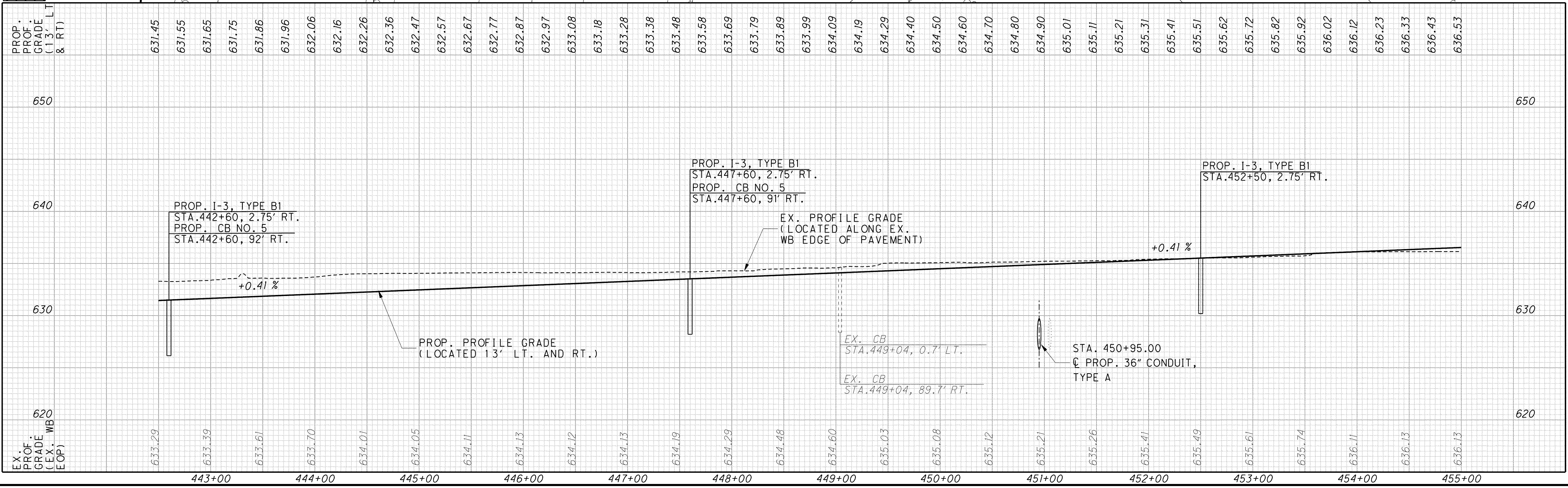

C:\Project\lak\13486\roadway\13486GP14.dgn 6/26/2008 7:28:49 AM pberdis