

- LEGEND**
- EX. WETLANDS
 - ITEM 670 DITCH EROSION PROTECTION, 660.02
 - ITEM 601 ROCK CHANNEL PROTECTION TYPE C W/ FILTER
 - PAVEMENT TO BE REMOVED

NOTES:

1. SEE SHEETS 947 TO 949 FOR WATER QUALITY BMP DETAILS AND QUANTITIES.
 2. SEE SHEETS 903 TO 916 FOR DRAINAGE DETAILS.
 3. SEE SHEETS 874 TO 896 FOR DRAINAGE PLAN AND PROFILES.
 4. SEE SHEETS 926 TO 938 FOR UNDERDRAIN DETAILS AND SUBSUMMARY.
 5. SEE SHEETS 1240 TO 1261 FOR LIGHTING PLANS.
 6. SEE SHEETS 1094 TO 1113 FOR TRAFFIC CONTROL PLANS.
 7. SEE SHEETS 248 TO 255 FOR ROADWAY SUBSUMMARY TABLES.
- SR 2 CURVE DATA**
P.I. STA. 336+33.03
 $\Delta = 8^\circ 08' 16''$ (RT)
 $D_c = 0^\circ 28' 00''$
 $R = 12,277.67'$
 $T = 873.37'$
 $L = 1,743.81'$
 $E = 31.02'$
EMAX = NONE

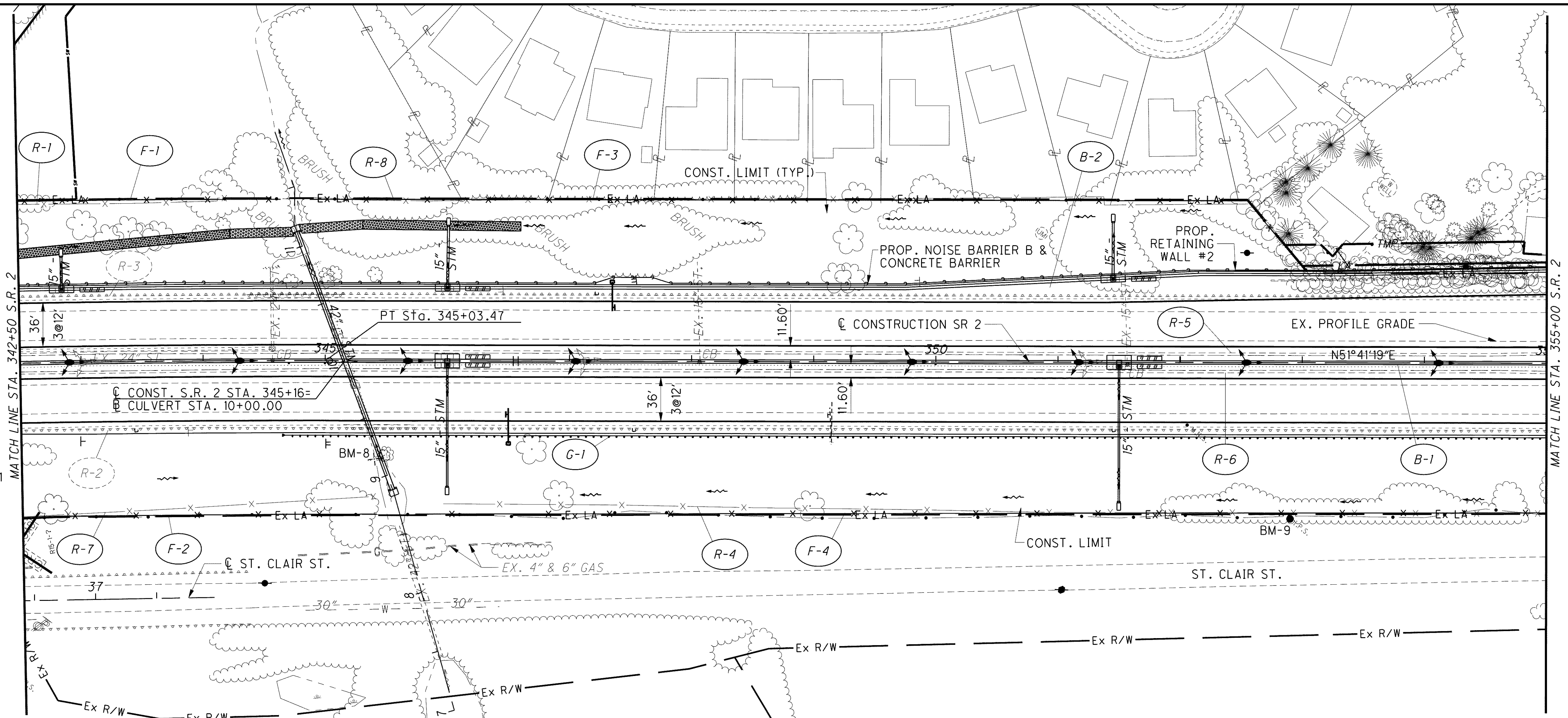

BENCH MARK 9
I.P. SET 3" NORTH R/W FENCE ON SOUTH SIDE S.R. 2
33' NORTH OF EDGE OF PAVEMENT OF ST. CLAIR
300' ± WEST OF ERIE ST. BRIDGE
STA. 352+90.26, 127.81' RT.
ELEV. = 598.01

BENCH MARK 8
CUT IN TOP CONC. HEADWALL @ S.E. CORNER
SOUTH SIDE OF S.R. 2 30' ± FROM EDGE OF PAVEMENT
STA. 345+40.36, 80.42' RT.
ELEV. = 596.03

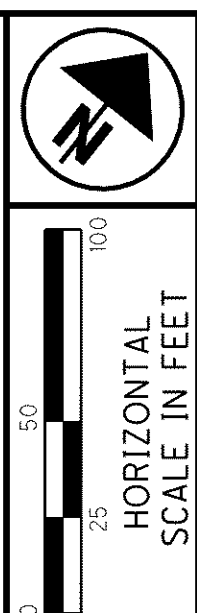

PLAN AND PROFILE
STA. 342+50 TO STA. 355+00

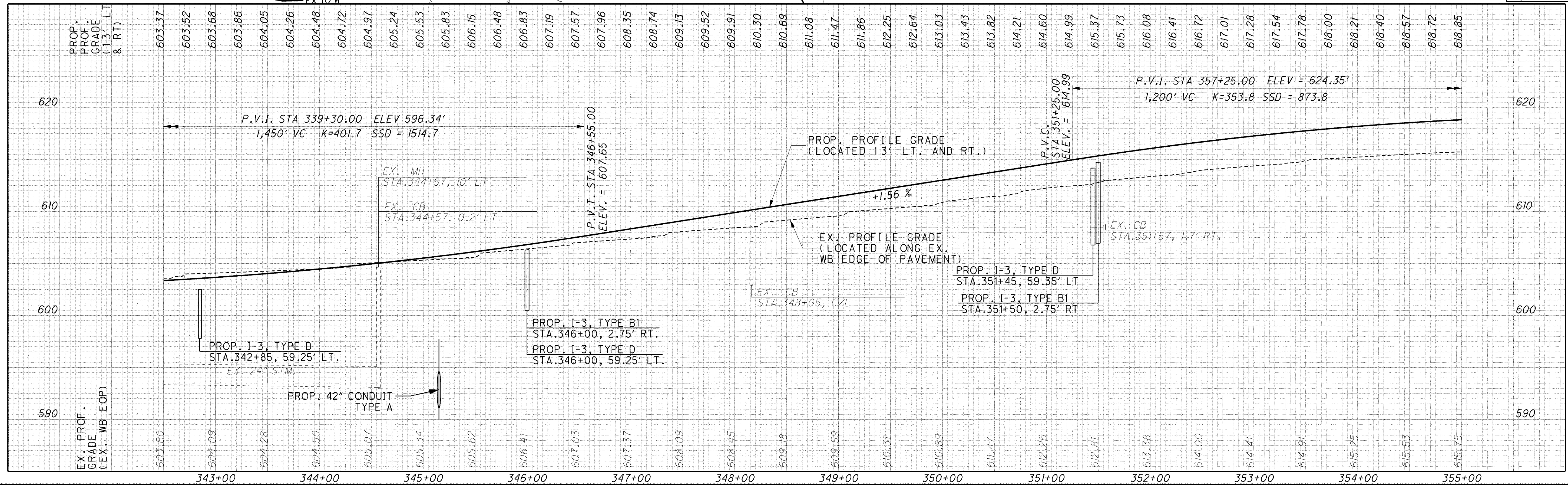

C:\Project\lak\13486\roadway\sheet\13486CP06.dgn 6/26/2008 7:23:56 AM pberdis

LAK-2-3.32