

g:\project\lak\13486\mot\sheet\13486MPLNB1.dgn 6/23/2008 11:27:07 AM jmoderia

- NOTES: 1. CONTRACTOR SHALL COVER ALL EXISTING CONFLICTING PAVEMENT MARKINGS IN ACCORDANCE WITH 614.11, F.1B.
 2. FOR PAVEMENT MARKING LEGEND SEE SHEET 56
 3. ALL EXISTING SIGNS SHALL REMAIN UNLESS OTHERWISE SHOWN, THE CONTRACTOR SHALL KEEP ALL EXISTING SIGNS VISIBLE DURING CONSTRUCTION.

WORK AREA

CALCULATED JMM
 CHECKED DRJ

0 10 20 40
 HORIZONTAL SCALE IN FEET

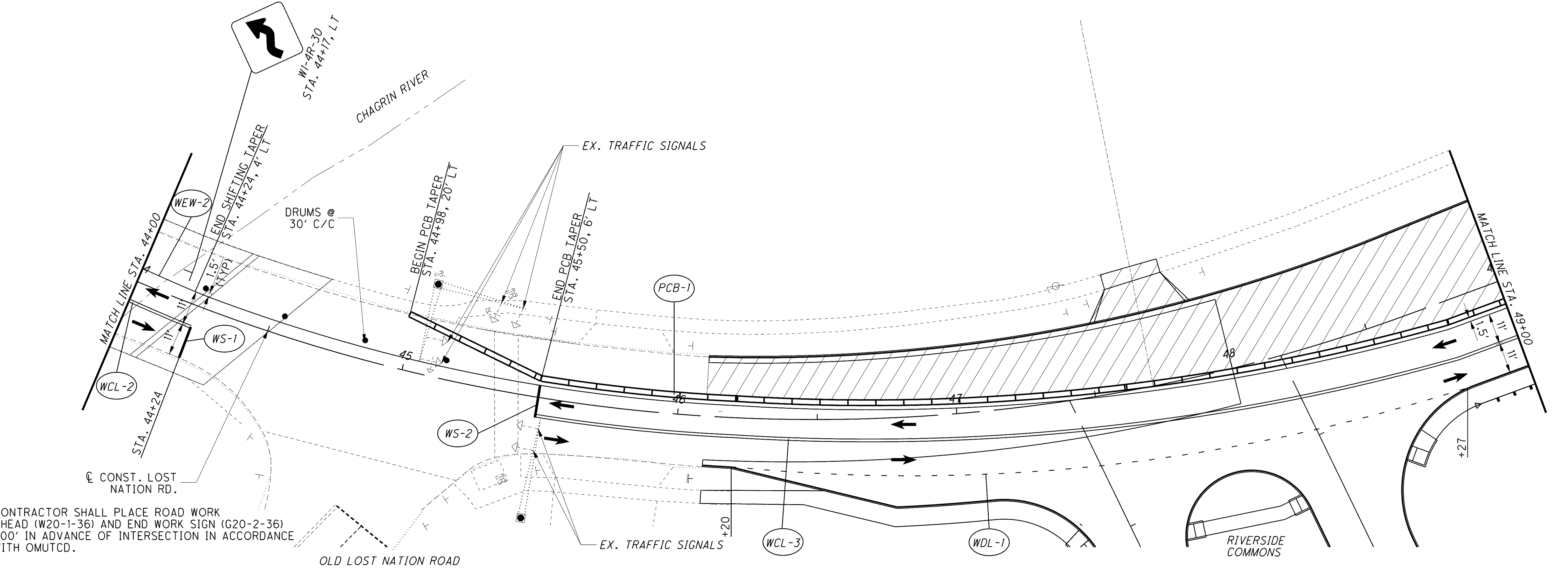
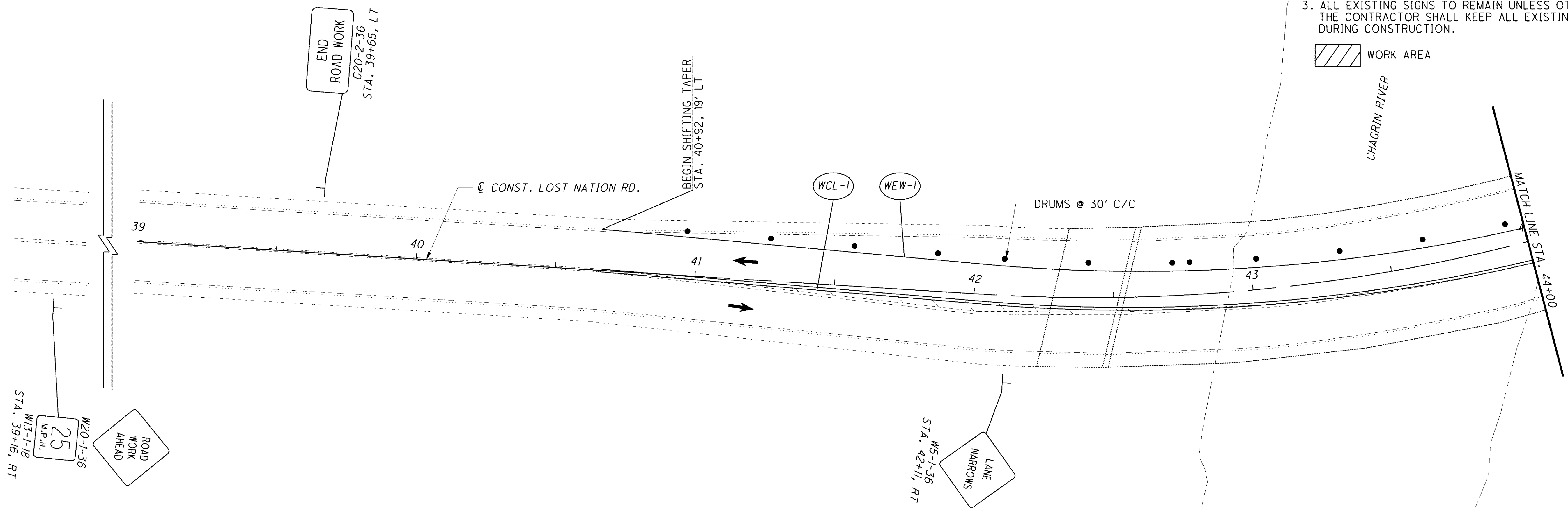

CONTRACTOR SHALL PLACE ROAD WORK AHEAD (W20-1-36) AND END WORK SIGN (G20-2-36) 200' IN ADVANCE OF INTERSECTION IN ACCORDANCE WITH OMUTCD.

**M.O.T. - LOST NATION RD. STAGE 1
 PHASE B STEP 4 - STA. 39+16 TO STA. 49+00**

LAK-2-3.32

232
 1679