

C:\Project\lak\13486\mot\sheet\13486MP002A.dgn 9/24/2008 1:21:00 PM djozily

LEGEND

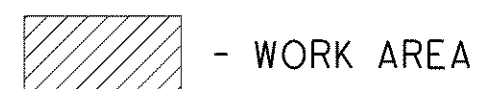

- WORK AREA

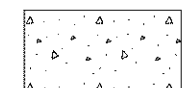

- TEMPORARY PAVEMENT



- TRAFFIC FLOW ARROWS

• • • - 25' c/c DRUMS ON TANGENT

• • • - 20' c/c DRUMS ON TAPER

• • • - 10' c/c DRUMS ON CURVE

NOTE:
PERMANENT PAV'T MARKINGS TO BE USED
IN STEP 4 EXCEPT AS SHOWN.

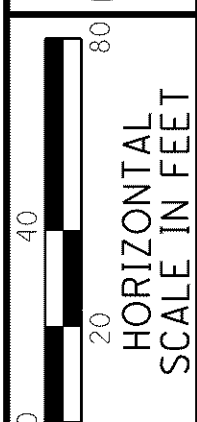
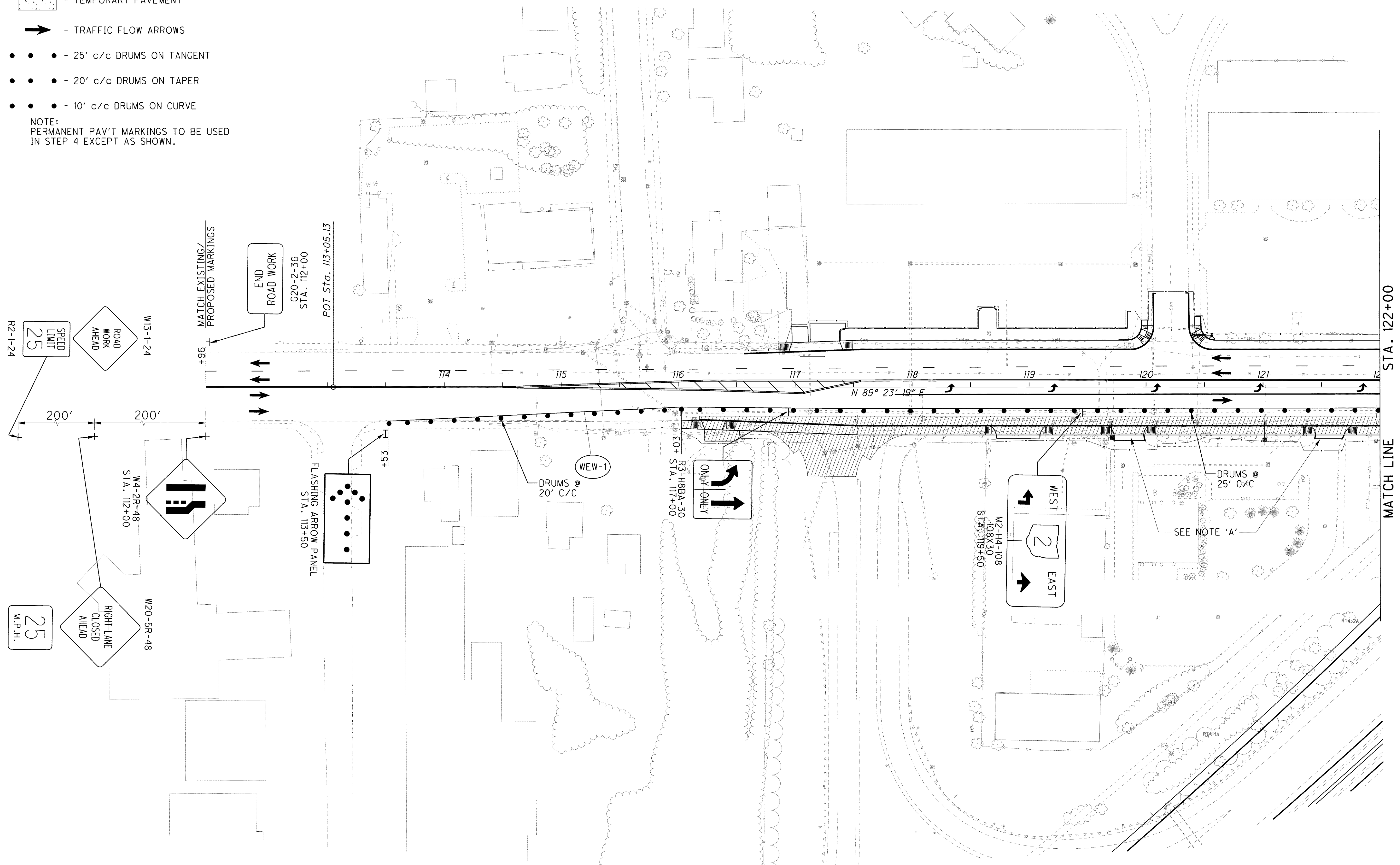

CALCULATED JMR
CHECKED EJC

**MAINTENANCE OF TRAFFIC - VINE ST.
BEGIN WORK TO STA. 122+00 (PHASE B-STEP 4)**

LAK-2-3.32

219
1679

NOTE 'A':
NOTE:
DRIVE ACCESS TO BE OPEN AT ALL TIMES.