

- NOTES: 1. FOR PAVEMENT MARKING LEGEND SEE SHEET 56.
2. CONTRACTOR SHALL REMOVE ALL EXISTING CONFLICTING PAVEMENT MARKINGS IN ACCORDANCE WITH 614.11.
3. ACCESS TO RESIDENTIAL AND COMMERCIAL PROPERTIES SHALL BE MAINTAINED AT ALL TIMES.

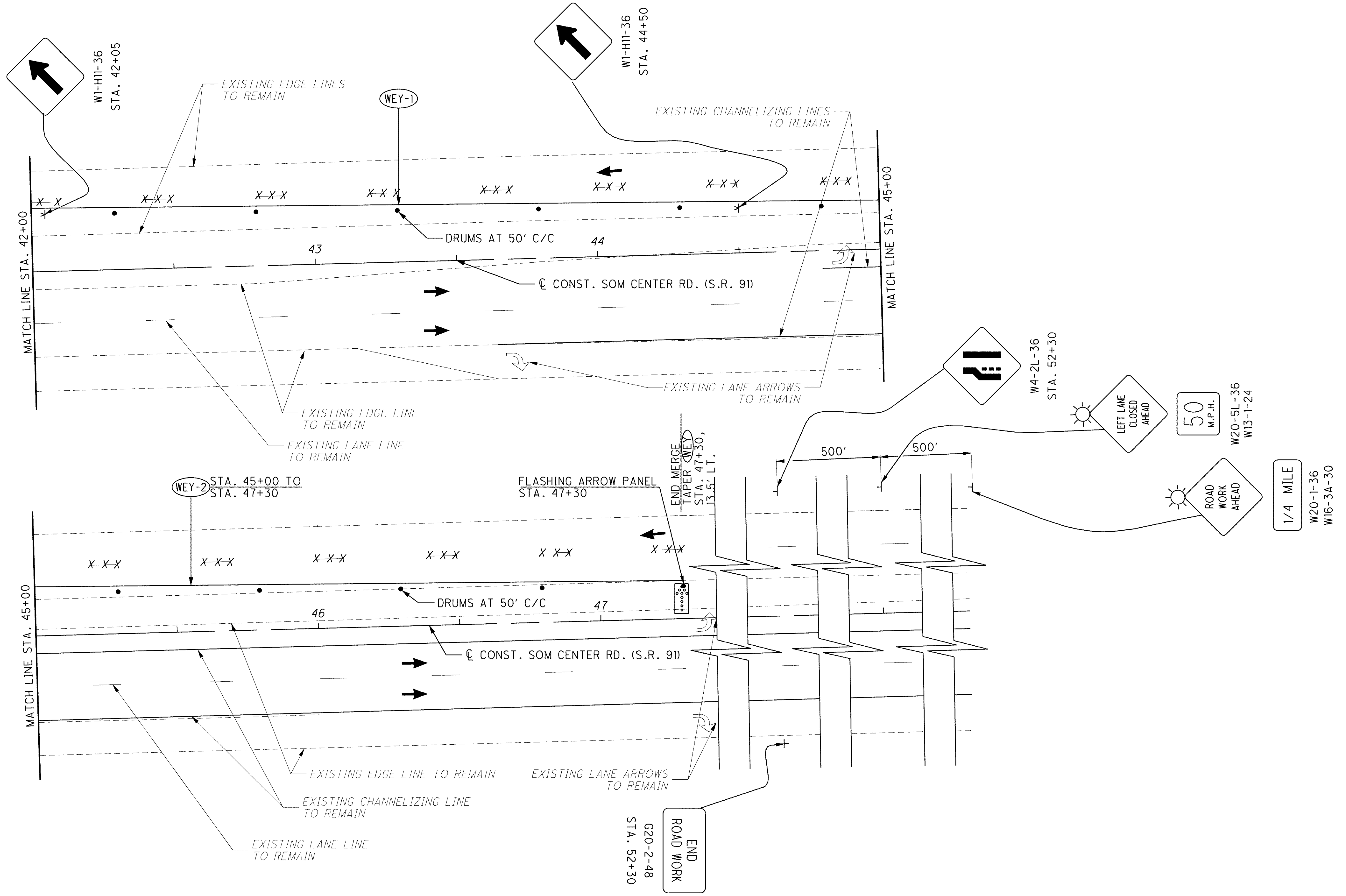

CALCULATED  
TRR  
CHECKED  
MAH

0 20 40  
HORIZONTAL  
SCALE IN FEET

**MAINTENANCE OF TRAFFIC - SOM CENTER RD. (S.R. 91)**  
**STAGE 3 PHASE B STEP 1 - STA. 42+00 TO END**