

- NOTES: 1. FOR PAVEMENT MARKING LEGEND SEE SHEET 56.
 2. CONTRACTOR SHALL REMOVE ALL EXISTING CONFLICTING PAVEMENT MARKINGS IN ACCORDANCE WITH 614.11.
 3. ACCESS TO RESIDENTIAL AND COMMERCIAL PROPERTIES SHALL BE MAINTAINED AT ALL TIMES.

\\Akrn01\Data\Civil\2004108\00\13486\mot\sheets\13486MP91A1.dgn 6/16/2008 8:00:20 AM svarrcccchia

W20-1-36
 W16-30-30
 1/4 MILE

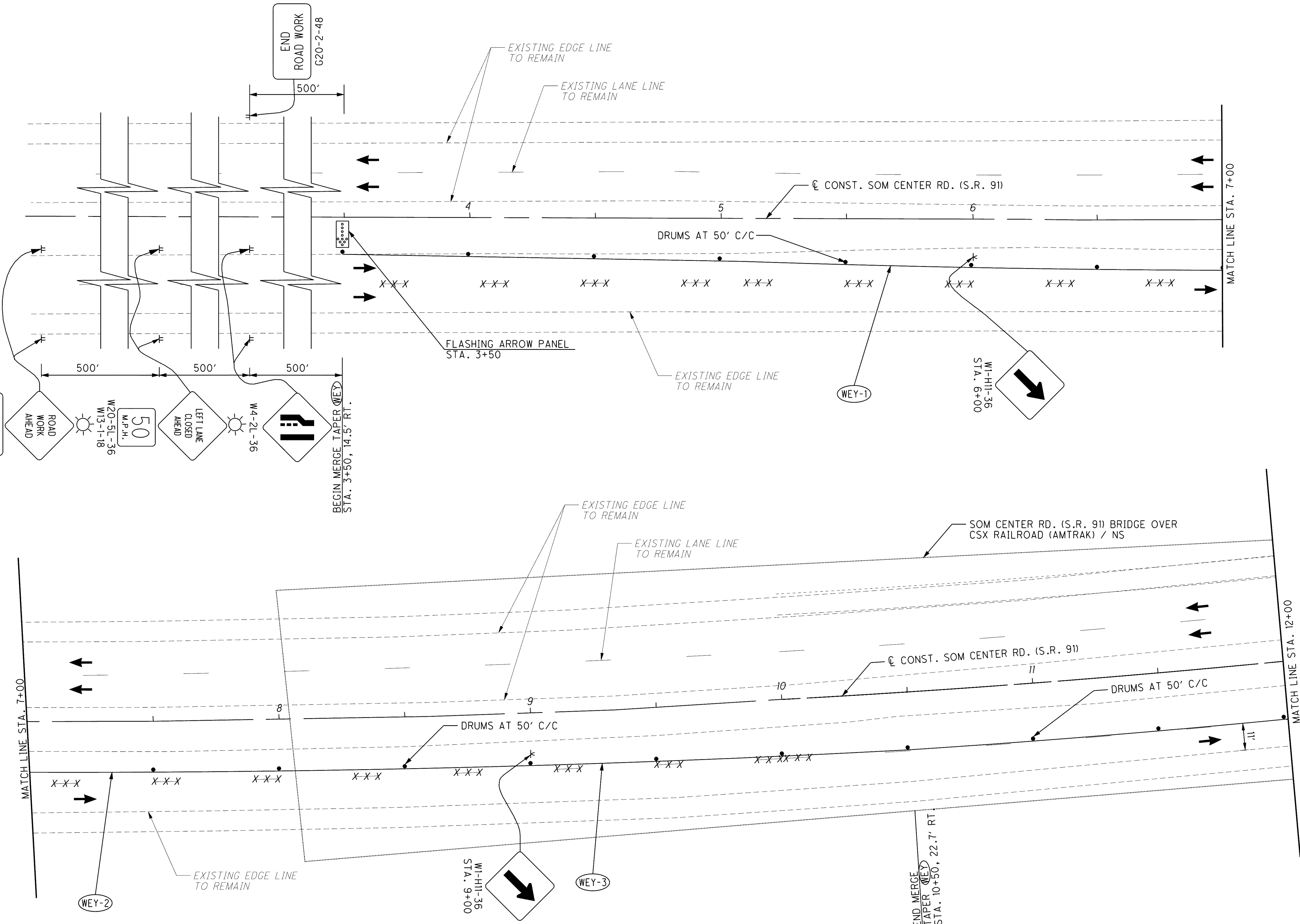

CALCULATED
 TRR
 CHECKED
 MAH

0 10 20 40
 HORIZONTAL
 SCALE IN FEET

N

MAINTENANCE OF TRAFFIC - SOM CENTER RD. (S.R. 91)
STAGE 3 PHASE B STEP 1 - BEGIN TO STA. 12+00

LAK-2-3.32