

\p\projects\p\d\3436\Addendum\Hornets\bridge\main\of\Traffic\generato\dgn 25 NOV 2008 7:46AM ekellie

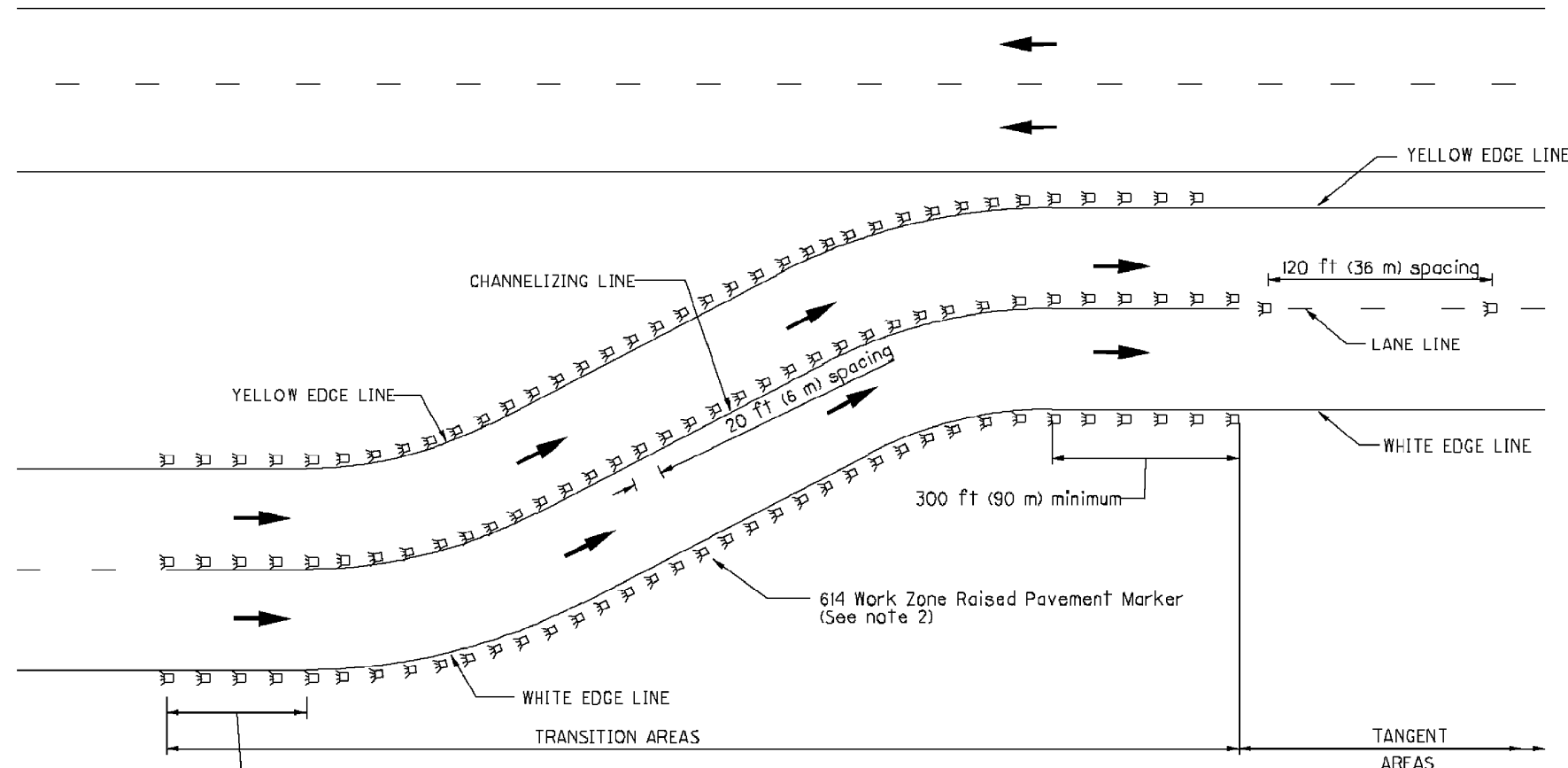

WORK ZONE DELINEATION FOR CROSSOVERS

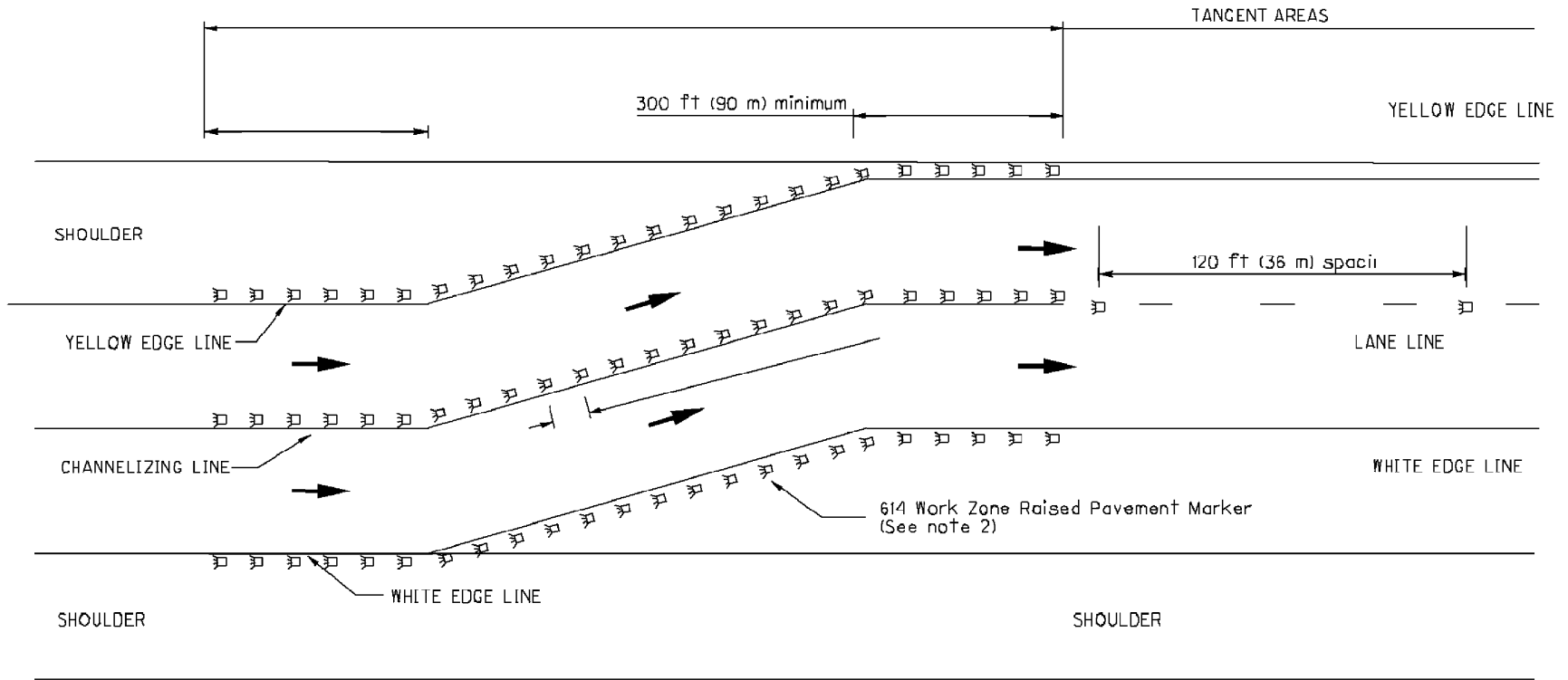

WORK ZONE DELINEATION FOR LANE SHIFTS

NOTES

1. This drawing presents delineation procedures for freeways and expressways on concrete surfaces. Procedures are provided for transition areas and for tangent areas. The procedures for transition areas apply to crossovers and to lane shifts of 4 feet (1.2 m) or greater. Delineation of transition areas for shifts of less than 4 feet (1.2 m) shall be as per the tangent area delineation.
2. The Work Zone Raised Pavement Markers (WZRPMS) shown on this drawing are intended for use only during the non-snow-plowing season. WZRPMS shall not be provided during the snow-plowing season. The snow-plowing season shall be from October 16 through March 31 or as otherwise specified in the plans. Where a temporary alignment will remain in use through the winter, the WZRPMS shall be removed prior the beginning of snow-plowing season and replaced approximately April 1, or as otherwise determined by the Engineer.
3. All material furnished shall be listed on the Department's Prequalifid Lists.
4. The geometrics of the crossover shall be as shown in the plans. Additional details are provided in Standard Construction Drawing MT-95.70.
5. See Standard Construction Drawings MT-102.10 and MT-102.20 for more details concerning lane shifts.
6. Spacing of WZRPMS shall be at 20 feet (6 m) center-to-center for all long-line marking within transition areas. Within tangent areas WZRPMS shall be provided only along the lane lines, spaced at 120 feet (36 m) center-to-center.
7. The WZRPMS shall be 1-way, facing oncoming traffic, and shall be white or yellow to match the color of the associated line marking.
8. Along the edge lines, the WZRPMS shall be offset a maximum of 4 inches (100 mm) to the outside of the lines. Along the channelizing lines, the WZRPMS shall be offset to the left of the lines by no more than 1 inch (25 mm). Along the lane lines the WZRPMS shall be centered between dashes.
9. The WZRPMS shall be removed when they are no longer appropriate.

LEGEND

	WORK ZONE RPM, TYPE A
	DIRECTION OF TRAVEL

OFFICE OF TRAFFIC ENGINEERING	DESIGNED RETENDED LAW
REVISION DATE 07/20/07	CHECKED
P/S NUMBER 209931	
PLAN INSERT SHEET	WORK ZONE DELINEATION ON CONCRETE SURFACES
LAK-2-3.32	1/1
	188A 1679