

DETAIL 'A'

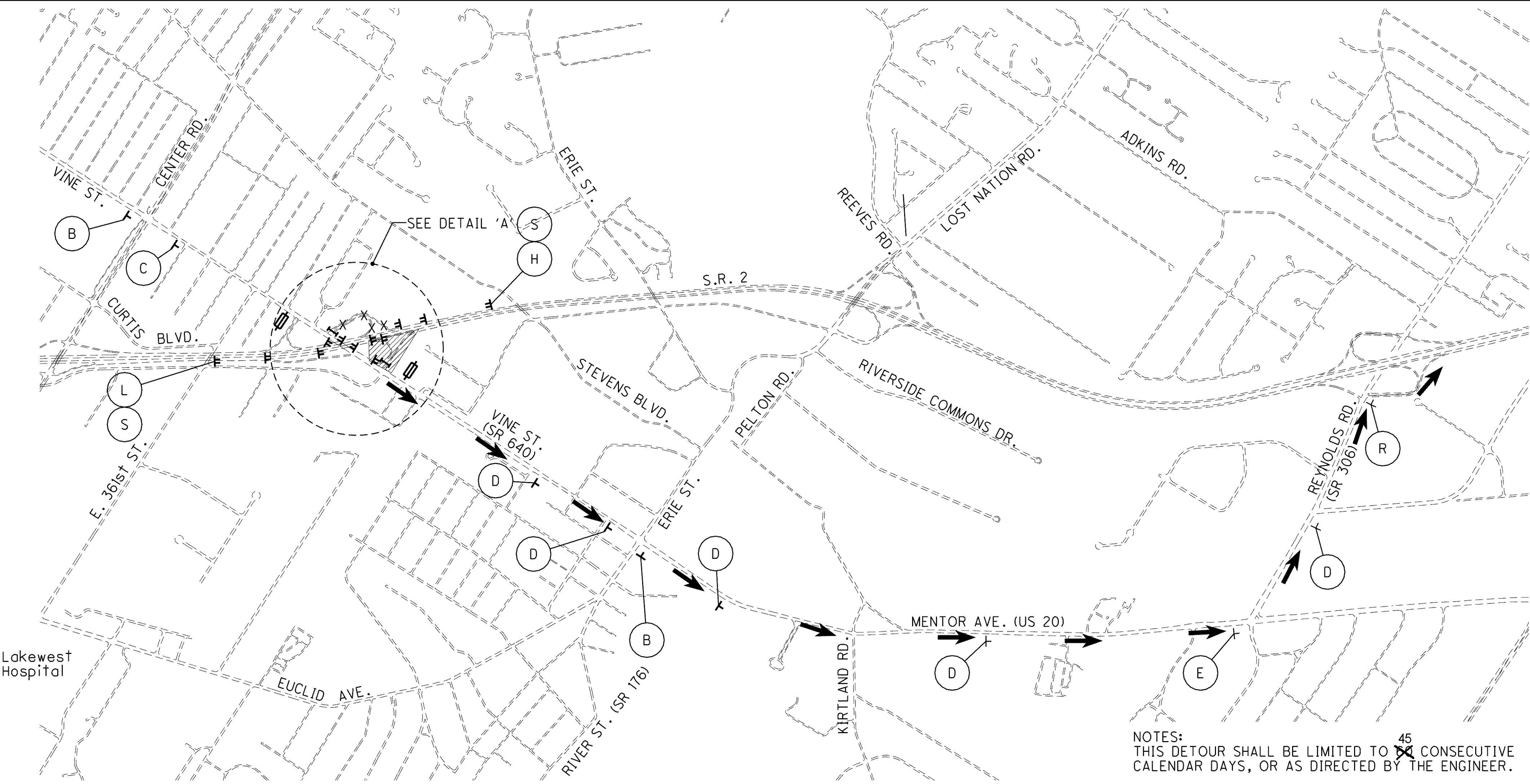

NOTES:  
THIS DETOUR SHALL BE LIMITED TO 45 CONSECUTIVE CALENDAR DAYS, OR AS DIRECTED BY THE ENGINEER.  
FOR PHASING OF THE VINE STREET RAMPS SEE M.O.T. GENERAL NOTES.

FOR WB A.M. PEAK DETOUR ROUTE & SIGNING DETAILS, SEE SHEET 177  
RAMP CLOSURES SHALL BE AS STD. DWG. MT-98.29 AND MT-101.60.

DETOUR SIGNING LOCATIONS SHALL BE AS PER OMTCD.  
AFFECTED SIGNS FOR THE VINE STREET INTERCHANGE SHALL BE OVERLAYED WITH A CLOSED PLAQUE WHEN THE DETOUR IS IN EFFECT.

WHENEVER THE CLOSURE OCCURS, THE TOTAL DETOUR SIGNING AS INDICATED ON THIS PLAN SHALL BE IMPLEMENTED.  
DETOUR SIGNS SHALL BE UNCOVERED AND VISIBLE TO TRAFFIC ONLY WHEN THE RAMP CLOSURE IS IN EFFECT.

PLACE PORTABLE CHANGEABLE MESSAGE SIGNS ONE WEEK PRIOR TO CLOSURE. MESSAGE LINES SHOULD INDICATE DETAILS OF FUTURE CLOSURES SUCH AS DATES, LOCATIONS, AND ALTERNATE ROUTES OR AS OTHERWISE DIRECTED BY THE ENGINEER.

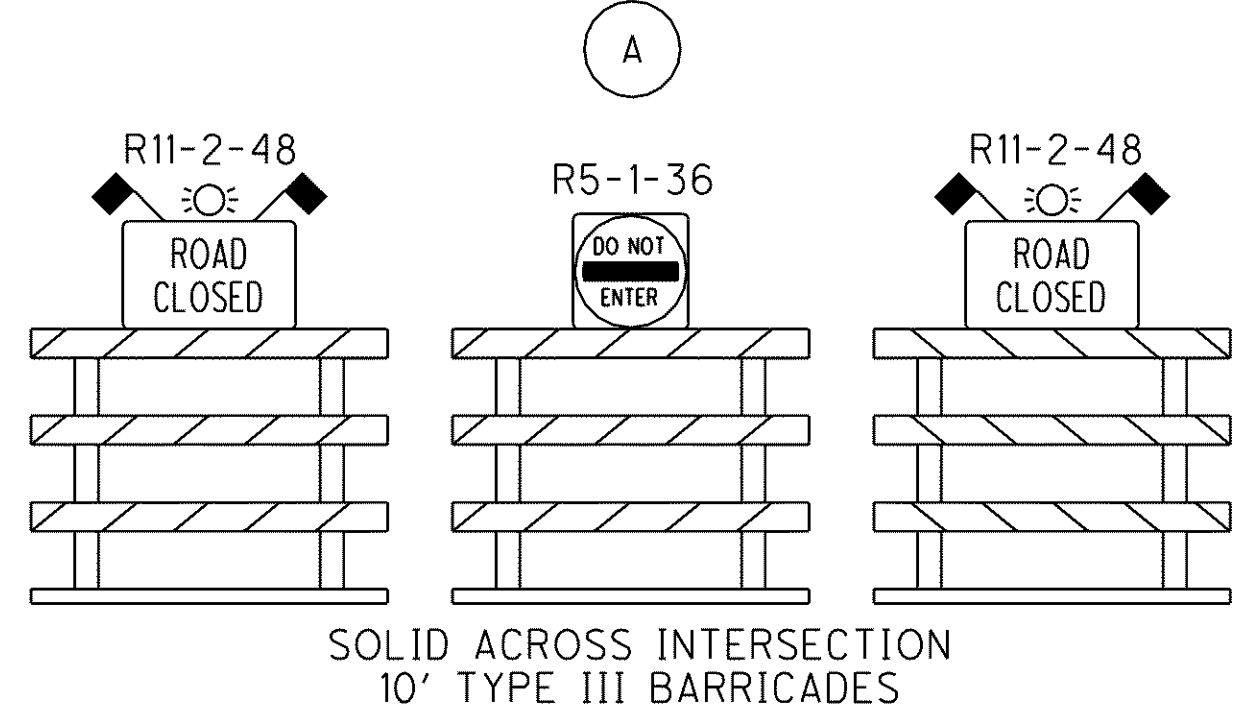

SOLID ACROSS INTERSECTION  
10' TYPE III BARRICADES

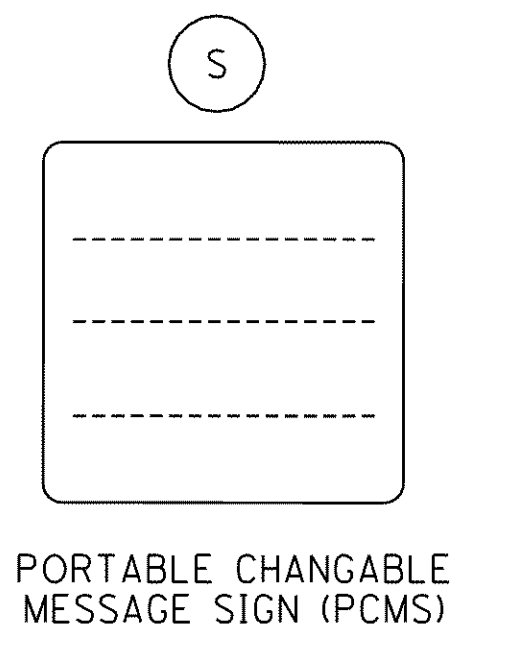
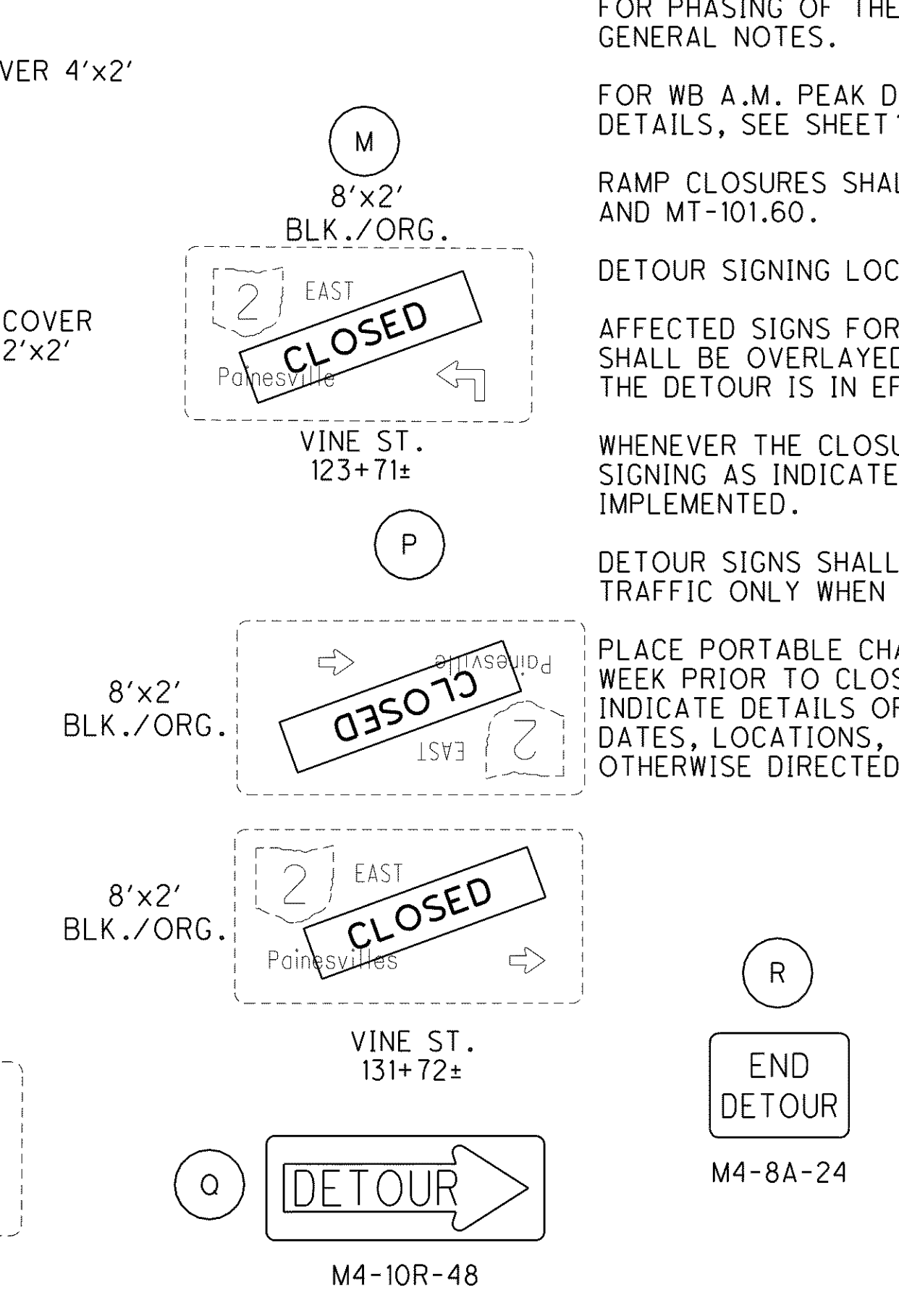
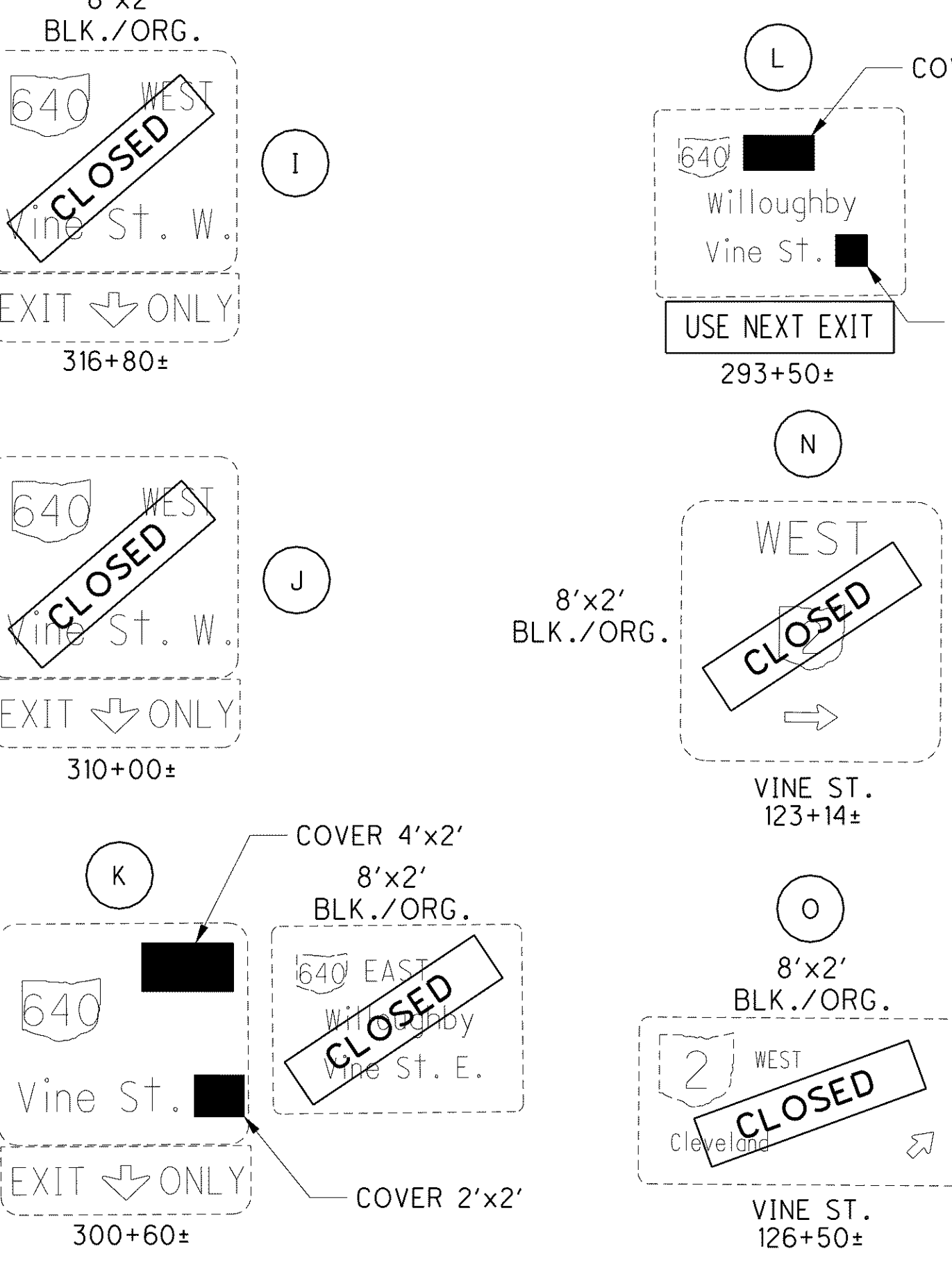
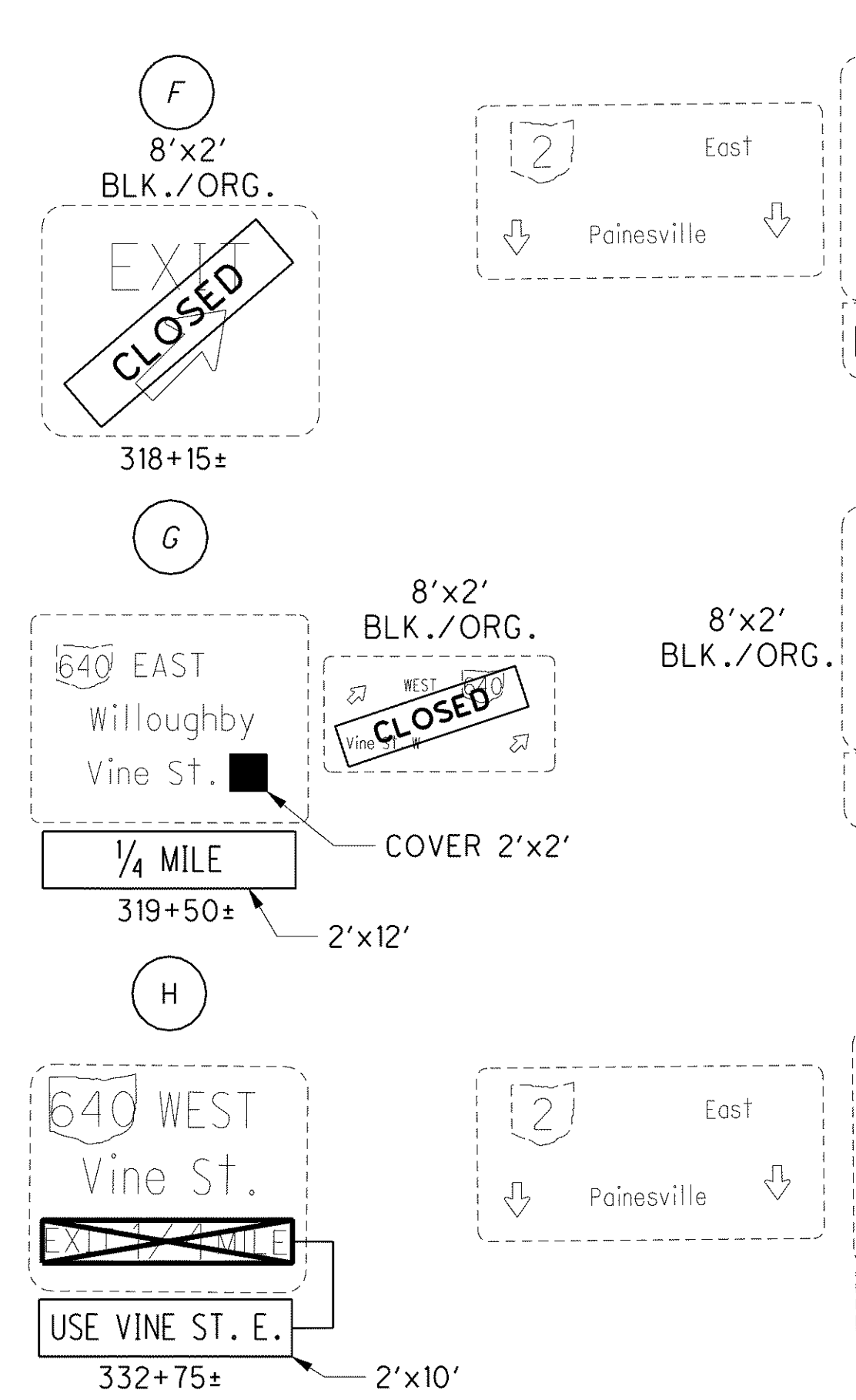
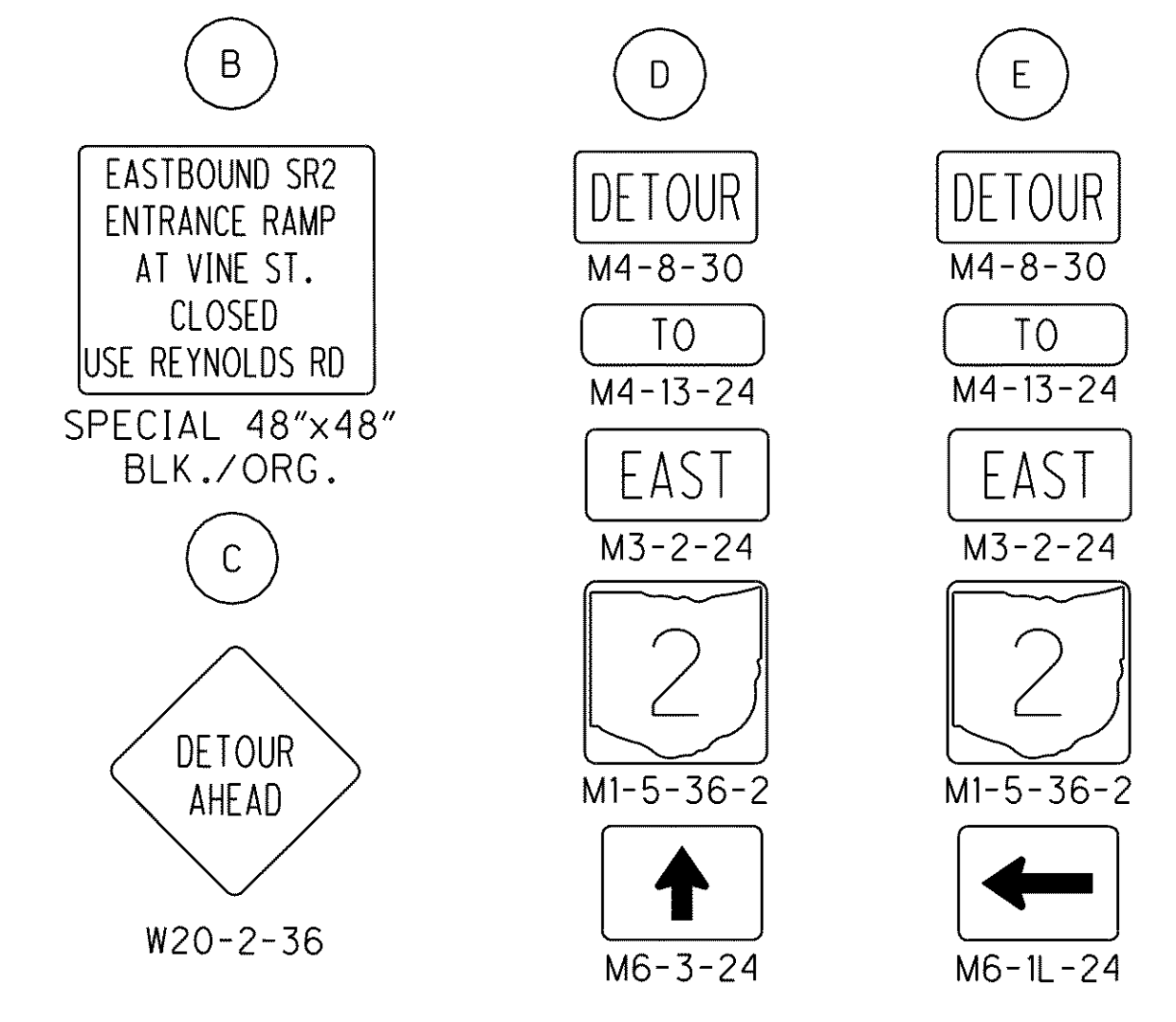

PORTABLE CHANGEABLE MESSAGE SIGN (PCMS)

G:\Project\lak\13486\mot\sheets\13486md02A.dgn 6/24/2008 12:48:05 PM djozly