

o:\project\lak\13486\mot\sheets\13486MPS3-B7.dgn 6/23/2008 11:11:43 AM jmoderia

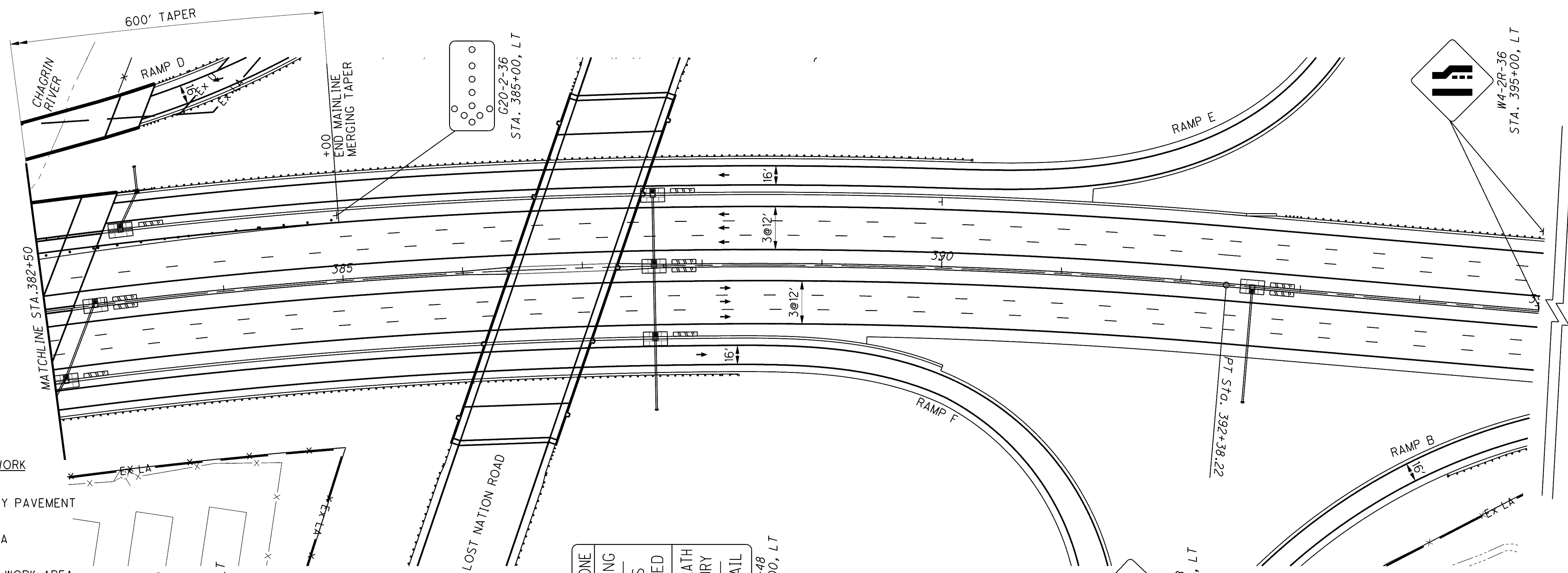

LEGEND OF WORK

- TEMPORARY PAVEMENT
- WORK AREA
- SHOULDER WORK AREA
- IMPACT ATTENUATOR
- EXFILTRATION TRENCH

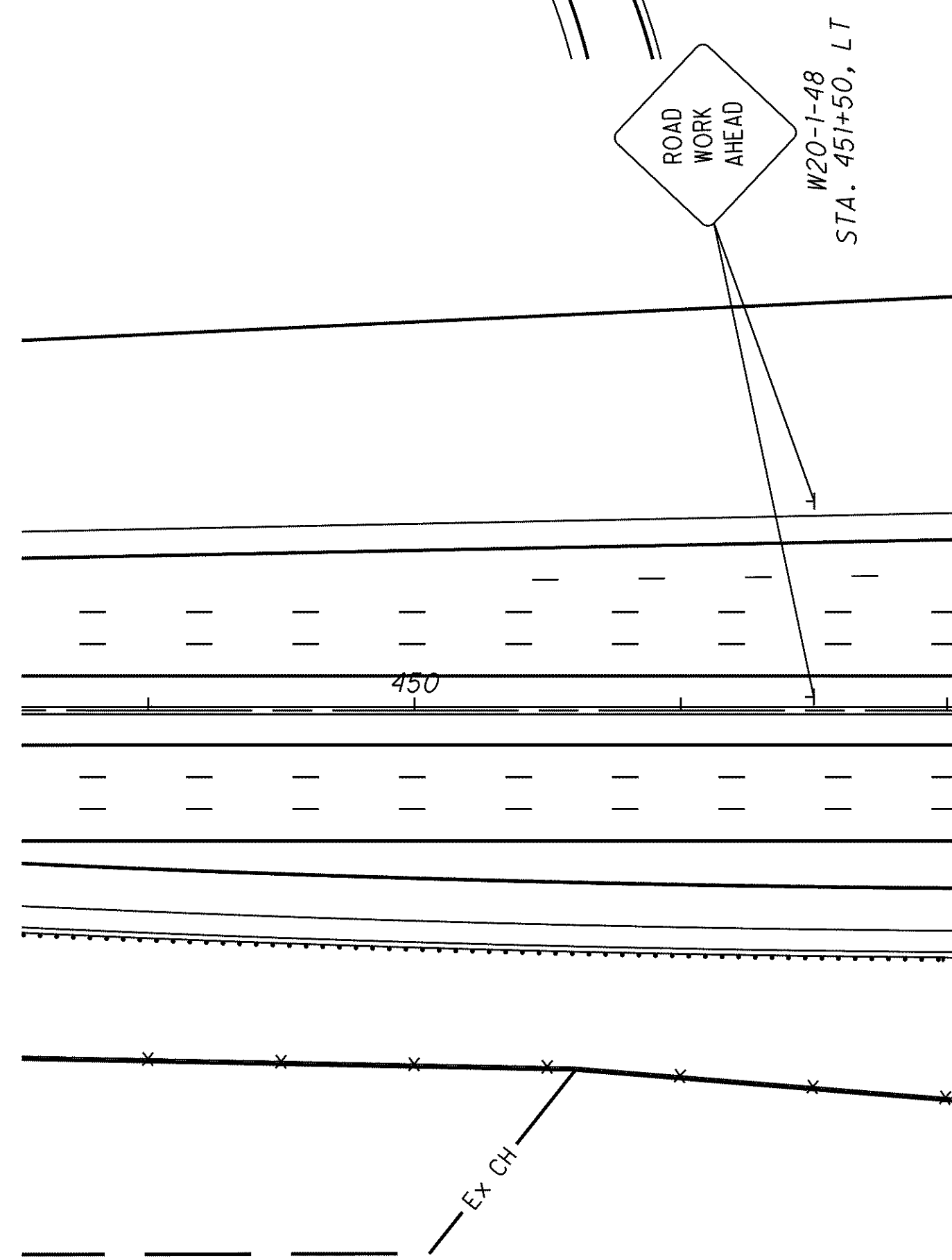
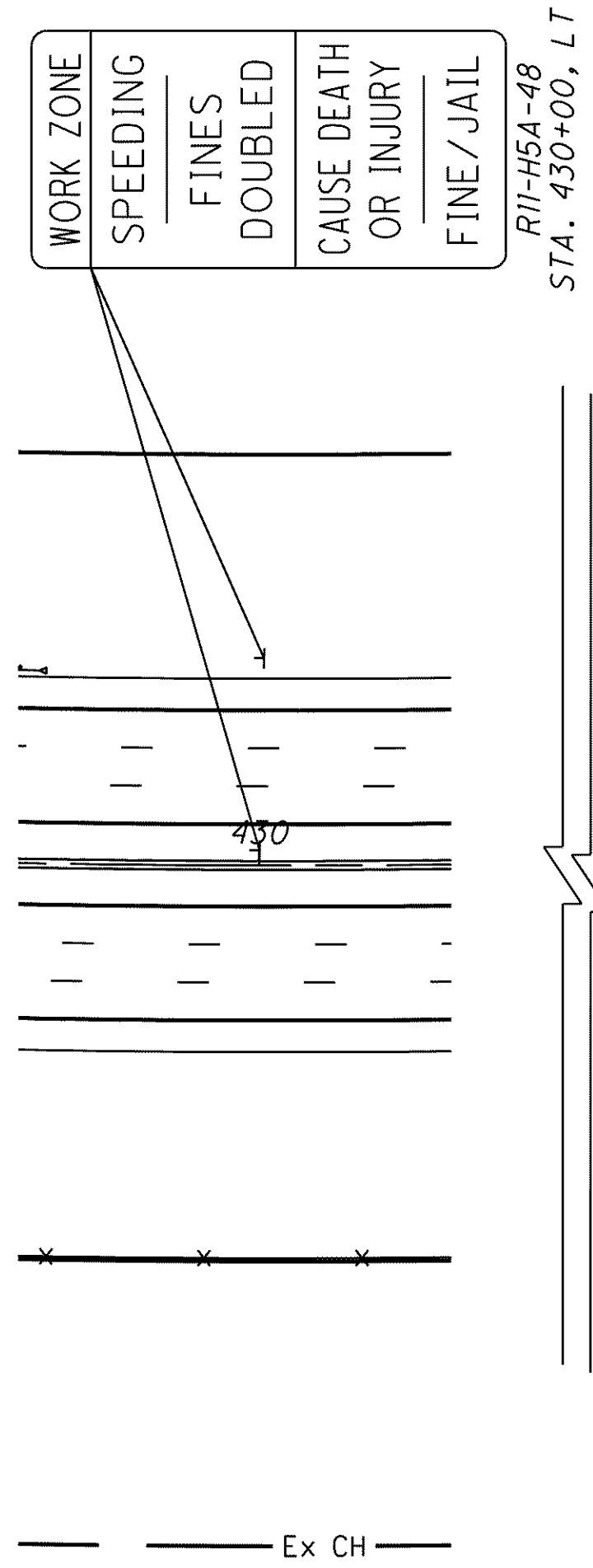
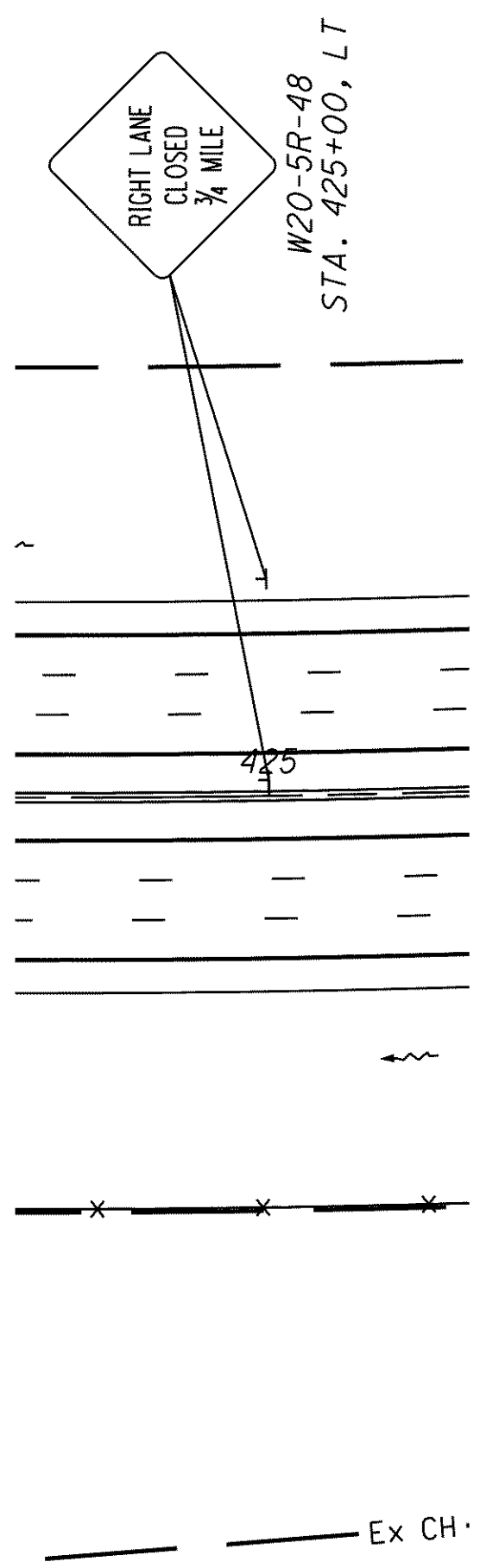
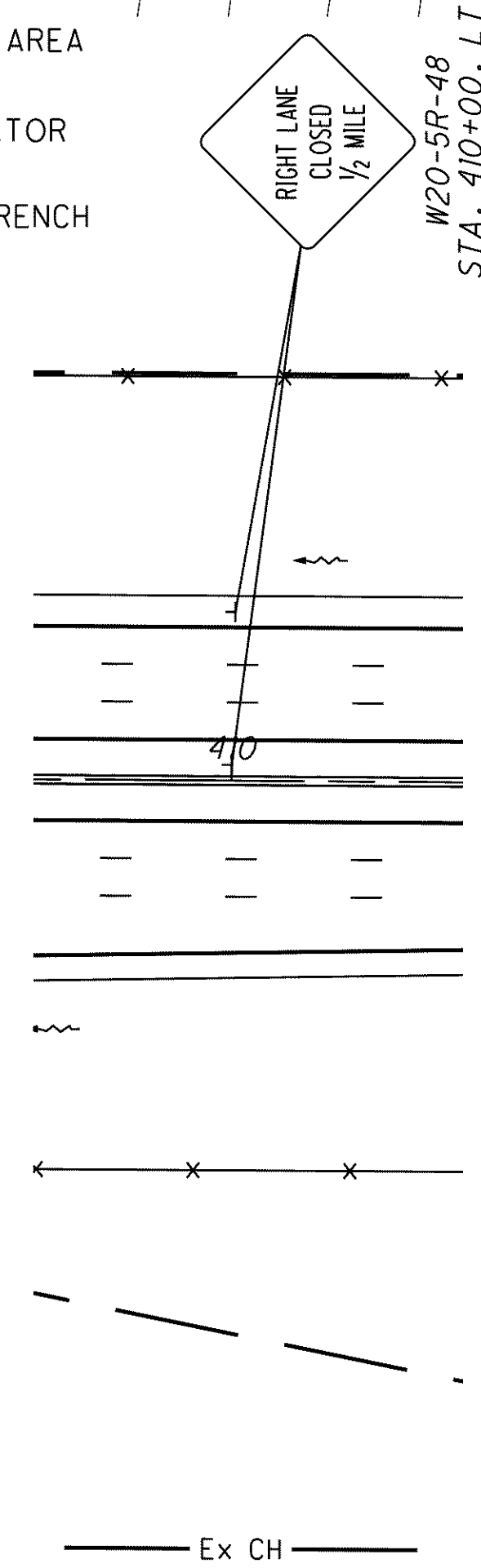

END ROAD WORK, SPEED REDUCTION & WORK ZONE SPEED LIMIT SIGNS ON THE WEST SIDE OF THE WORK ZONE SHALL BE PLACED IN ACCORDANCE WITH STAGE 2 AND STAGE 3 SHEETS 113 TO 145.

NOTE: 1. FOR PAVEMENT MARKING LEGEND SEE SHEET 56
2. ALL EXISTING SIGNS TO REMAIN UNLESS OTHERWISE SHOWN, THE CONTRACTOR SHALL KEEP ALL EXISTING SIGNS VISIBLE DURING CONSTRUCTION.

LAK-2-3.32

MAINTENANCE OF TRAFFIC - S.R. 2 STAGE 3
PHASE B - STA. 382+50 TO STA. 435+50

152
1679

CALCULATED DRJ TMD

0 50 100
25
HORIZONTAL SCALE IN FEET