

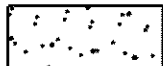

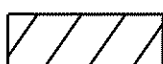

NOTE: 1. FOR PAVEMENT MARKING LEGEND SEE SHEET 56
 2. ALL EXISTING SIGNS TO REMAIN UNLESS OTHERWISE SHOWN, THE CONTRACTOR SHALL KEEP ALL EXISTING SIGNS VISIBLE DURING CONSTRUCTION.

ENTRANCE RAMP SIGNING PER MT-98.16

ENTRANCE RAMP SIGNING PER MT-98.10

- LEGEND OF WORK
-  TEMPORARY PAVEMENT
 -  WORK AREA
 -  SHOULDER WORK AREA
 -  IMPACT ATTENUATOR
 -  EXFILTRATION TRENCH

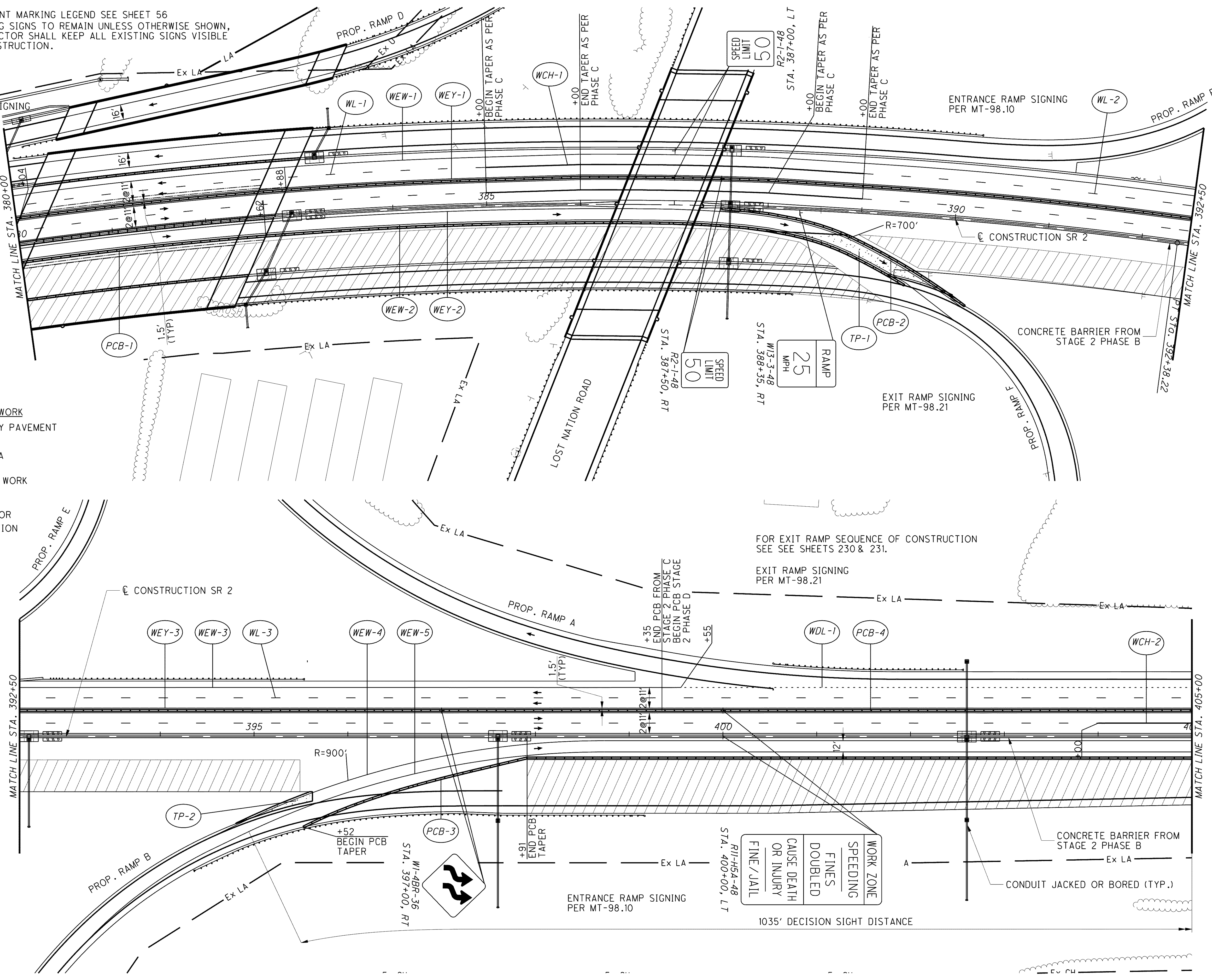

FOR EXIT RAMP SEQUENCE OF CONSTRUCTION SEE SHEETS 230 & 231.

EXIT RAMP SIGNING PER MT-98.21

WORK ZONE
SPEEDING
FINES DOUBLED
CAUSE DEATH OR INJURY
FINE / JAIL

1035' DECISION SIGHT DISTANCE

CALCULATED JMM
 CHECKED DRJ

0 50 100
 HORIZONTAL SCALE IN FEET

**MAINTENANCE OF TRAFFIC - S.R. 2 STAGE 2
 PHASE D - STA. 380+00 TO STA. 405+00**

LAK-2-3.32

o:\project\lak\13486\mot\sheet\13486MPS2-D3.dgn 6/23/2008 11:07:04 AM jmadaria