

NOTE: 1. FOR PAVEMENT MARKING LEGEND SEE SHEET 56  
 2. ALL EXISTING SIGNS TO REMAIN UNLESS OTHERWISE SHOWN, THE CONTRACTOR SHALL KEEP ALL EXISTING SIGNS VISIBLE DURING CONSTRUCTION.

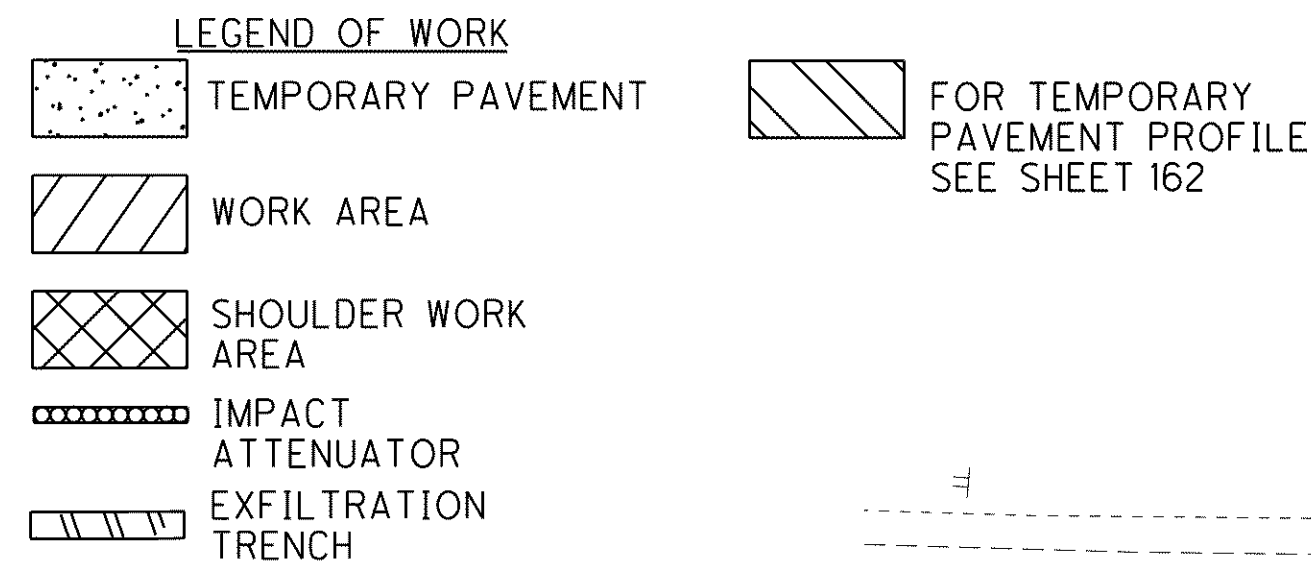

END ROAD WORK, SPEED REDUCTION & WORK ZONE SPEED LIMIT SIGNS SHALL BE PLACED IN ACCORDANCE WITH STAGE 3 SHEETS 146 TO 159 ON THE WEST SIDE OF THE WORK ZONE AND STAGE 2 SHEETS 113 TO 130 ON THE EAST SIDE OF THE WORK ZONE.

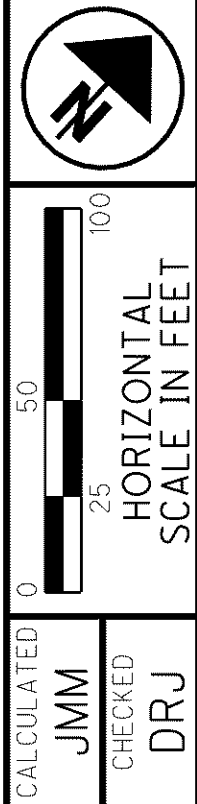
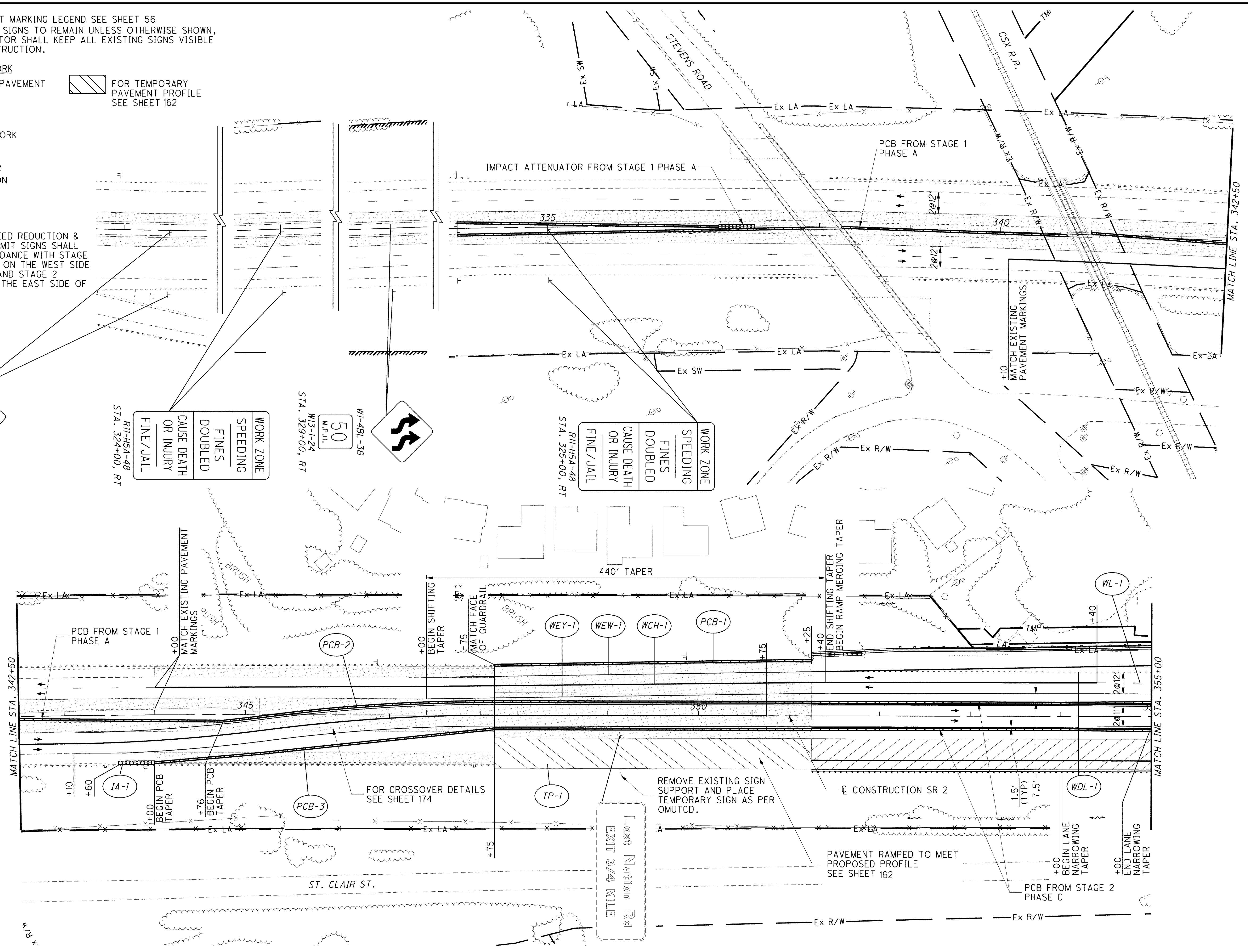
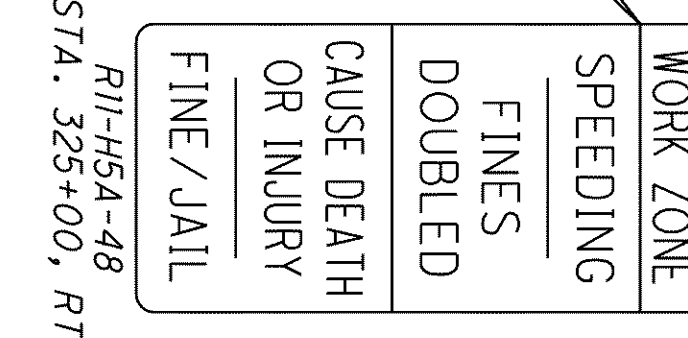
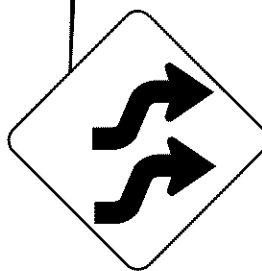
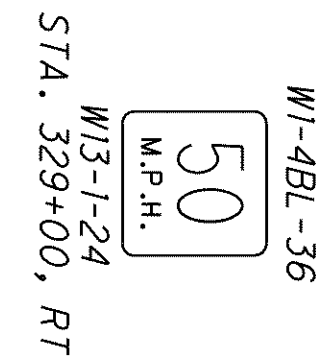
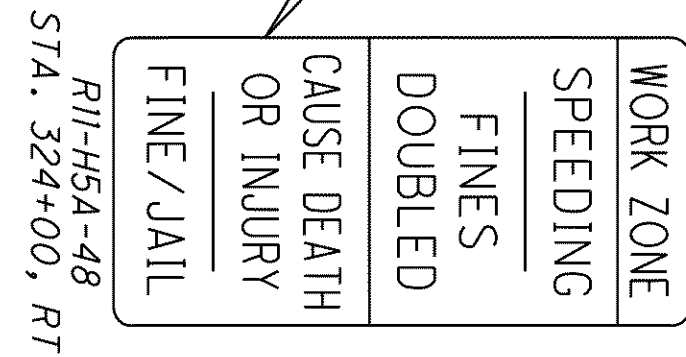
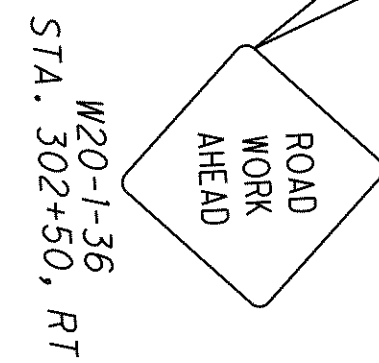

**MAINTENANCE OF TRAFFIC - S.R. 2 STAGE 2  
 PHASE D - 302+50 TO STA. 355+00**

**LAK-2-3.32**

o:\project\lak\13486\mot\sheet\13486MPS2-D1.dgn 6/23/2008 11:05:56 AM jmadaria