

NOTE: 1. FOR PAVEMENT MARKING LEGEND SEE SHEET 56
 2. ALL EXISTING SIGNS TO REMAIN UNLESS OTHERWISE SHOWN, THE CONTRACTOR SHALL KEEP ALL EXISTING SIGNS VISIBLE DURING CONSTRUCTION.

- LEGEND OF WORK
- TEMPORARY PAVEMENT
 - WORK AREA
 - SHOULDER WORK AREA
 - IMPACT ATTENUATOR
 - EXFILTRATION TRENCH

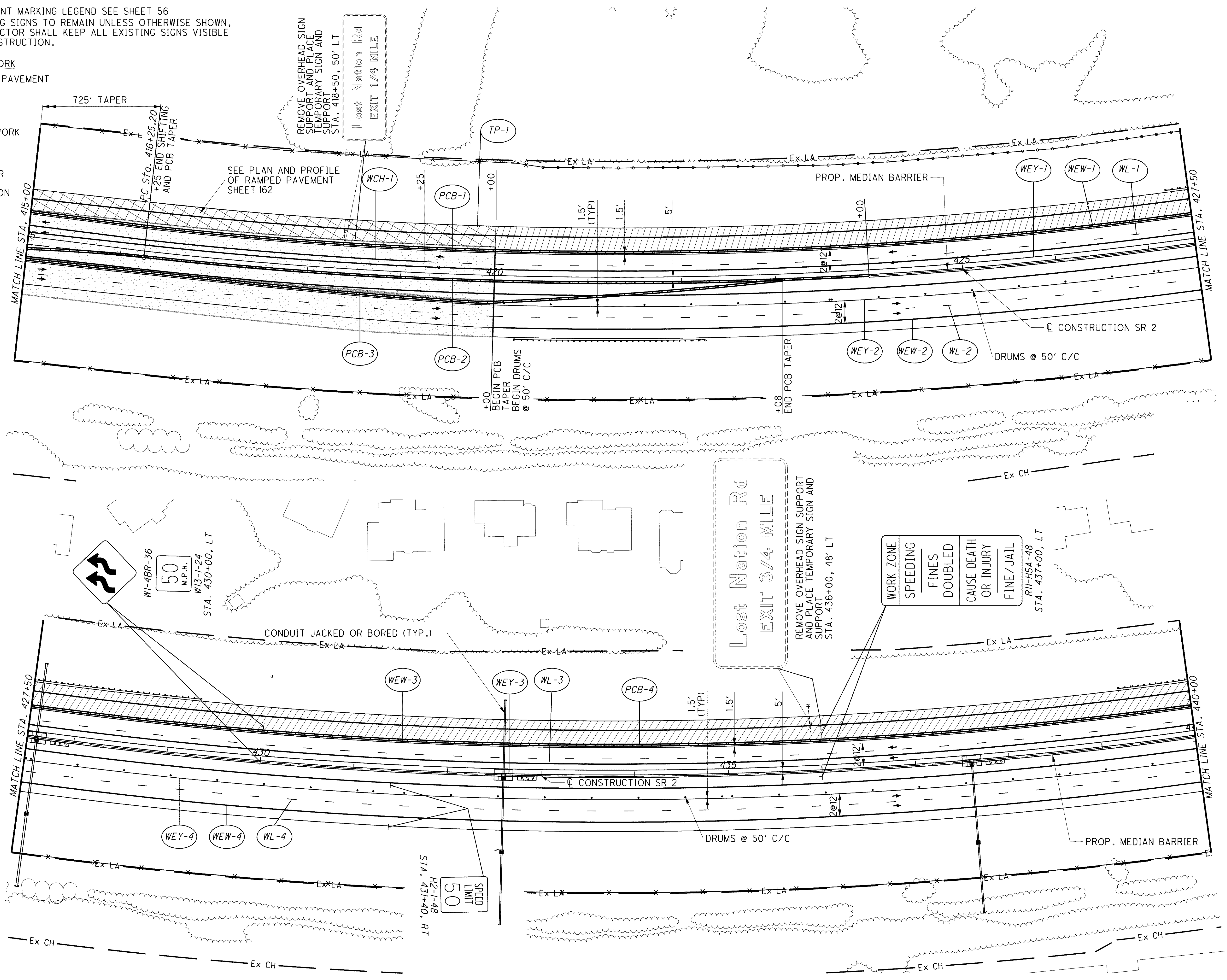

REMOVE OVERHEAD SIGN SUPPORT AND PLACE TEMPORARY SIGN AND SUPPORT STA. 418+50, 50' LT
 Lost Nation Rd
 EXIT 1/4 MILE

Lost Nation Rd
 EXIT 3/4 MILE
 REMOVE OVERHEAD SIGN SUPPORT AND PLACE TEMPORARY SIGN AND SUPPORT STA. 436+00, 48' LT

WORK ZONE
 SPEEDING
 FINES DOUBLED
 CAUSE DEATH OR INJURY
 FINE/JAIL
 R11-H54-48
 STA. 437+00, LT

SPEED LIMIT
 50
 R2-1-48
 STA. 431+40, RT

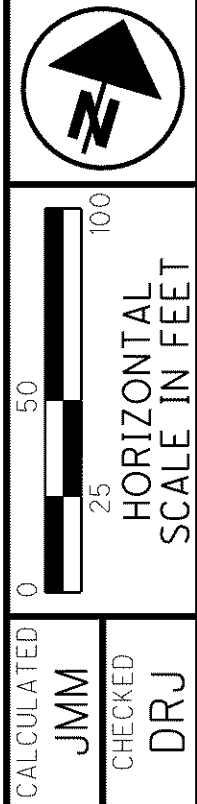

MAINTENANCE OF TRAFFIC - S.R. 2 STAGE 1
 PHASE D - STA. 415+00 TO STA. 440+00

LAK-2-3.32

o:\project\lak\13486\mot\sheet\13486MPS1-D2.dgn 6/23/2008 10:58:44 AM jmoderia