

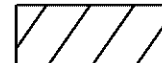



NOTE: 1. FOR PAVEMENT MARKING LEGEND SEE SHEET 56
 2. ALL EXISTING SIGNS TO REMAIN UNLESS OTHERWISE SHOWN, THE CONTRACTOR SHALL KEEP ALL EXISTING SIGNS VISIBLE DURING CONSTRUCTION.

- LEGEND OF WORK
-  TEMPORARY PAVEMENT
 -  WORK AREA
 -  SHOULDER WORK AREA
 -  IMPACT ATTENUATOR
 -  EXFILTRATION TRENCH

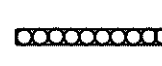

THE CONTRACTOR SHALL PLACE CROSS OVER PAVEMENT AS PER DETAIL SHEET 169. CONSTRUCTION ADJACENT TO THE EXISTING LANE SHALL TAKE PLACE IN ACCORDANCE WITH THE PERMITTED LANE CLOSURE NOTE SHEET 48 AND TRAFFIC SHALL BE MAINTAINED PER MT-95.40

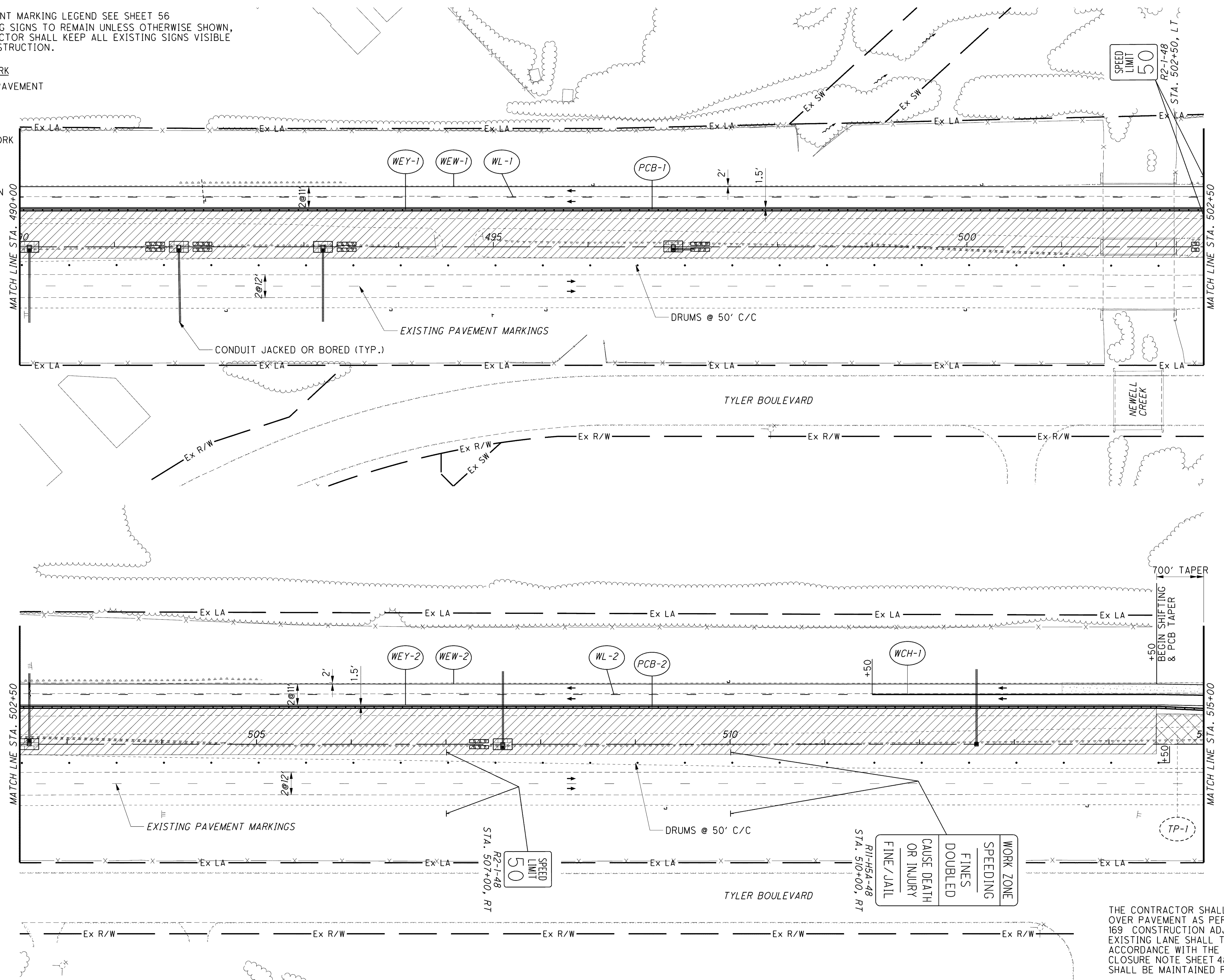
CALCULATED JMM
 CHECKED DRJ

0 25 50 100
 HORIZONTAL SCALE IN FEET

**MAINTENANCE OF TRAFFIC - S.R. 2 STAGE 1
 PHASE B - STA. 490+00 TO STA. 515+00**

LAK-2-3.32

o:\project\lak\13486\mot\sheet\13486MPS1-B5.dgn 6/23/2008 10:53:23 AM jmadaria