

- NOTE: 1. FOR PAVEMENT MARKING LEGEND SEE SHEET 56
 2. ALL EXISTING SIGNS TO REMAIN UNLESS OTHERWISE SHOWN, THE CONTRACTOR SHALL KEEP ALL EXISTING SIGNS VISIBLE DURING CONSTRUCTION.
 3. ALL WORK SHALL BE DONE IN ACCORDANCE WITH THE PERMITTED LANE CLOSURE MAP NOTE ON SHEET 48
 4. THE OPEN TRENCHES SHALL BE PROTECTED IN THE DIRECTION OF TRAVEL WITH A TRUCK WITH AN ATTACHED IMPACT ATTENUATOR IN ACCORDANCE WITH THE OMTCD.

LEGEND OF WORK

-  TEMPORARY PAVEMENT
-  WORK AREA
-  SHOULDER WORK AREA

IMPACT ATTENUATOR

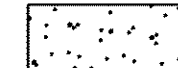
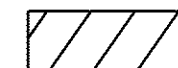
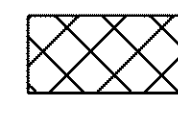
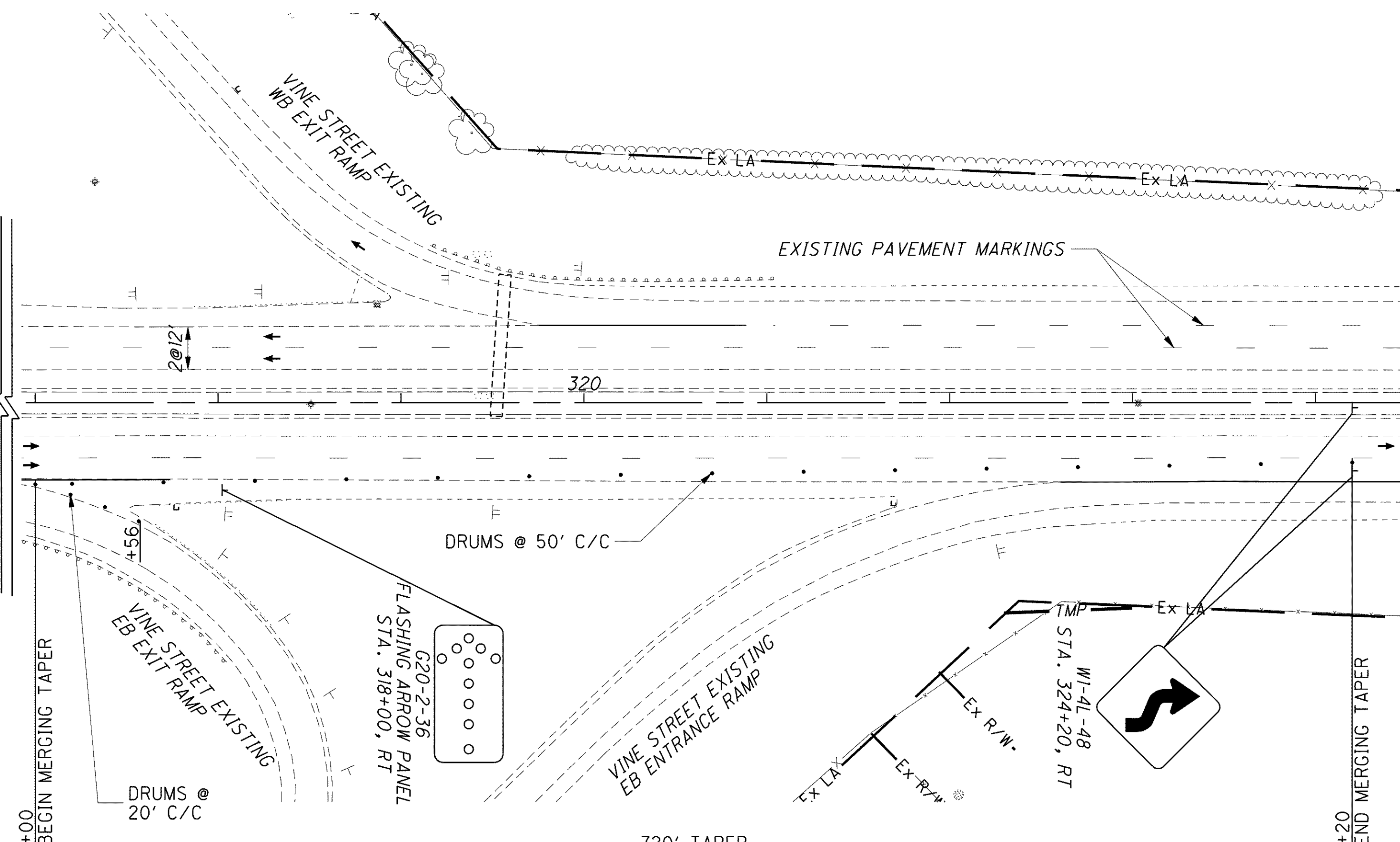
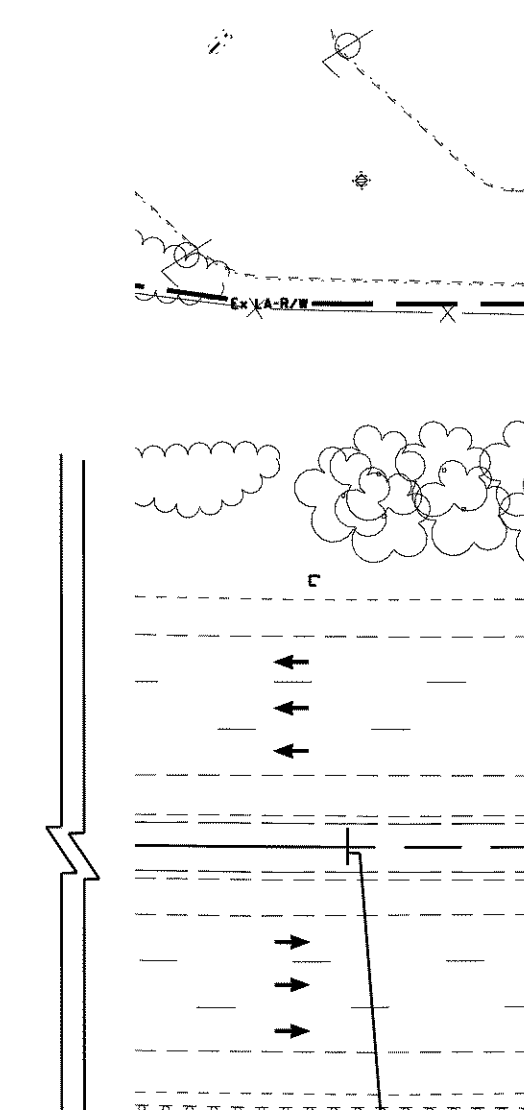
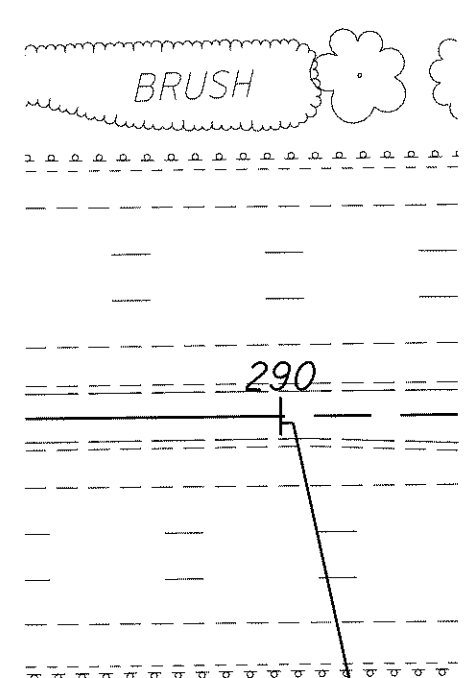
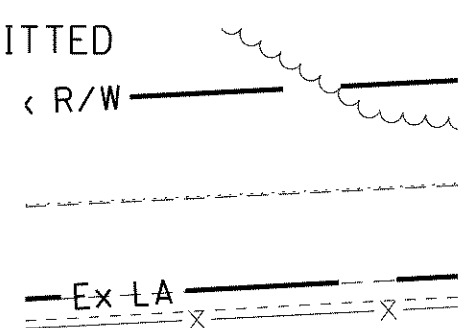
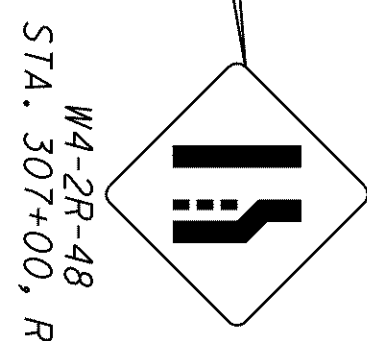
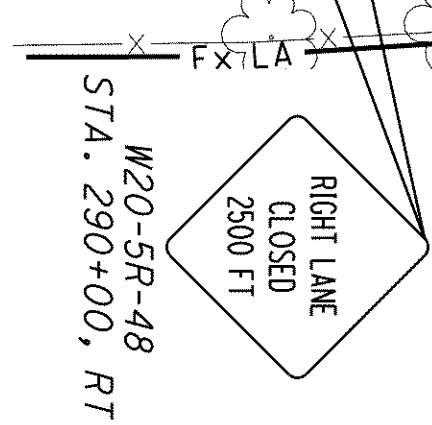
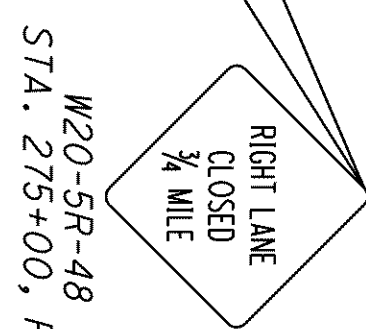
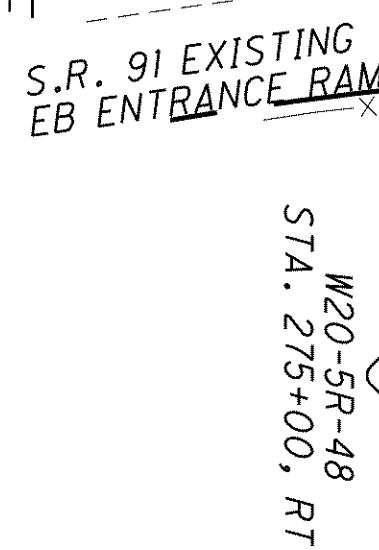
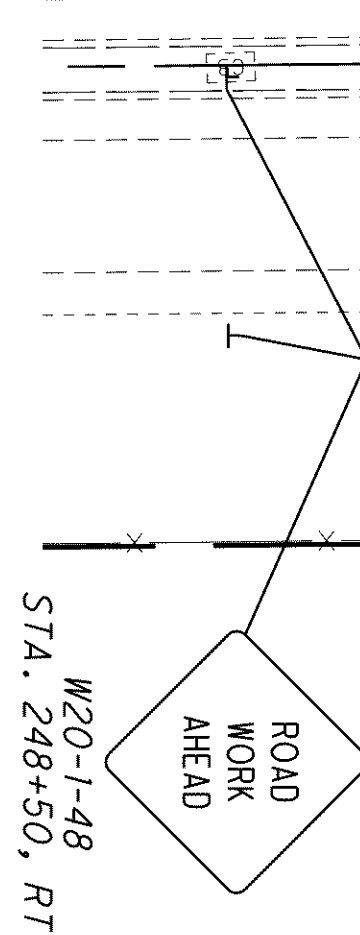

VINE STREET EB ENTRANCE RAMP CLOSED
 INTERSECTION SIGNING PER MT-101.60

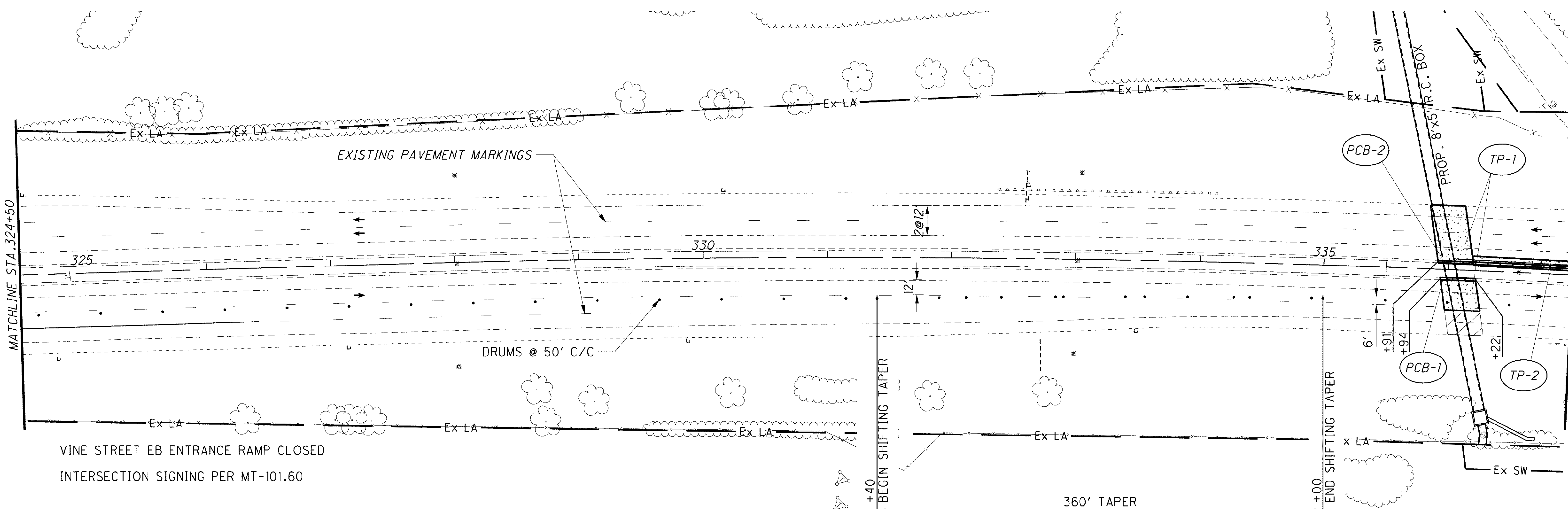

VINE STREET EB ENTRANCE RAMP CLOSED
 INTERSECTION SIGNING PER MT-101.60

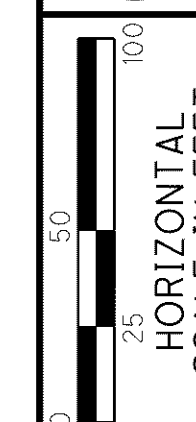

CALCULATED DRJ
 CHECKED TMD

MAINTENANCE OF TRAFFIC - S.R. 2 STAGE 1
 PHASE A STEP 3 - STA. 248+50 TO STA. 337+00

LAK-2-3.32
 107
 1679