



150  
75  
300  
HORIZONTAL  
SCALE IN FEET

CALCULATED  
AGH  
CHECKED  
PSB

**SCHEMATIC PLAN  
LOST NATION INTERCHANGE**

**LAK-2-3.32**

7  
1679

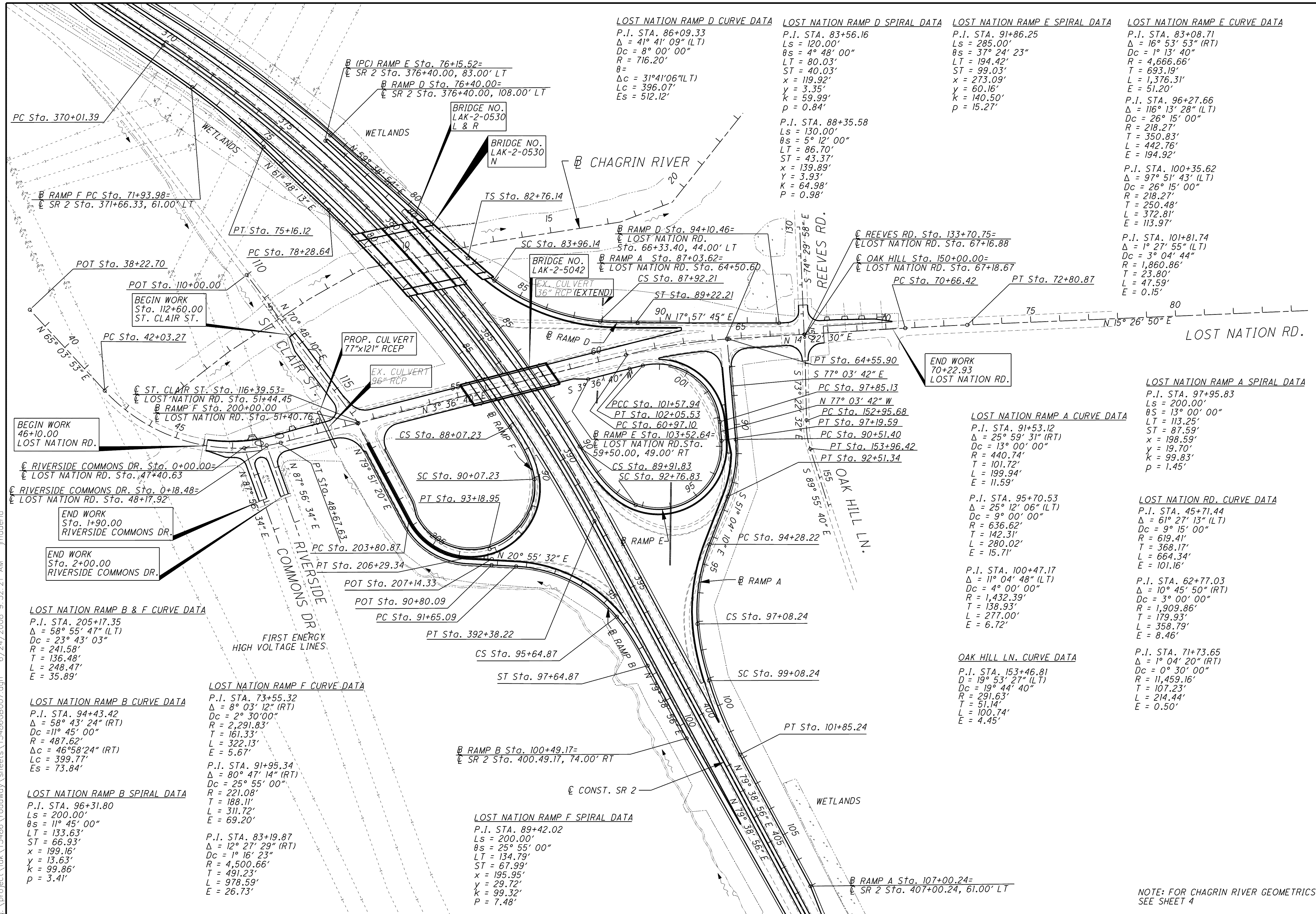

**LOST NATION RAMP D CURVE DATA**  
P.I. STA. 86+09.33  
 $\Delta = 41^\circ 41' 09''$  (LT)  
 $D_c = 8^\circ 00' 00''$   
 $R = 716.20'$   
 $\Delta_c = 31^\circ 41' 06''$  (LT)  
 $L_c = 396.07'$   
 $E_s = 512.12'$

**LOST NATION RAMP D SPIRAL DATA**  
P.I. STA. 83+56.16  
 $L_s = 120.00'$   
 $\theta_s = 4^\circ 48' 00''$   
 $LT = 80.03'$   
 $ST = 40.03'$   
 $x = 119.92'$   
 $y = 3.35'$   
 $k = 59.99'$   
 $p = 0.84'$

**LOST NATION RAMP E SPIRAL DATA**  
P.I. STA. 91+86.25  
 $L_s = 285.00'$   
 $\theta_s = 37^\circ 24' 23''$   
 $LT = 194.42'$   
 $ST = 99.03'$   
 $x = 273.09'$   
 $y = 60.16'$   
 $k = 140.50'$   
 $p = 15.27'$

**LOST NATION RAMP E CURVE DATA**  
P.I. STA. 83+08.71  
 $\Delta = 16^\circ 53' 53''$  (RT)  
 $D_c = 1^\circ 13' 40''$   
 $R = 4,666.66'$   
 $T = 693.19'$   
 $L = 1,376.31'$   
 $E = 51.20'$

P.I. STA. 96+27.66  
 $\Delta = 116^\circ 13' 28''$  (LT)  
 $D_c = 26^\circ 15' 00''$   
 $R = 218.27'$   
 $T = 350.83'$   
 $L = 442.76'$   
 $E = 194.92'$

P.I. STA. 100+35.62  
 $\Delta = 97^\circ 51' 43''$  (LT)  
 $D_c = 26^\circ 15' 00''$   
 $R = 218.27'$   
 $T = 250.48'$   
 $L = 372.81'$   
 $E = 113.97'$

P.I. STA. 101+81.74  
 $\Delta = 1^\circ 27' 55''$  (LT)  
 $D_c = 3^\circ 04' 44''$   
 $R = 1,860.86'$   
 $T = 23.80'$   
 $L = 47.59'$   
 $E = 0.15'$

**LOST NATION RAMP A SPIRAL DATA**  
P.I. STA. 97+95.83  
 $L_s = 200.00'$   
 $\theta_s = 13^\circ 00' 00''$   
 $LT = 113.25'$   
 $ST = 87.59'$   
 $x = 198.59'$   
 $y = 19.70'$   
 $k = 99.83'$   
 $p = 1.45'$

**LOST NATION RAMP A CURVE DATA**  
P.I. STA. 91+53.12  
 $\Delta = 25^\circ 59' 31''$  (RT)  
 $D_c = 13^\circ 00' 00''$   
 $R = 440.74'$   
 $T = 101.72'$   
 $L = 199.94'$   
 $E = 11.59'$

P.I. STA. 95+70.53  
 $\Delta = 25^\circ 12' 06''$  (LT)  
 $D_c = 9^\circ 00' 00''$   
 $R = 636.62'$   
 $T = 142.31'$   
 $L = 280.02'$   
 $E = 15.71'$

P.I. STA. 100+47.17  
 $\Delta = 11^\circ 04' 48''$  (LT)  
 $D_c = 4^\circ 00' 00''$   
 $R = 1,432.39'$   
 $T = 138.93'$   
 $L = 277.00'$   
 $E = 6.72'$

**OAK HILL LN. CURVE DATA**  
P.I. STA. 153+46.81  
 $\Delta = 19^\circ 53' 27''$  (LT)  
 $D_c = 19^\circ 44' 40''$   
 $R = 291.63'$   
 $T = 51.14'$   
 $L = 100.74'$   
 $E = 4.45'$

P.I. STA. 71+73.65  
 $\Delta = 1^\circ 04' 20''$  (RT)  
 $D_c = 0^\circ 30' 00''$   
 $R = 11,459.16'$   
 $T = 107.23'$   
 $L = 214.44'$   
 $E = 0.50'$

NOTE: FOR CHAGRIN RIVER GEOMETRICS SEE SHEET 4

6/24/2008 9:32:21 AM imaderia  
c:\project\lak\13486\roadway\sheets\13486GB007.dgn