

T.B.M. EASTBOUND BRIDGE
 NORTHWEST ROCKER BRIDGE
 SEAT ELEV. = 590.24

| | | | |
|-------------|-------|---------|---|
| FHWA REGION | STATE | PROJECT | 3 |
| 5 | OHIO | | 7 |

LAKE COUNTY
 LAK-2-16.56

BR-42-80

COMPUTED BY: B.A.C. 12/6/79
 CHECKED BY: B.B.R. 12/17/79

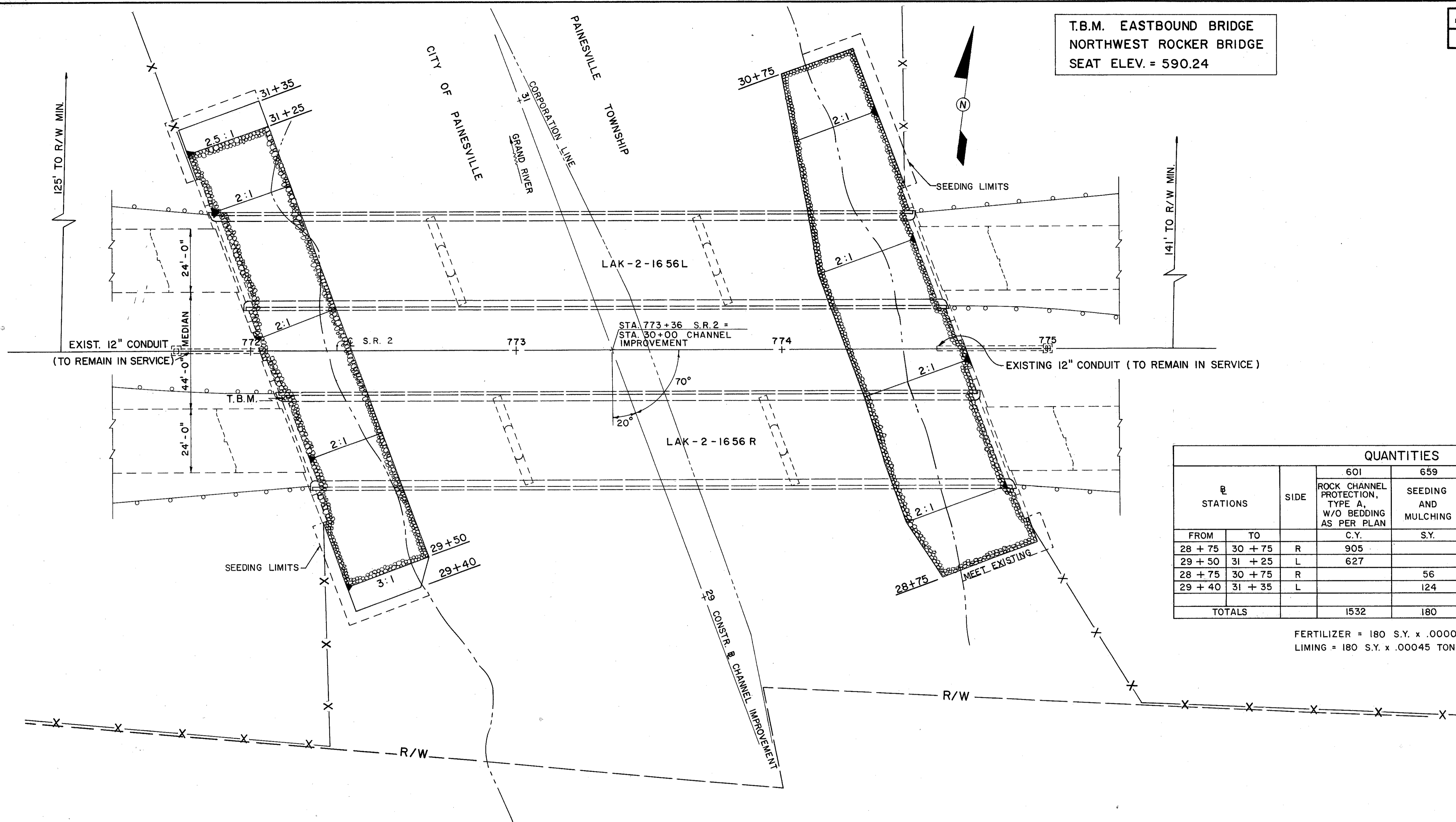

| STATIONS | | SIDE | QUANTITIES | | | |
|----------|---------|------|--|------------------------------|-------------------------------|-----------------------------|
| | | | ROCK CHANNEL PROTECTION, TYPE A, W/O BEDDING AS PER PLAN C.Y. | SEEDING AND MULCHING S.Y. | COMMERCIAL FERTILIZER TONS | AGRICULTURAL LIMING TONS |
| FROM | TO | | | | | |
| 28 + 75 | 30 + 75 | R | 905 | | | |
| 29 + 50 | 31 + 25 | L | 627 | | | |
| 28 + 75 | 30 + 75 | R | | 56 | | |
| 29 + 40 | 31 + 35 | L | | 124 | | |
| TOTALS | | | 1532 | 180 | 0.02 | .08 |

FERTILIZER = 180 S.Y. x .00009 TON/S.Y. = .02 TON
 LIMING = 180 S.Y. x .00045 TON/S.Y. = .08 TON

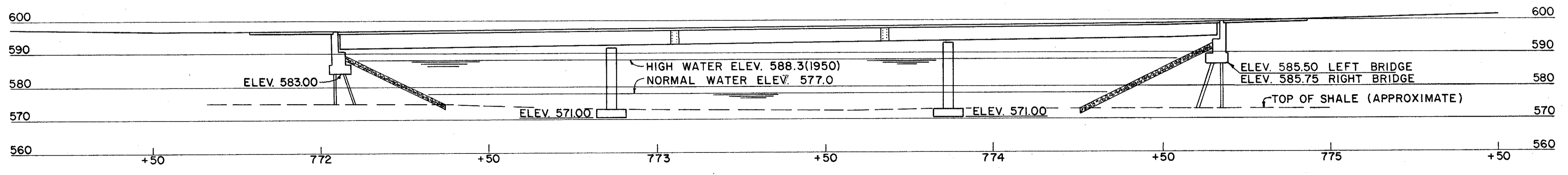

UNRECORDED
 FEB 05 1985