

REVISIONS
NOV 8 1982

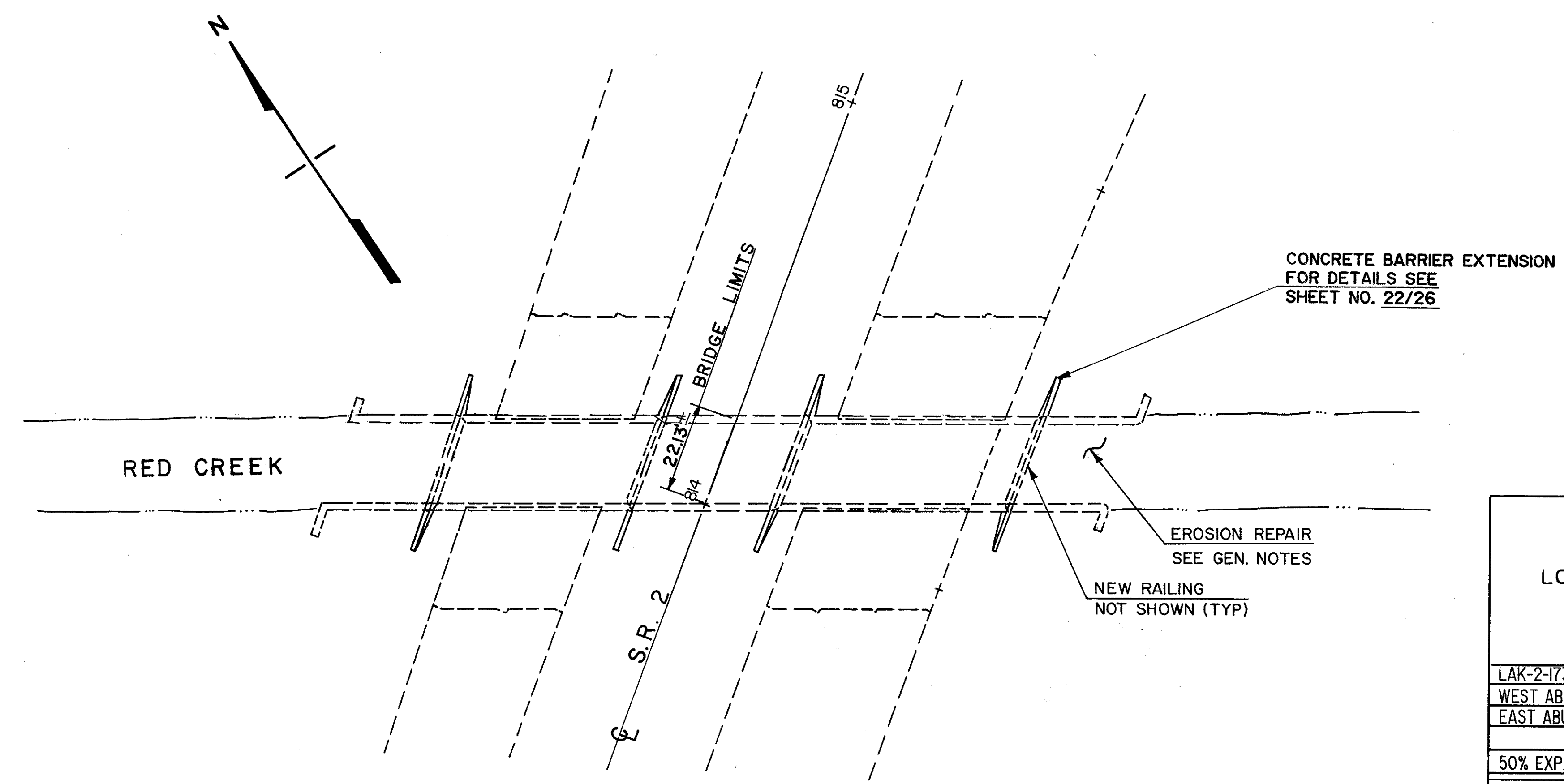

PLAN

LOCATION	519 PATCHING CONCRETE STRUCTURES AS PER PLAN SQ. FT.
LAK-2-1735 L	
WEST ABUTMENT	75
EAST ABUTMENT	2
50% EXPANSION FACTOR	40
TOTAL	117
LAK-2-1735 R	
WEST ABUTMENT	2
EAST ABUTMENT	1
50% EXPANSION FACTOR	2
TOTAL	5

SURVEY DATE 6/11/87

EXISTING STRUCTURES

TYPE: TWO SINGLE SPAN REINFORCED CONCRETE SLAB AND SUBSTRUCTURE

SPANS: 20'-0"

ROADWAY: VARIES 40'-6" MIN. TO 48'-5 1/4" MAX. F/F CURBS

LOADING: HS-20-44

WEARING SURFACE: 1" MONOLITHIC CONCRETE

ALIGNMENT: TANGENT

SKREW: 20° R.F.

- PROPOSED WORK**
- 1 1/4" LMC OVERLAY
 - PATCHING AND SEALING OF CONCRETE SURFACES *
 - INSTALLATION OF SAFETY SHAPE PARAPETS AND EXTENSION
 - SEALING TRANSVERSE EXPANSION JOINT (SEE SHT. 24/26)
 - WATERWAY CHANNEL REPAIR AND PROTECTION (SEE ROADWAY GENERAL NOTES)

* EPOXY SEAL PARAPETS AND 3' ON UNDERSIDE OF DECK EACH SIDE. SEAL ABUTMENTS FROM BRIDGE SEAT TO WATER LINE.

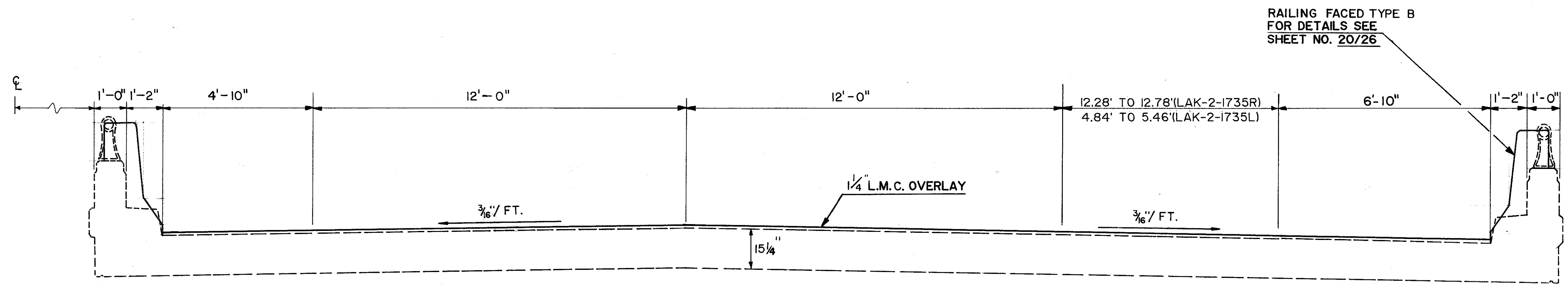

TRANSVERSE SECTION

RIGHT BRIDGE FACING EAST
LEFT BRIDGE FACING WEST

STATE OF OHIO
DEPARTMENT OF TRANSPORTATION
DISTRICT 12 LOCATION & DESIGN

GENERAL PLAN & TRANSVERSE SECTION

BR. N^os LAK-2-1735 L&R
S.R. 2 OVER RED CREEK

LAKE COUNTY OHIO

DESIGNED LNF	TRACED MRB	CHECKED	REVIEWED	REVISED
DATE	DATE	DATE	DATE	DATE

SHEET 17 / 26