

STA. 824+65 138' RT.
Std. #5 MH.
Cover 648.00
FL. 12" 642.50
FL. 36"(in) 641.54
FL. 36"(out) 641.44

STA. 824+69 150' RT.
NO. 2-2-B C.B.
GRATE 646.20
FL. 12" 642.75

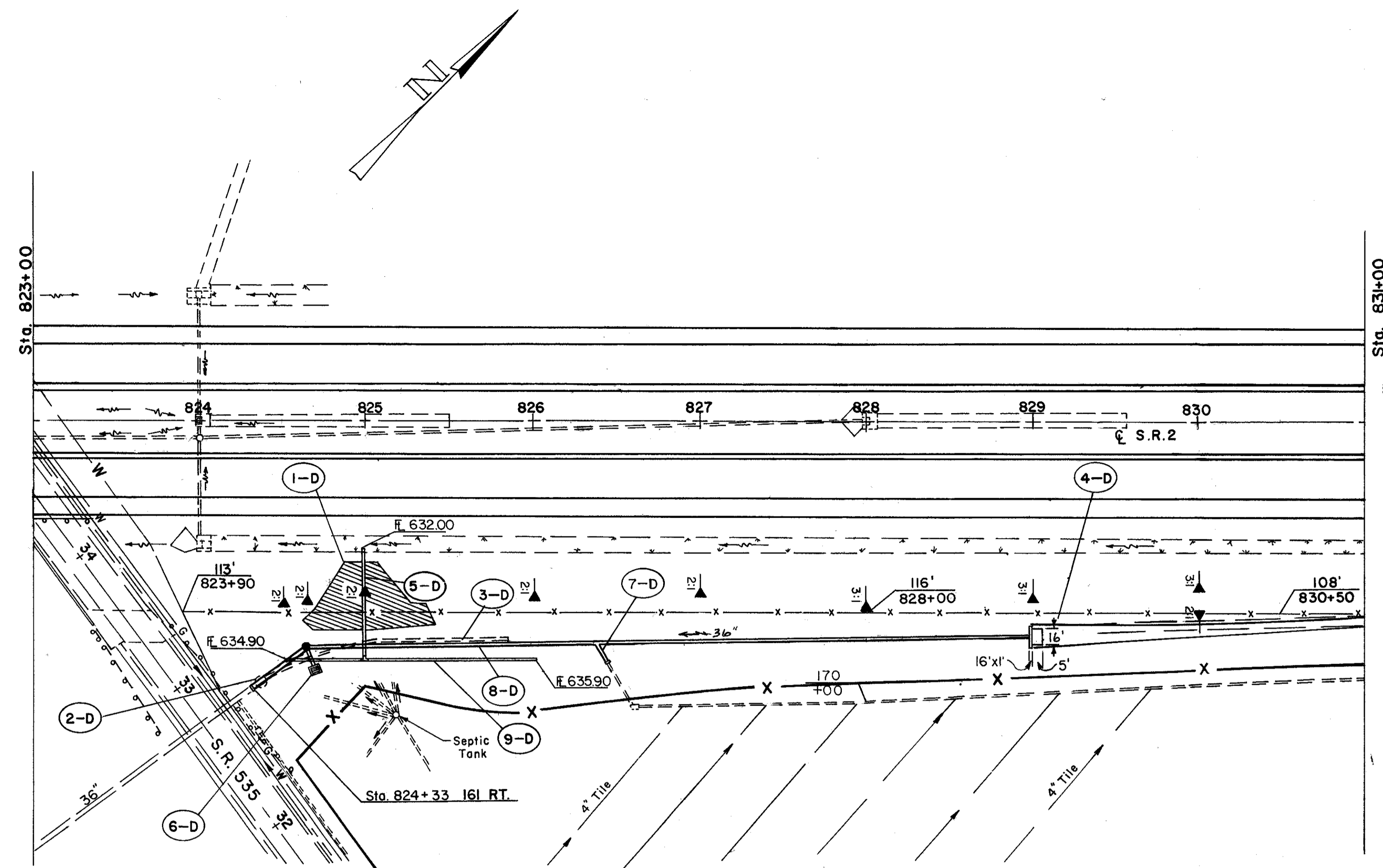

NOTE: FOR HW-1 HEADWALL DETAILS SEE SHEET NO. 39.

DRAINAGE-ESTIMATED QUANTITIES

REFERENCE NUMBER	STATION		SIDE	# AS PER PLAN										
	FROM	TO		202		601	602	603			604		605	
				MANHOLE REMOVED	24" & UNDER PIPE REMOVED	RIPRAP USING 6" R.C. SLAB	CONCRETE MASONRY	6" CONDUIT, TYPE F	12" CONDUIT, TYPE C	36" CONDUIT, TYPE C	MANHOLE NO. 5	CATCH BASIN NO. 2-2-B	6" DEEP PIPE UNDER DRAIN#	
		EACH	LIN. FT.	SQ. YD.	CU. YD.	LIN. FT.	LIN. FT.	LIN. FT.	EACH	EACH	LIN. FT.			
1-D	824+33	826+00	RT											
2-D	624+00		RT	1										
3-D	824+40	825+90	RT		150									
4-D	829+00	829+25	RT			9								
5-D	825+00		RT					66						
6-D	824+65	824+67	RT						9		1			
7-D	826+39	826+46	RT						20					
8-D	824+33	829+00	RT				7.73			480	1			
9-D	824+50	826+00	RT									150		
TOTALS:				1	150	9	7.7	66	29	480	1	1	150	

* NOTE-STUMPS, TREES, VEGETATION, AND DEBRIS SHALL BE REMOVED FROM THE SLIDE AREA PRIOR TO PLACING ITEM 203-EMBANKMENT, AS SHOWN ON THE CROSS SECTIONS ON SHEET NO. 64.

ROADWAY-ESTIMATED QUANTITIES

REF. NO.	STATION		SIDE	660
	FROM	TO		SODDING **
				SQ. YD.
	824+69	828+00	RT	110
TOTAL:				110

** TO BE PLACED IN DRAINAGE DITCH AS SHOWN ON CROSS SECTIONS