

LAKE COUNTY
LAK-2-14.38

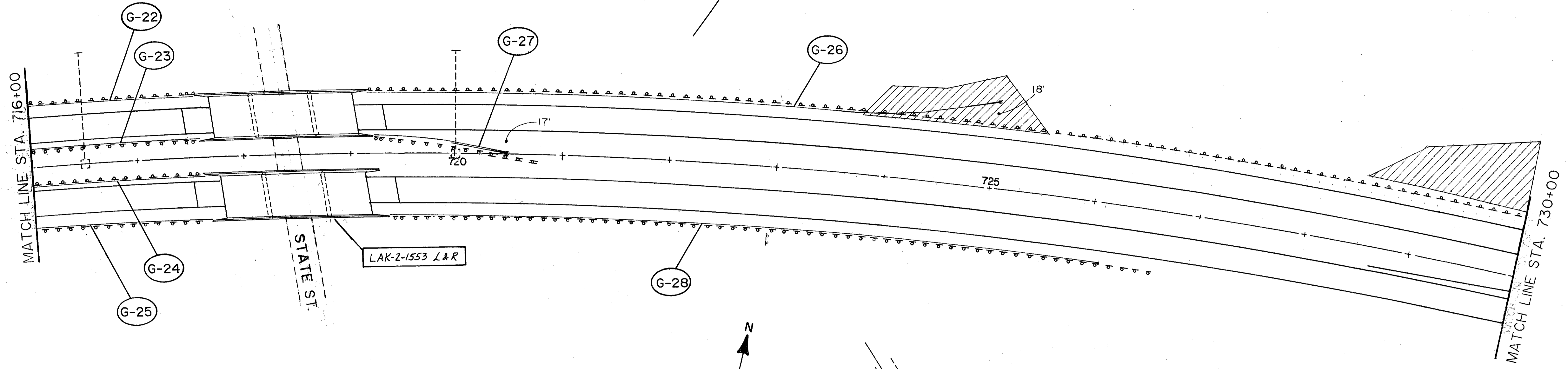

CROSS REFERENCE	
ITEM	SHEET
RESURFACING	20
GUARDRAIL	19
PAV'T MARKINGS	73
STRUCTURES	124, 125
GRADING	58, 59
CROSSOVERS	38
SIGNING	85

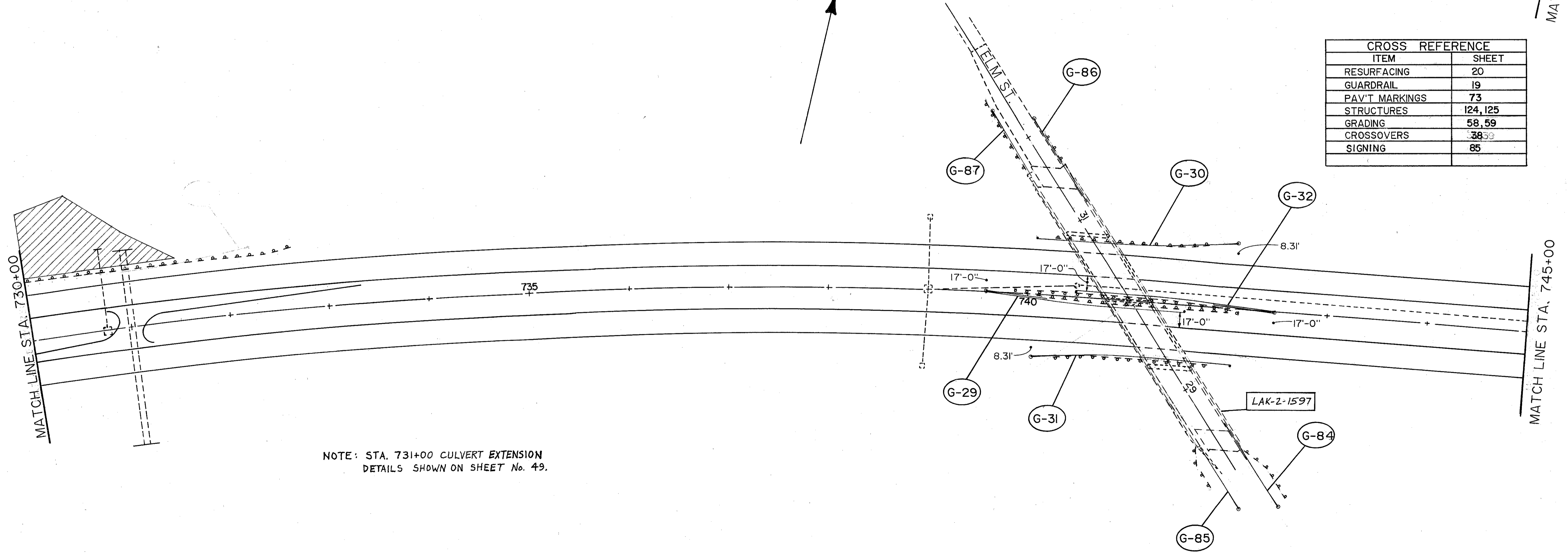

NOTE: STA. 731+00 CULVERT EXTENSION
DETAILS SHOWN ON SHEET No. 49.