

LAKE COUNTY
LAK-2-14.22

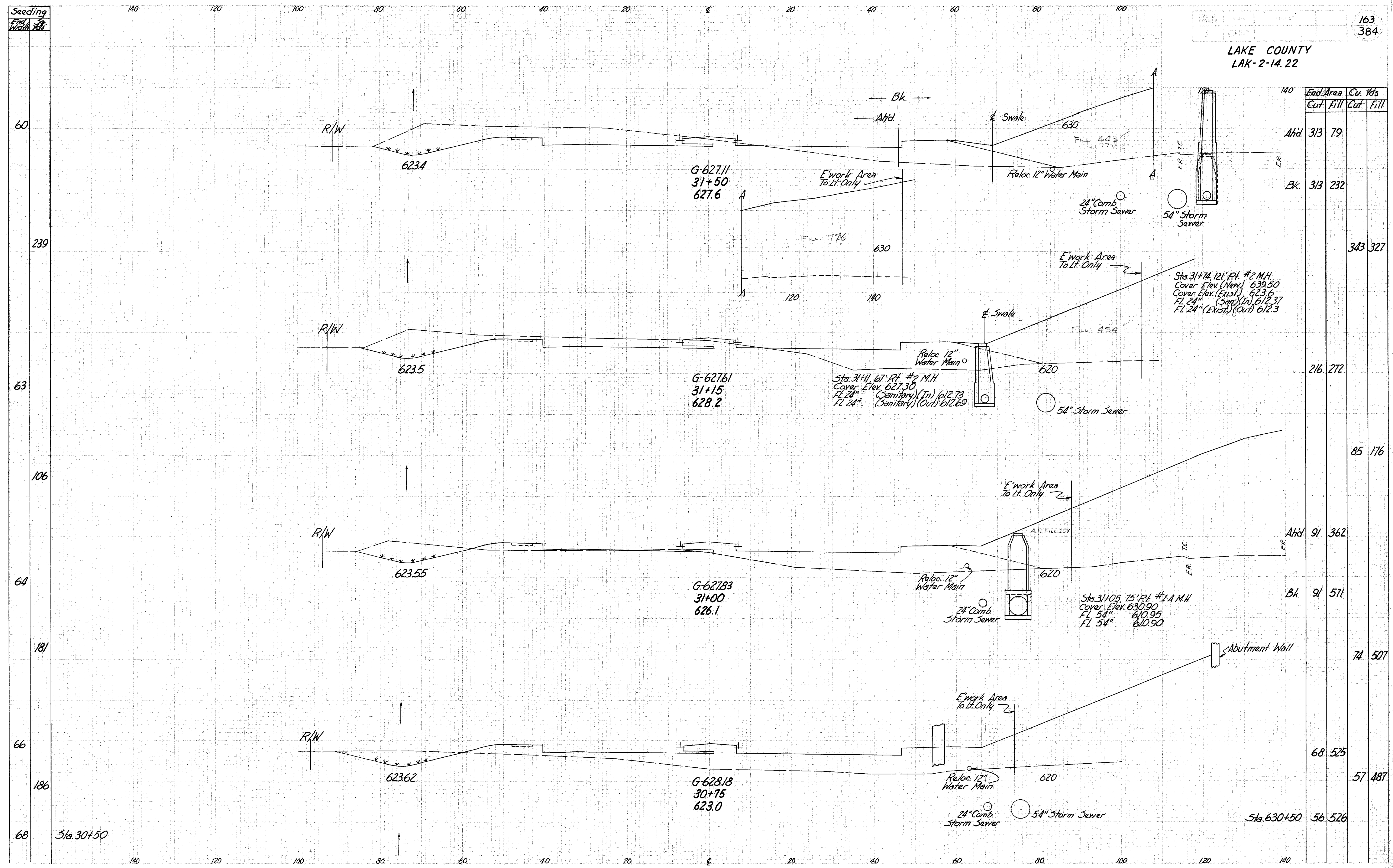

End Area	Cu. Yds	
	Cut	Fill
Abt.	313	79
Bk.	313	232
	343	327
	216	272
	85	176
Abt.	91	362
Bk.	91	571
	74	507
	68	525
	57	487
Sta. 630+50	56	526

Reloc. Richmond St. Sta. 30+75 to Sta. 31+50