

NOTE: Sta. 1+10.75 Lt. S.R. 283  
End Stabilized Crushed Aggregate  
Shoulders and Begin 30' Pavement  
Taper.

FOR PROFILES ON  
RTE. 283 & SKINNER  
AVENUE  
SEE SHEET NO. 219

FOR RICHMOND STREET  
SEWER PROFILES SEE SHEET NO. 151

STATION	WIDTH OF SODDING FT.	LENGTH OF SODDING FT.	S.Y.
10+80	8.4	120	
12+00	10.5		126

FOR JOINT & SUPERELEVATION  
DETAILS SEE SHEETS NO. 215 & 216

EXISTING TYPICAL SECTION  
RICHMOND ST (NORTH OF STAGE AVE.)

FOR LIGHTING DETAILS  
SEE SHEET NO. 273

FOR POWER ADJUSTMENTS  
SEE SHEET NO. 283

EXISTING TYPICAL SECTION  
S.R. 283

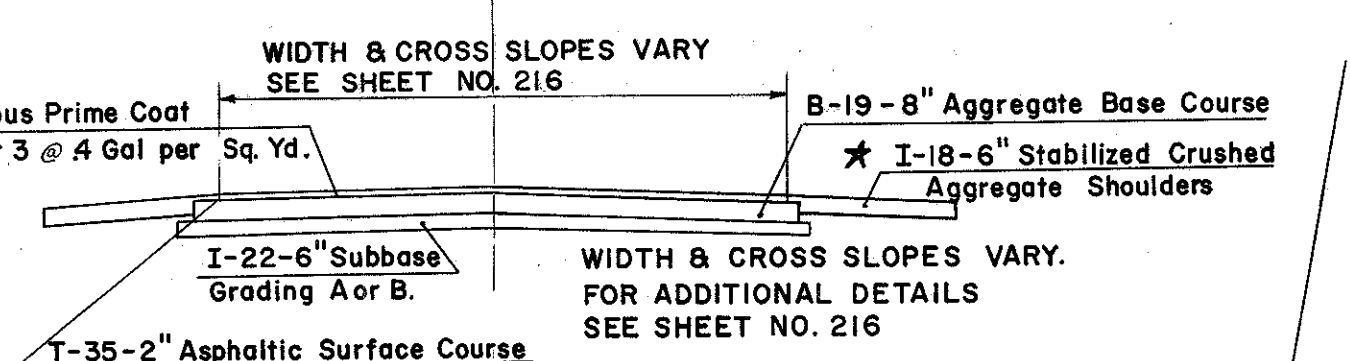

RECONSTR. S. R. 283

\* See note in Proposal for additional stabilization with Calcium Chloride in upper 3" of this item.

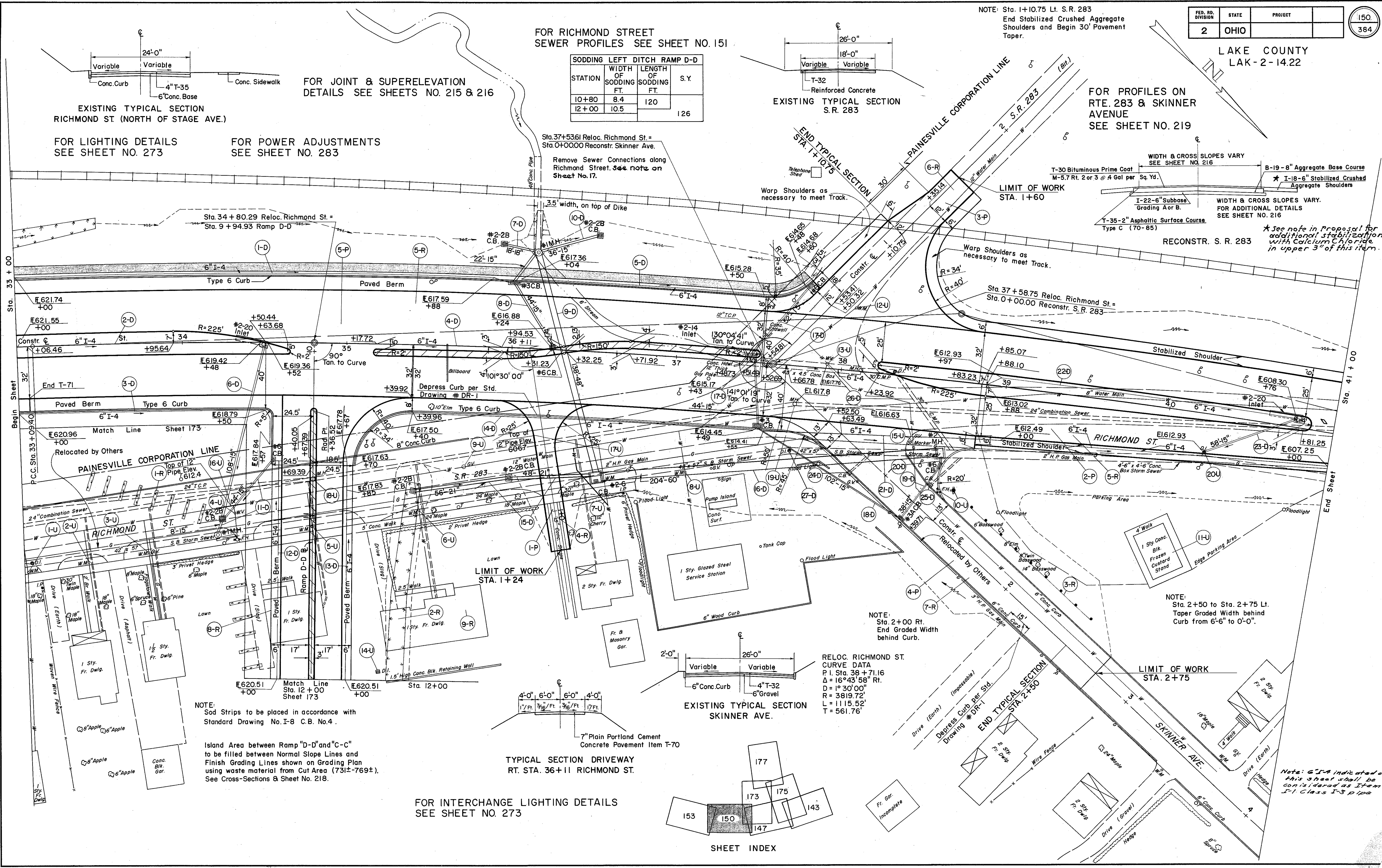

Sta. 37+536 Reloc. Richmond St =  
Sta. 0+0000 Reconstr. Skinner Ave.  
Remove Sewer Connections along  
Richmond Street. See note on  
Sheet No. 17.

Sta. 34+80.29 Reloc. Richmond St =  
Sta. 9+94.93 Ramp D-D

Sta. 37+58.75 Reloc. Richmond St =  
Sta. 0+00.00 Reconstr. S.R. 283

NOTE:  
Sod Strips to be placed in accordance with  
Standard Drawing No. I-8 C.B. No. 4.

Island Area between Ramp "D-D" and "C-C"  
to be filled between Normal Slope Lines and  
Finish Grading Lines shown on Grading Plan  
using waste material from Cut Area (73±-769±).  
See Cross-Sections & Sheet No. 218.

TYPICAL SECTION DRIVEWAY  
RT. STA. 36+11 RICHMOND ST.

FOR INTERCHANGE LIGHTING DETAILS  
SEE SHEET NO. 273

RELOC. RICHMOND ST.  
CURVE DATA  
P.I. Sta. 38+71.16  
Δ = 16°43'58" Rt.  
D = 1°30'00"  
R = 3819.72'  
L = 1115.52'  
T = 561.76'

NOTE:  
Sta. 2+00 Rt.  
End Graded Width  
behind Curb.

NOTE:  
Sta. 2+50 to Sta. 2+75 Lt.  
Taper Graded Width behind  
Curb from 6'-6" to 0'-0".

Note: 6" I-A indicated on  
this sheet shall be  
con. is idled as Item  
I-1 Class I-3 pipe

