

Seeding  
Eng. 39  
Width Yds

133  
384

LAKE COUNTY  
LAK-2-14.22

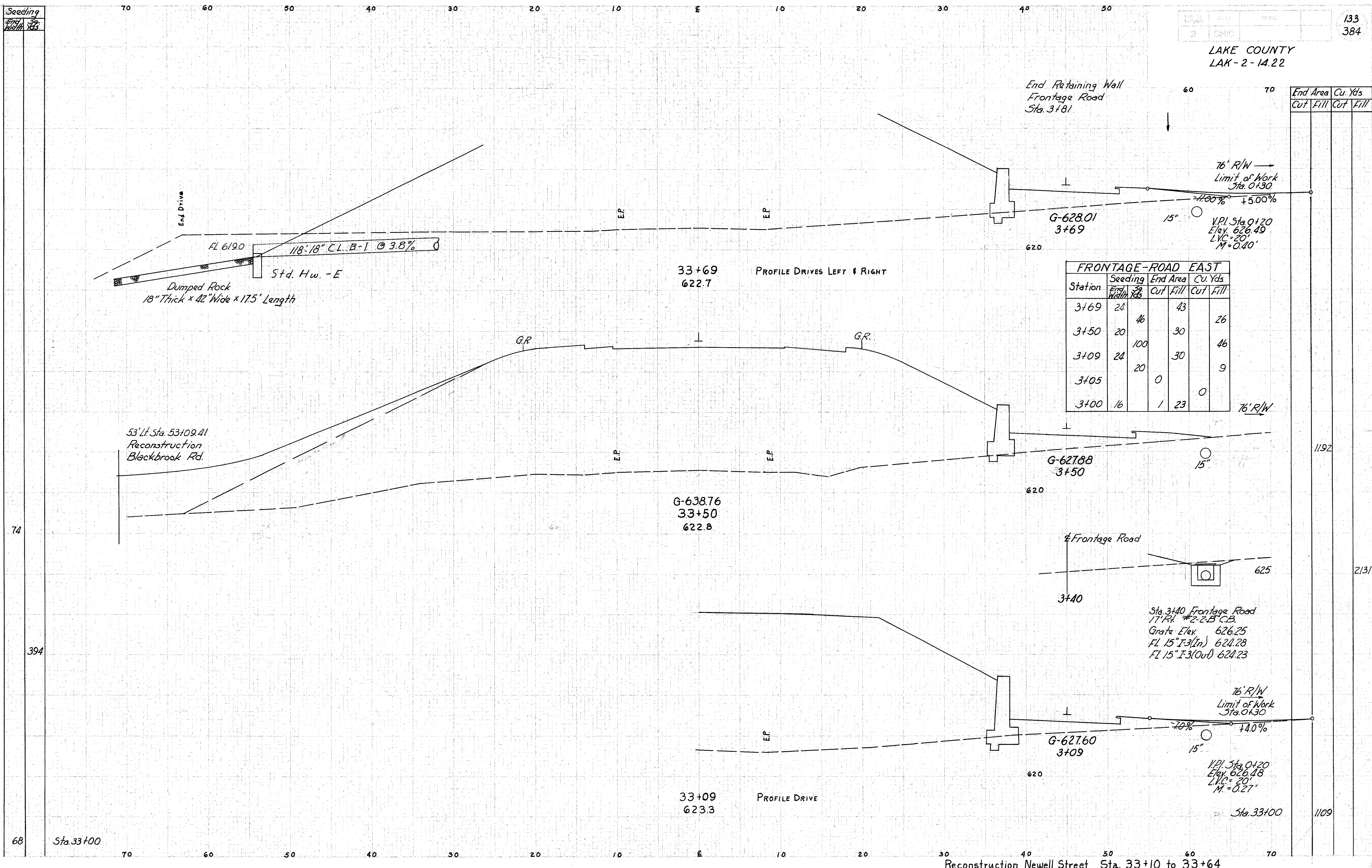

FRONTAGE-ROAD EAST

Station	Seeding		End Area		Cu. Yds	
	Eng. 39 Width	39 Yds	Cut	Fill	Cut	Fill
3+69	24		46	43		26
3+50	20		100	30		46
3+09	24		20	30		9
3+05			0	0		0
3+00	16		1	23		

Frontage Road  
3+40

Sta. 3+40 Frontage Road  
17' R/W #2-2-B C.B.  
Grate Elev. 626.25  
FL 15" I-3(In) 624.28  
FL 15" I-3(Out) 624.23

End Area		Cu. Yds	
Cut	Fill	Cut	Fill

1192

2131

1109

68 Sta. 33+00

Reconstruction Newell Street Sta. 33+10 to 33+64