

MICROFILMED  
JUL 8 1986

LAKE COUNTY  
LAK-2-14.22

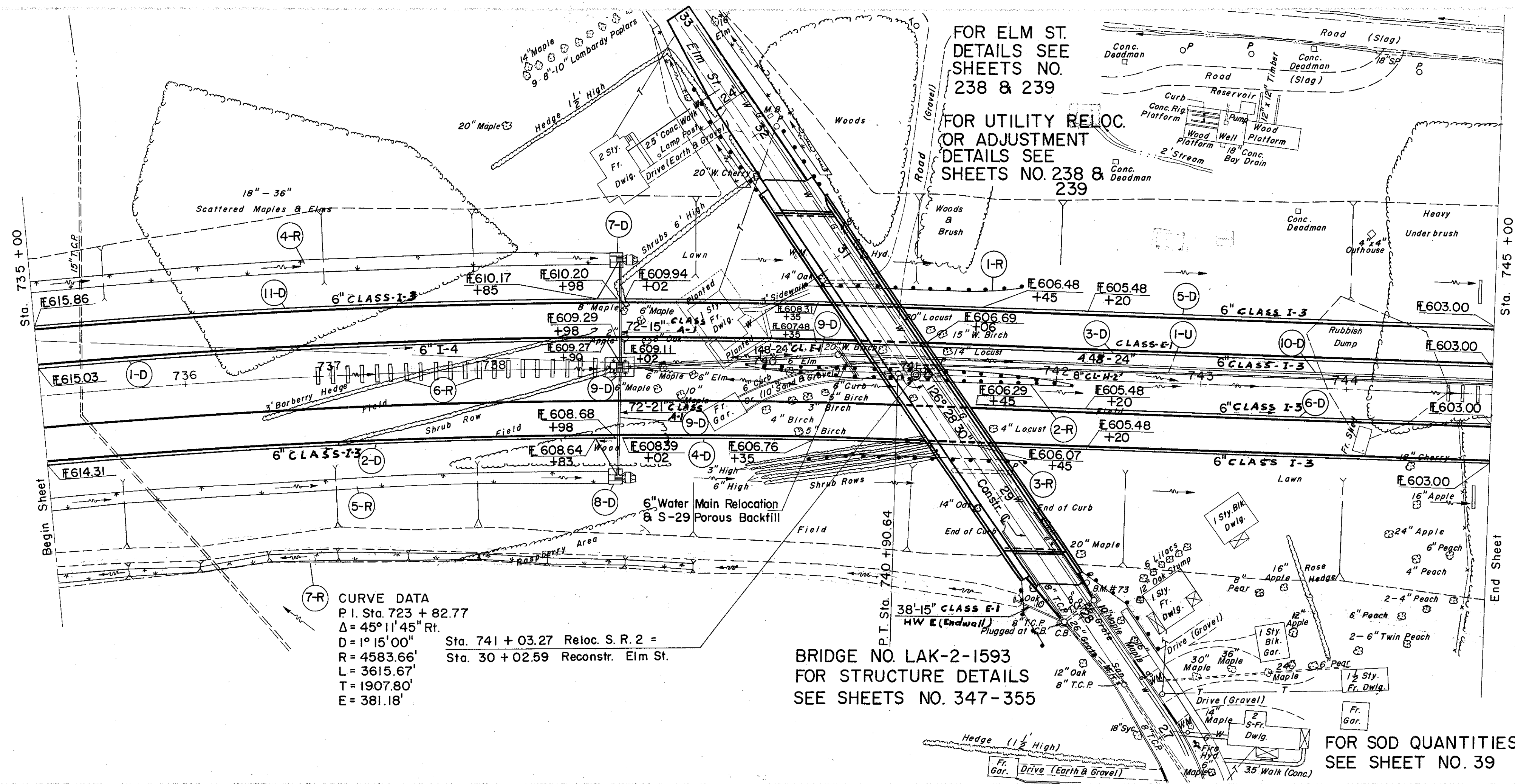

**CURVE DATA**  
P.I. Sta. 723 + 82.77  
Δ = 45° 11' 45" Rt.  
D = 1° 15' 00"  
R = 4583.66'  
L = 3615.67'  
T = 1907.80'  
E = 381.18'

Sta. 741 + 03.27 Reloc. S.R. 2 =  
Sta. 30 + 02.59 Reconstr. Elm St.

**BRIDGE NO. LAK-2-1593**  
FOR STRUCTURE DETAILS  
SEE SHEETS NO. 347-355

FOR SOD QUANTITIES  
SEE SHEET NO. 39

**(U) UTILITIES**

REF. NO.	STATION	SIDE	CLASS	PIPE	L.F.
I-1			8"	CLASS H-2	
I-1	740+62	745+00	LT.		438

**(D) DRAINAGE**

REF. NO.	STATION	SIDE	CLASS A-1		CLASS I-1		CLASS I-5		CLASS I-8		
			PIPE-M6L	PIPE	PIPE-M6L	PIPE	PIPE	STD. #4	STD. #1	STD. #5	
I-D	735+00	738+98	LT.								
2-D	735+00	738+98	RT.								
3-D	739+02	745+00	LT.								
4-D	739+02	745+00	RT.								
5-D	739+02	745+00	LT.								
6-D	741+45	745+00	RT.								
7-D	735+00	738+94	LT.								
8-D	735+00	738+91	RT.								
9-D	739+00	740+50	LT.	72	148	72					
10-D	740+50	745+00	LT.		448						
11-D	735+00	738+98	LT.			416	10	1	1	2	
TOTAL				72	596	72	3378	30	3	1	2

- 621.22
- 620.81
- 620.40
- 620.01
- 619.61
- 619.23
- 618.84
- 618.47
- 618.10
- 617.73
- 617.37
- 617.02
- 616.67
- 616.33
- 615.99
- 615.66
- 615.33
- 615.01
- 614.70
- 614.39
- 614.08
- 613.79
- 613.49
- 613.21
- 612.92
- 612.65
- 612.37
- 612.11
- 611.85
- 611.60
- 611.34
- 611.11
- 610.86
- 610.64
- 610.40
- 610.19
- 609.97
- 609.76
- 609.55
- 609.36
- 609.16

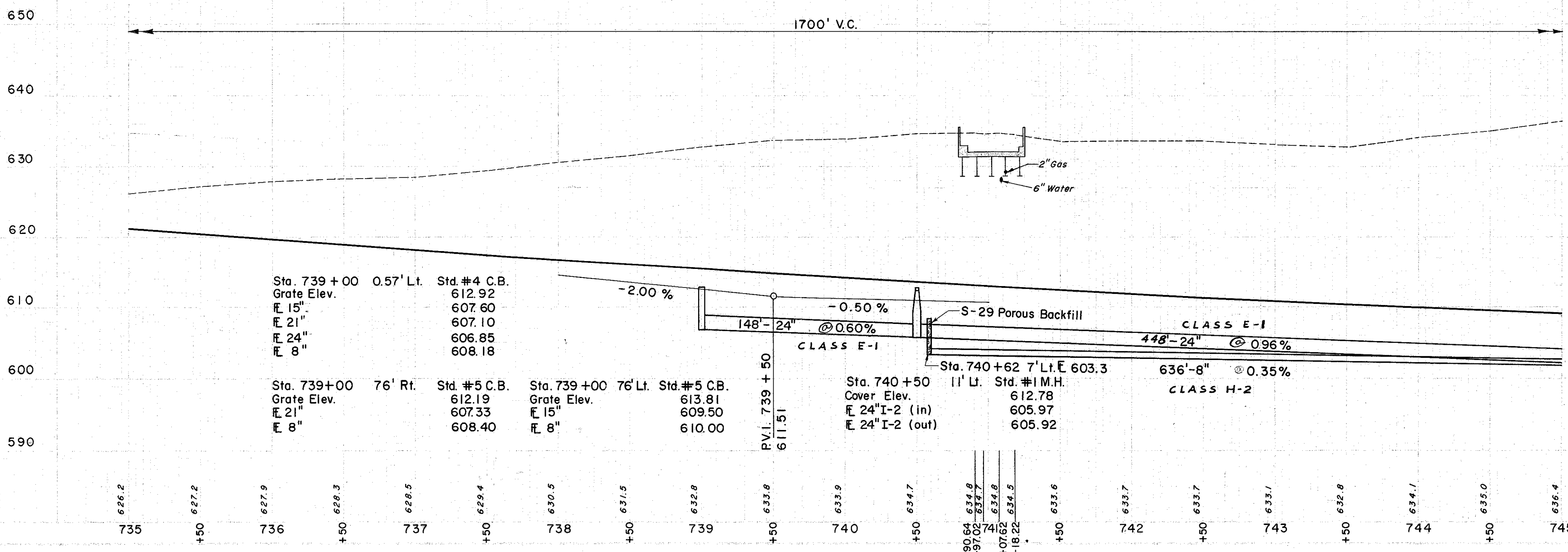

Sta. 739 + 00 0.57' Lt. Std. #4 C.B.  
Grate Elev. 612.92  
E 15" 607.60  
E 21" 607.10  
E 24" 606.85  
E 8" 608.18

Sta. 739 + 00 76' Rt. Std. #5 C.B.  
Grate Elev. 612.19  
E 15" 607.33  
E 8" 608.40

Sta. 739 + 00 76' Lt. Std. #5 C.B.  
Grate Elev. 613.81  
E 15" 609.50  
E 8" 610.00

Sta. 740 + 50 11' Lt. Std. #1 M.H.  
Cover Elev. 612.78  
E 24" I-2 (in) 605.97  
E 24" I-2 (out) 605.92

**(R) ROADWAY U-329(18) 100% State**

REF. NO.	STATION	SIDE	I-15 GUARD RAIL		I-15 STEEL BEAM STANDARD TYPE (DEEP)	
			L.F.	S.Y.	L.F.	S.Y.
1-R	740+26	741+75	150	62.5	87.5	
2-R	739+87	742+12	150	62.5	87.5	
3-R	740+30	741+82	150	62.5	87.5	
4-R	735+00	738+94		341		
5-R	735+00	738+91		372		
6-R	739+00			58		
7-R	735+00	745+00		234		
TOTAL			750	1,005	625	

SODDING RIGHT DITCH			SODDING LEFT DITCH			SODDING CHANNEL ON RIGHT					
STATION	WIDTH OF SODDING FT.	LENGTH OF SODDING FT.	S.Y.	STATION	WIDTH OF SODDING FT.	LENGTH OF SODDING FT.	S.Y.	STATION	WIDTH OF SODDING FT.	LENGTH OF SODDING FT.	S.Y.
735+00	7.9		45	735+00	7.0	398		735+00	5.6	50	31
735+50	8.2	50	45					735+50	5.6	50	29
738+91	9.5	333	327					736+00	4.7	340	174
SUB-TOTAL			372	SUB-TOTAL			341	SUB-TOTAL			234

139,155 C.Y.  
125 C.Y.  
150 C.Y.