

FOR DETAILS ON STATE ST.
SEE SHEET NO. 232

SECTION A-A THROUGH DUMPED ROCK
LT. STA. 716+50 & STA. 72+00
SEE SHEET NO. 30

Sta. 718+41.40 Reloc. S.R.2 -
Sta. 30+00.00 Reconstr. State St.

Remove Sewer Connections along
State St., Wheeling Ave. & Shelby Ave,
See Note.

FOR DETAILS ON WHEELING AVE. CONN.
SEE SHEET NO. 234

Place #2-A.C.B. into Existing 12" Pipe
103' Lt. of S.R.2 Sta. 723+45, pipe
upstream to be Removed.

LAKE COUNTY
LAK-2-14.22

MICROFILMED
JUL 8 1986

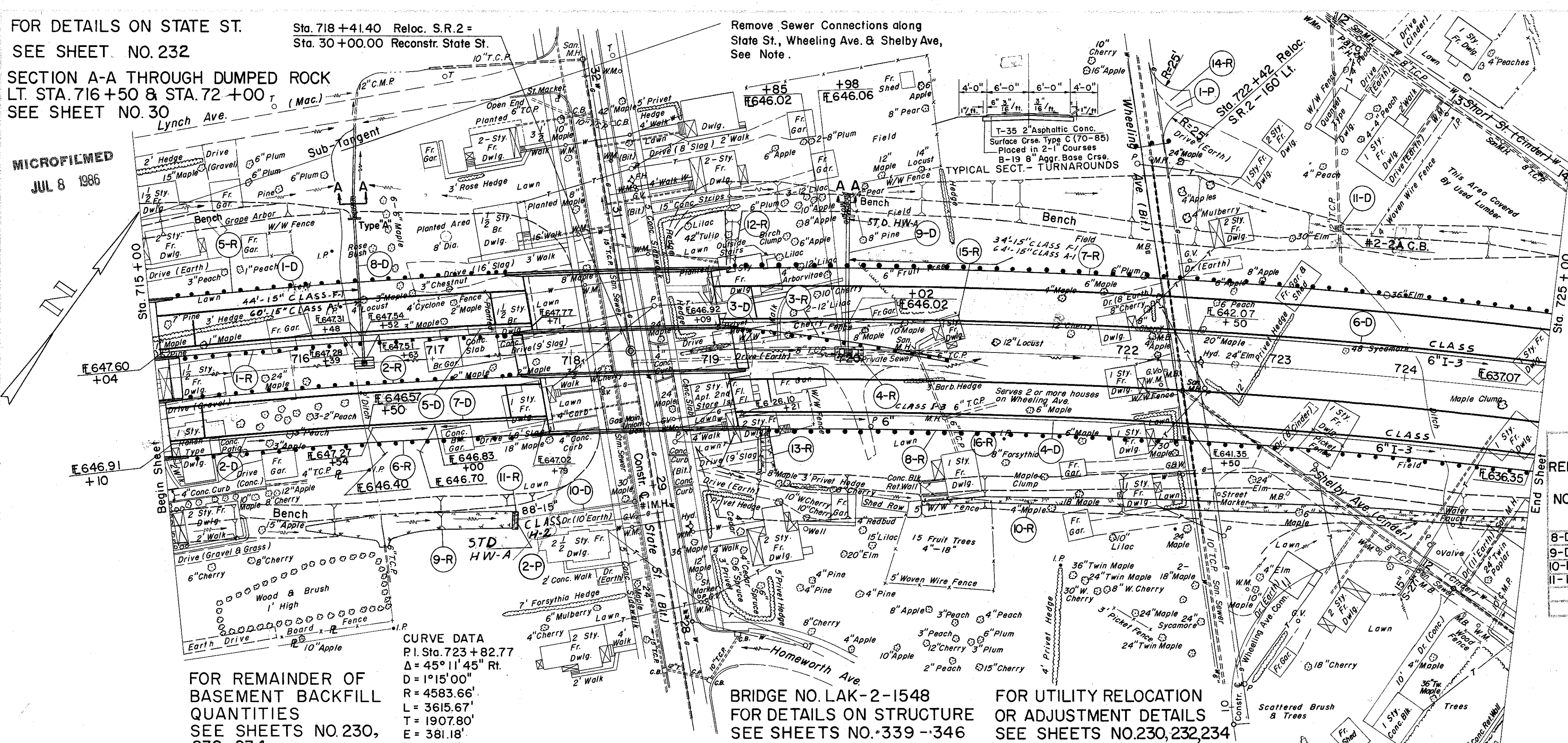

(D) DRAINAGE

REF NO.	STATION	SIDE	I-1		I-5	
			CLASS I-3 SHALLOW	8" PIPE	60° 60° WYE BEND	I-5
FROM	TO		L.F.	L.F.	EA.	EA.
1-D	715+04	LT.		150	10	1
2-D	715+10	RT.		148	10	1
3-D	719+09	LT.		96	10	1
4-D	719+21	RT.		573		
5-D	716+52	LT.		126	10	1
6-D	720+02	LT.		498		
7-D	716+54	RT.		132	10	1
TOTAL				1,723	50	4

(D) DRAINAGE

REF NO.	STATION	SIDE	I-1		I-5		I-8		I-10		I-2		E-12	
			CLASS A-1 15" PIPE	CLASS F-1 15" PIPE	BEND FOR CLASS F-1 PIPE	M-6.4(c) 15" PIPE	MOD. #5	STD. #2-#1	STD. #2 M.H. CHANNEL	DUMPED ROCK PROTECT.	MASONRY HEADWALLS	PIPE REMOVAL 15" & UNDER	L.F.	
FROM	TO		L.F.	L.F.	L.F.	EA.	EA.	EA.	EA.	C.Y.	C.Y.	C.Y.	L.F.	
8-D	716+50	C	60	44		2	1			2.9	3.2			
9-D	721+00	C	64	34		2	1			2.9	3.2			
10-D	717+50	RT.			88						3.2			
11-D	723+45	LT.											23	
TOTAL			124	78	88	4	2	1	1	5.8	9.6		23	

(R) ROADWAY

REF NO.	STATION	SIDE	E-1		E-4		I-15		L-10		L-10	
			COMP. SUB. GRADE	GRANULAR BORROW	GUARD RAIL STD. TYPE	GUARD RAIL STEEL BEAM	GUARD RAIL STEEL BEAM	GUARD RAIL STEEL BEAM	SODDING	SODDING		
FROM	TO		S.Y.	C.Y.	L.F.	L.F.	S.Y.	S.Y.				
1-R	715+17	LT.			250							
2-R	715+17	RT.			250							
3-R	719+19	LT.			112.5	37.5						
4-R	721+00	C							16			
5-R	715+17	LT.			237.5							
6-R	715+17	RT.			250							
7-R	719+13	LT.			58.75							
8-R	719+36	RT.			550							
9-R	716+00	RT.							234			
10-R	720+50	RT.							332			
11-R	717+50	RT.							2			
12-R	719+15	LT.								47.0		
13-R	719+38	RT.								32.8		
14-R	722+42	LT.	65									
15-R	720+75	LT.		65								
16-R	720+80	RT.		194								
TOTAL			65	259	2,237.5	37.5	584	79.8				

(P) PAVEMENT

REF NO.	STATION	SIDE	B-19		T-35		I-7	
			AGGR. BASE COURSE	ASPH. CONC. SURF. COURSE	REINF. CONC. APPR. SLAB T=13"	I-7		
FROM	TO		C.Y.	C.Y.	S.Y.	S.Y.		
1-P	722+42	LT.		15	4	267		
2-P	STRUCTURE					267		
TOTAL				15	4	267		

No Federal Participation

SODDING RIGHT DITCH

STATION	WIDTH OF SODDING FT.	LENGTH OF SODDING FT.	S.Y.
720+50	4.4	244	160
723+00	7.4	148	127
724+50	8.0	46	45
725+00	9.6		
SUB-TOTAL			332

SODDING RIGHT DITCH

STATION	WIDTH OF SODDING FT.	LENGTH OF SODDING FT.	S.Y.
716+00	3.6	50	59
716+50	17.5	100	175
717+50	14.0		
SUB-TOTAL			234

FOR REMAINDER OF BASEMENT BACKFILL QUANTITIES SEE SHEETS NO. 230, 232, 234

CURVE DATA
P.I. Sta. 723+82.77
Δ = 45° 11' 45" Rt.
D = 1915' 00"
R = 4583.66'
L = 3615.67'
T = 1907.80'
E = 381.18'

BRIDGE NO. LAK-2-1548
FOR DETAILS ON STRUCTURE SEE SHEETS NO. 339-346

FOR UTILITY RELOCATION OR ADJUSTMENT DETAILS SEE SHEETS NO. 230, 232, 234

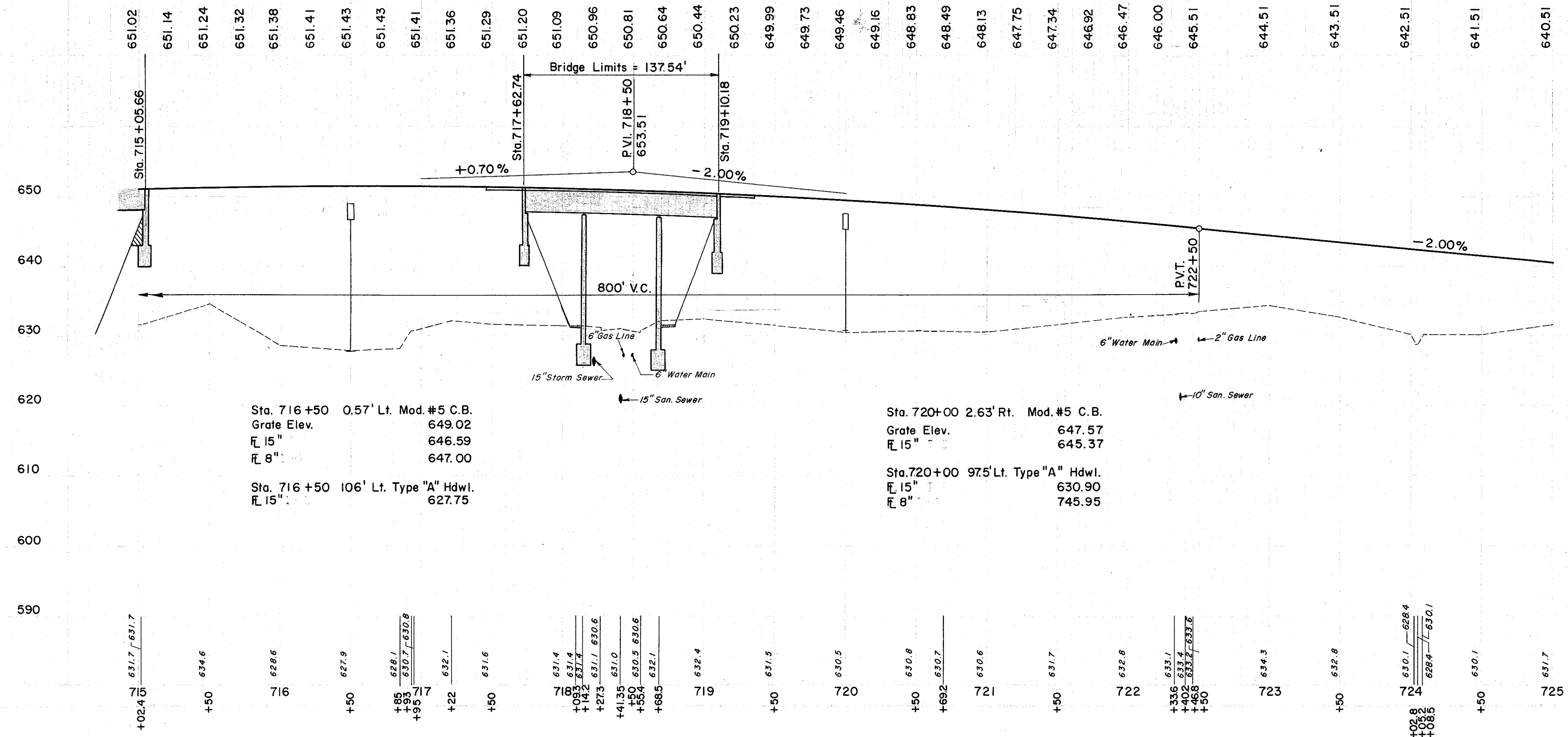

Sta. 716+50 0.57' Lt. Mod. #5 C.B.
Grate Elev. 649.02
15" 646.59
8" 647.00

Sta. 716+50 106' Lt. Type "A" Hdwl.
15" 627.75

Sta. 720+00 2.63' Rt. Mod. #5 C.B.
Grate Elev. 647.57
15" 645.37

Sta. 720+00 97.5' Lt. Type "A" Hdwl.
15" 630.90
8" 745.95

Rev. 7-6-61

STA. 715+00 TO STA. 725+00

1,519 C.Y.
81,365 C.Y.
20 97,638 C.Y.